

CASS COUNTY HIGHWAY DEPARTMENT
PLANS

FOR THE PROPOSED IMPROVEMENT OF VARIOUS
COUNTY HIGHWAYS
COUNTY HIGHWAY PROJECT NO. CH2508
BITUMINOUS PATCHING
VARIOUS LOCATIONS

GOVERNING SPECIFICATIONS	Date Published and Adopted by the North Dakota Department of Transportation
STANDARD SPECIFICATIONS	07/01/2024
SUPPLEMENTAL SPECIFICATIONS	NONE

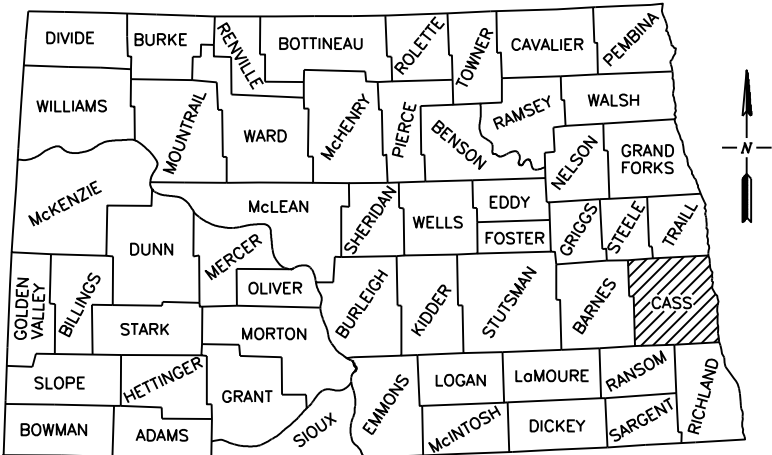

SKETCH MAP OF NORTH DAKOTA
SHOWING COUNTIES

COUNTY HWY 26 PATCHING SITE 12

COUNTY HWY 5 PATCHING SITE 11

COUNTY HWY 81 PATCHING SITES 1 - 3

COUNTY HWY 4 PATCHING SITES 4 - 8

COUNTY HWY 17 PATCHING SITE 9

COUNTY HWY 17 PATCHING SITE 10

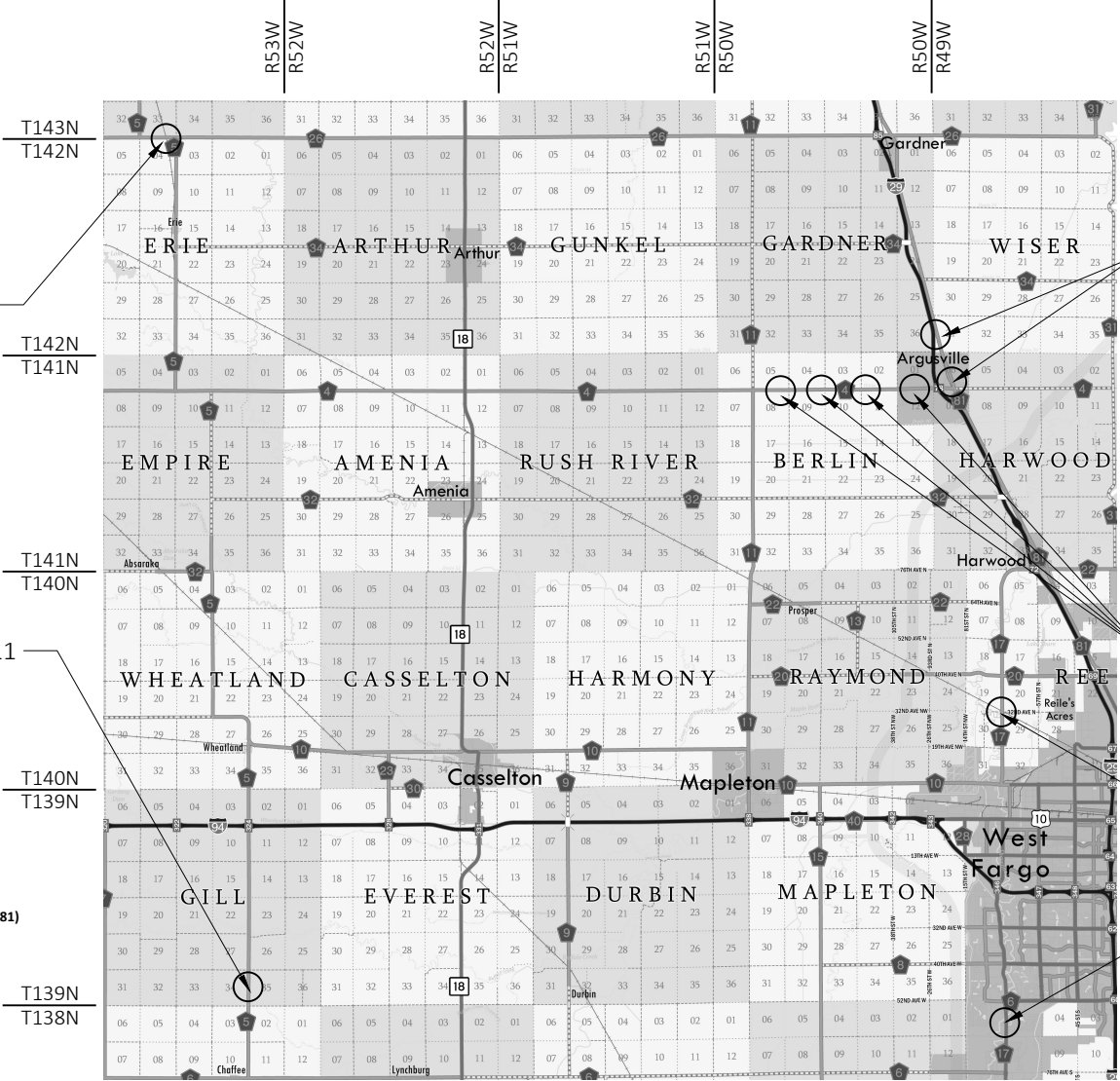
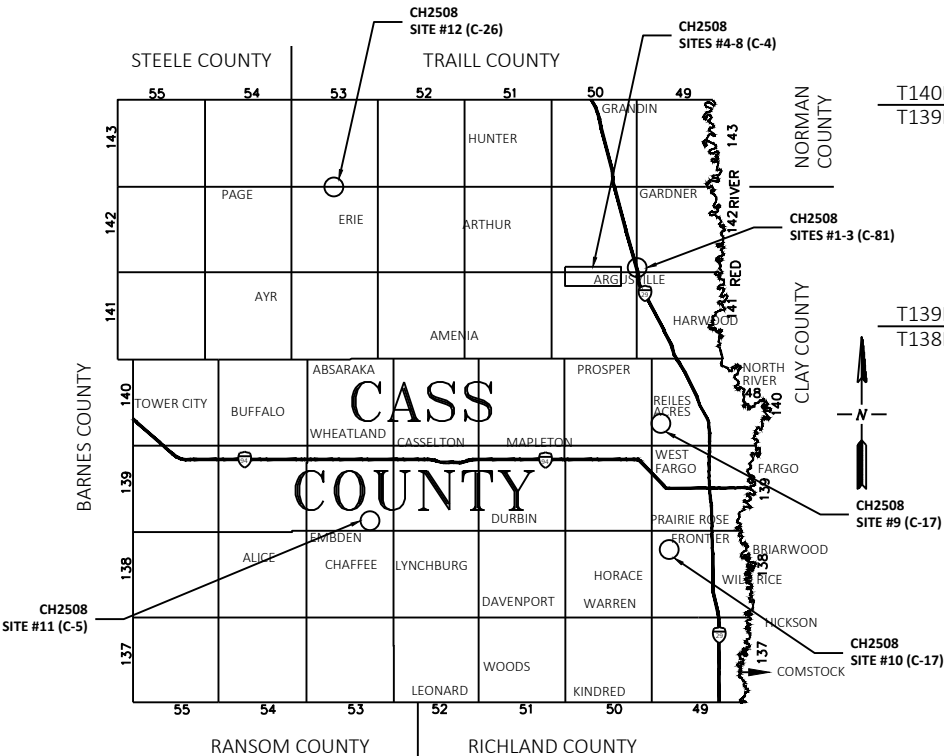

CASS COUNTY HIGHWAY DEPARTMENT
PROJECT NO. CH2508

I HEREBY CERTIFY THAT THIS PLAN WAS PREPARED BY ME OR UNDER MY DIRECT SUPERVISION.

KYLE D. LITCHY /S/
KYLE D. LITCHY N.D. REG. NO. 27408

DATE: 03/12/2025

THOMAS B. SOUCY /S/
THOMAS B. SOUCY N.D. REG. NO. 4038

DATE: 03/12/2025

CASS COUNTY HIGHWAY DEPARTMENT
WEST FARGO, NORTH DAKOTA

TITLE SHEET

CH2508

Drawn By ZSW
Checked By KDL
REV DATE 03/12/2025
Scale As Shown
SEC NO. 001
SHEET NO. 1

J:\Admin\Eng\Projects\Contract Bituminous Patching\2025\Design\CH2508 Plan Sheets.dwg:TABLE OF CONTENTS-3/11/2025 2:05 PM-(wainz)

PLAN SECTIONS		
SECTION	PAGES(S)	DESCRIPTION
001	1	TITLE SHEET
002	1	TABLE OF CONTENTS
004	1-5	SCOPE OF WORK
006	1	NOTES
008	1	QUANTITIES
010	1-2	BASIS OF ESTIMATE
020	1-2	GENERAL DETAILS
100	1-4	WORK ZONE TRAFFIC CONTROL

LIST OF STANDARD DRAWINGS	
SECTION	DESCRIPTION
D-704-09	CONSTRUCTION SIGN DETAILS - TERMINAL AND GUIDE SIGNS
D-704-10	CONSTRUCTION SIGN DETAILS - REGULATORY SIGNS
D-704-11	CONSTRUCTION SIGN DETAILS - WARNING SIGNS
D-704-11A	CONSTRUCTION SIGN DETAILS - WARNING SIGNS
D-704-13	BARRICADE AND CHANNELIZING DEVICE DETAILS
D-704-14	CONSTRUCTION SIGN PUNCHING AND MOUNTING DETAILS
D-704-15	ROAD CLOSURE LAYOUTS
D-704-19	ROAD CLOSURE AND LANE CLOSURE ON A TWO WAY ROAD LAYOUTS
D-704-26	MISCELLANEOUS SIGN LAYOUTS
D-704-31	CONSTRUCTION SIGN LAYOUT - NON-SIGNALIZED LOW VOLUME ONE LANE CLOSURE
D-704-34	SIGN LAYOUT FOR ONE LANE CLOSURE
D-704-50	PORTABLE SIGN SUPPORT ASSEMBLY
D-762-01	PAVEMENT MARKING MESSAGE DETAILS

APPENDICES	
NUMBER	DESCRIPTION
A	BF-20542827+Surface_Erie_ND_071061K_EXECUTED
B	BF-20548123+Surface_Fargo_ND_092950W_EXECUTED

THIS DOCUMENT WAS ORIGINALLY ISSUED AND SEALED BY KYLE LITCHY N.D.
REG. NO. 27408 ON 03/12/2025 AND THE ORIGINAL DOCUMENT IS STORED
AT THE CASS COUNTY HIGHWAY DEPARTMENT, WEST FARGO, ND

CASS COUNTY HIGHWAY DEPARTMENT
WEST FARGO, NORTH DAKOTA
CH2508
TABLE OF CONTENTS

Drawn By ZSW
Checked By KDL
REV DATE 03/12/2025
Scale As Shown
SEC NO. 002
SHEET NO. 1

J:\Admin-Eng\Projects\Contract Bituminous Patching\2025\Design\CH2508 Plan Sheets.dwg SCOPE OF WORK-3/11/2025 2:05 PM (wainz)



SCOPE OF WORK

NOT TO SCALE
COUNTY HIGHWAY 4 & COUNTY HIGHWAY 81
SITES # 1 - 8

THIS DOCUMENT WAS ORIGINALLY ISSUED AND SEALED BY KYLE LITCHY N.D.
REG. NO. 27408 ON 03/12/2025 AND THE ORIGINAL DOCUMENT IS STORED
AT THE CASS COUNTY HIGHWAY DEPARTMENT, WEST FARGO, ND

CASS COUNTY HIGHWAY DEPARTMENT
WEST FARGO, NORTH DAKOTA

CH2508

Drawn By
ZSW

Checked By
KDL

REV DATE
03/12/2025

Scale
As Shown

SEC NO.
004

SHEET NO.

1

SCOPE OF WORK

J:\Admin-Eng\Projects\Contract Bituminous Patching\2025\Design\CH2508 Plan Sheets.dwg-SCOPE OF WORK (2)-3/11/2025 2:05 PM-(wainz)

SCOPE OF WORK

NOT TO SCALE
COUNTY HIGHWAY 17
SITE # 9

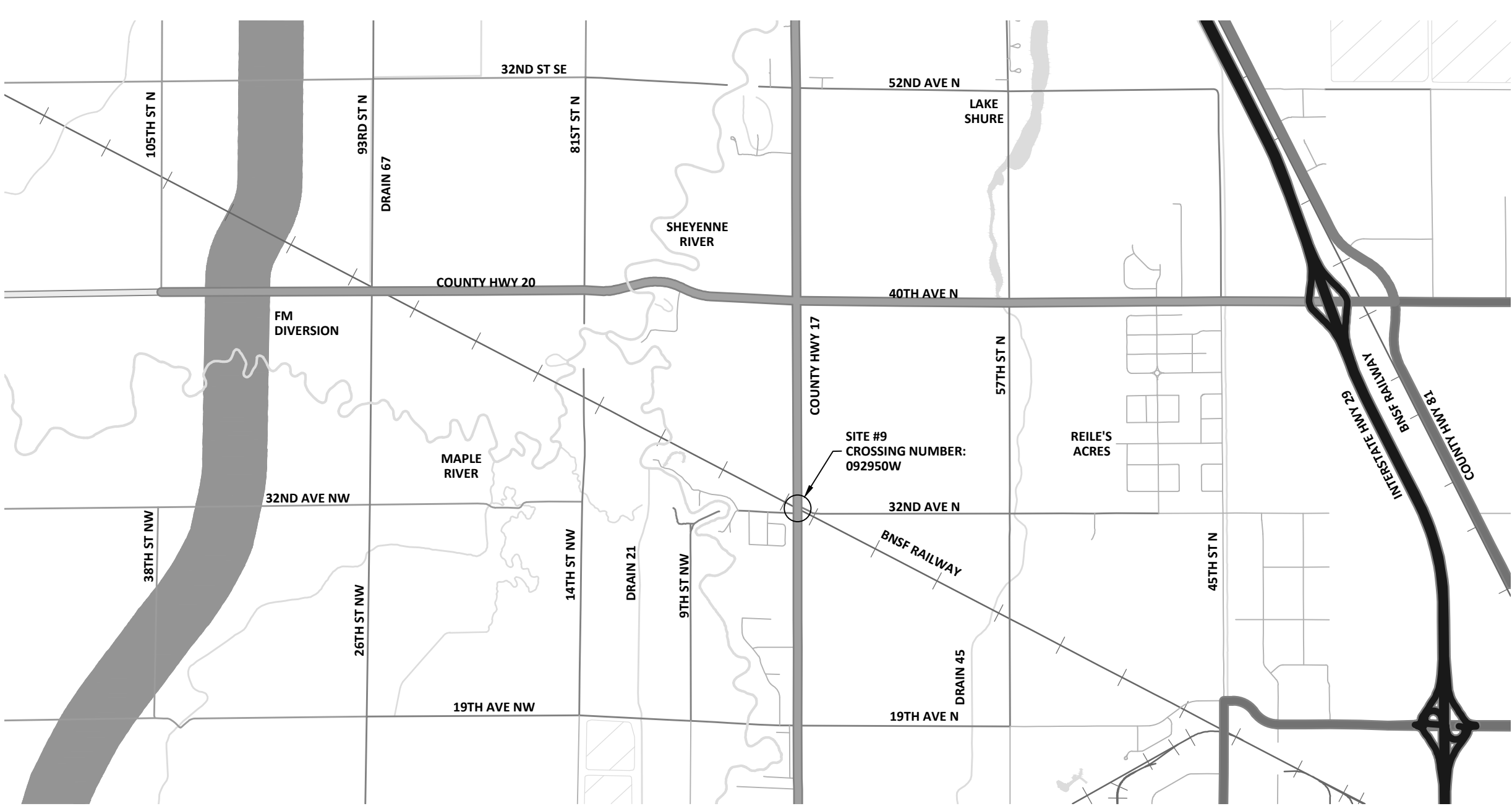

THIS DOCUMENT WAS ORIGINALLY ISSUED AND SEALED BY KYLE LITCHY N.D.
REG. NO. 27408 ON 03/12/2025 AND THE ORIGINAL DOCUMENT IS STORED
AT THE CASS COUNTY HIGHWAY DEPARTMENT, WEST FARGO, ND

CASS COUNTY HIGHWAY DEPARTMENT
WEST FARGO, NORTH DAKOTA

CH2508

Drawn By
ZSW

Checked By
KDL

REV DATE
03/12/2025

Scale
As Shown

SEC NO.
004

SHEET NO.
2

SCOPE OF WORK

J:\Admin-Eng\Projects\Contract Bituminous Patching\2025\Design\CH2508 Plan Sheets.dwg-SCOPE OF WORK (3)-3/11/2025 2:05 PM-(wainz)

SCOPE OF WORK

NOT TO SCALE
COUNTY HIGHWAY 17
SITE # 10

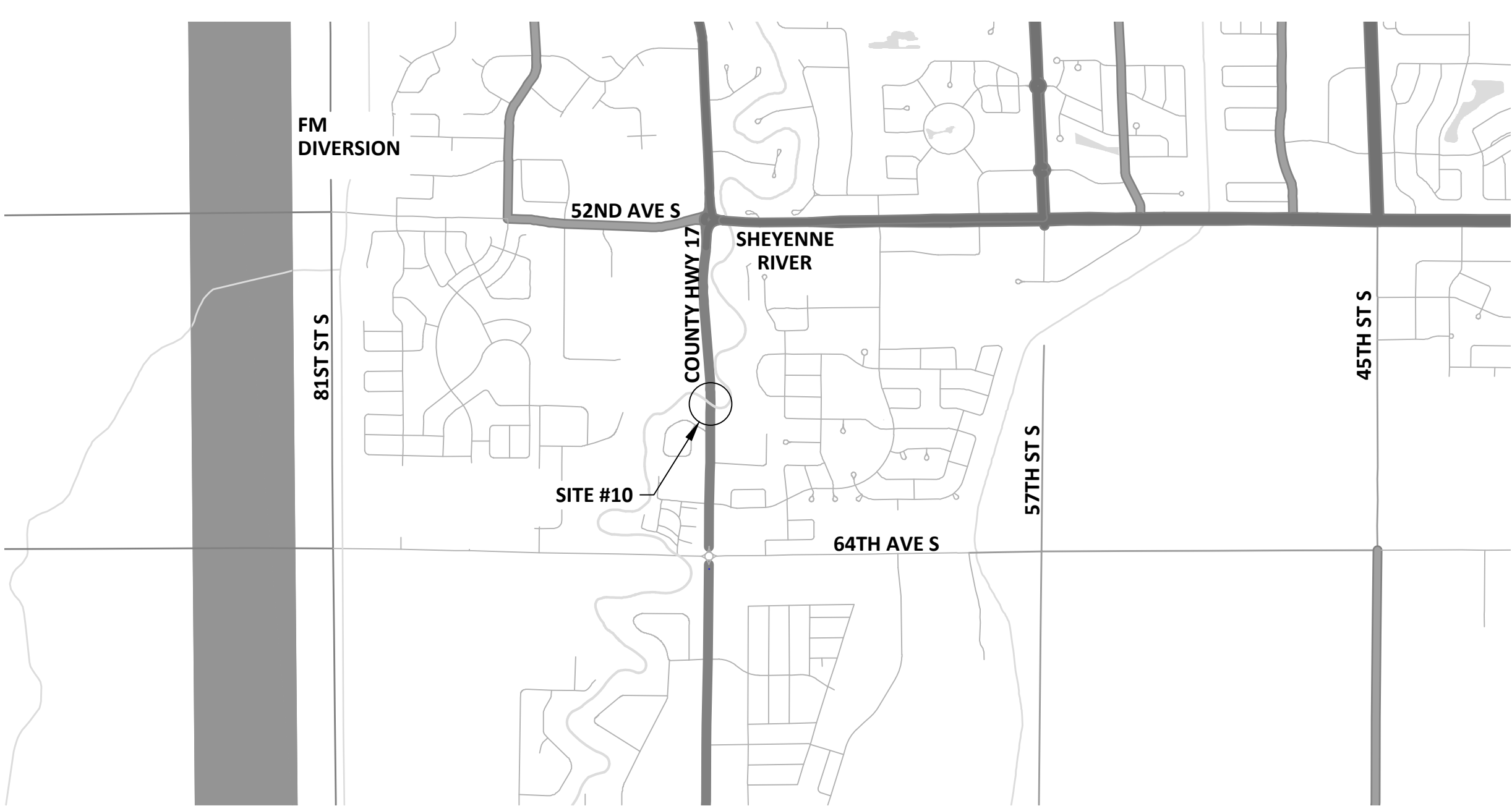

THIS DOCUMENT WAS ORIGINALLY ISSUED AND SEALED BY KYLE LITCHY N.D.
REG. NO. 27408 ON 03/12/2025 AND THE ORIGINAL DOCUMENT IS STORED
AT THE CASS COUNTY HIGHWAY DEPARTMENT, WEST FARGO, ND

CASS COUNTY HIGHWAY DEPARTMENT
WEST FARGO, NORTH DAKOTA

SCOPE OF WORK

CH2508

Drawn By
ZSW

Checked By
KDL

REV DATE
03/12/2025

Scale
As Shown

SEC NO.
004

SHEET NO.
3

J:\Admin-Eng\Projects\Contract Bituminous Patching\2025\Design\CH2508 Plan Sheets.dwg SCOPE OF WORK (4)-3/11/2025 2:05 PM-(wainz)

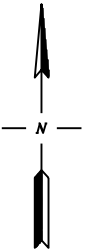

SCOPE OF WORK

NOT TO SCALE
COUNTY HIGHWAY 5
SITE # 11

THIS DOCUMENT WAS ORIGINALLY ISSUED AND SEALED BY KYLE LITCHY N.D.
REG. NO. 27408 ON 03/12/2025 AND THE ORIGINAL DOCUMENT IS STORED
AT THE CASS COUNTY HIGHWAY DEPARTMENT, WEST FARGO, ND

CASS COUNTY HIGHWAY DEPARTMENT
WEST FARGO, NORTH DAKOTA

SCOPE OF WORK

CH2508

Drawn By
ZSW

Checked By
KDL

REV DATE
03/12/2025

Scale
As Shown

SEC NO.
004

SHEET NO.
4

J:\Admin-Eng\Projects\Contract Bituminous Patching\2025\Design\CH2508 Plan Sheets.dwg-SCOPE OF WORK (5)-3/11/2025 2:05 PM-(wainz)

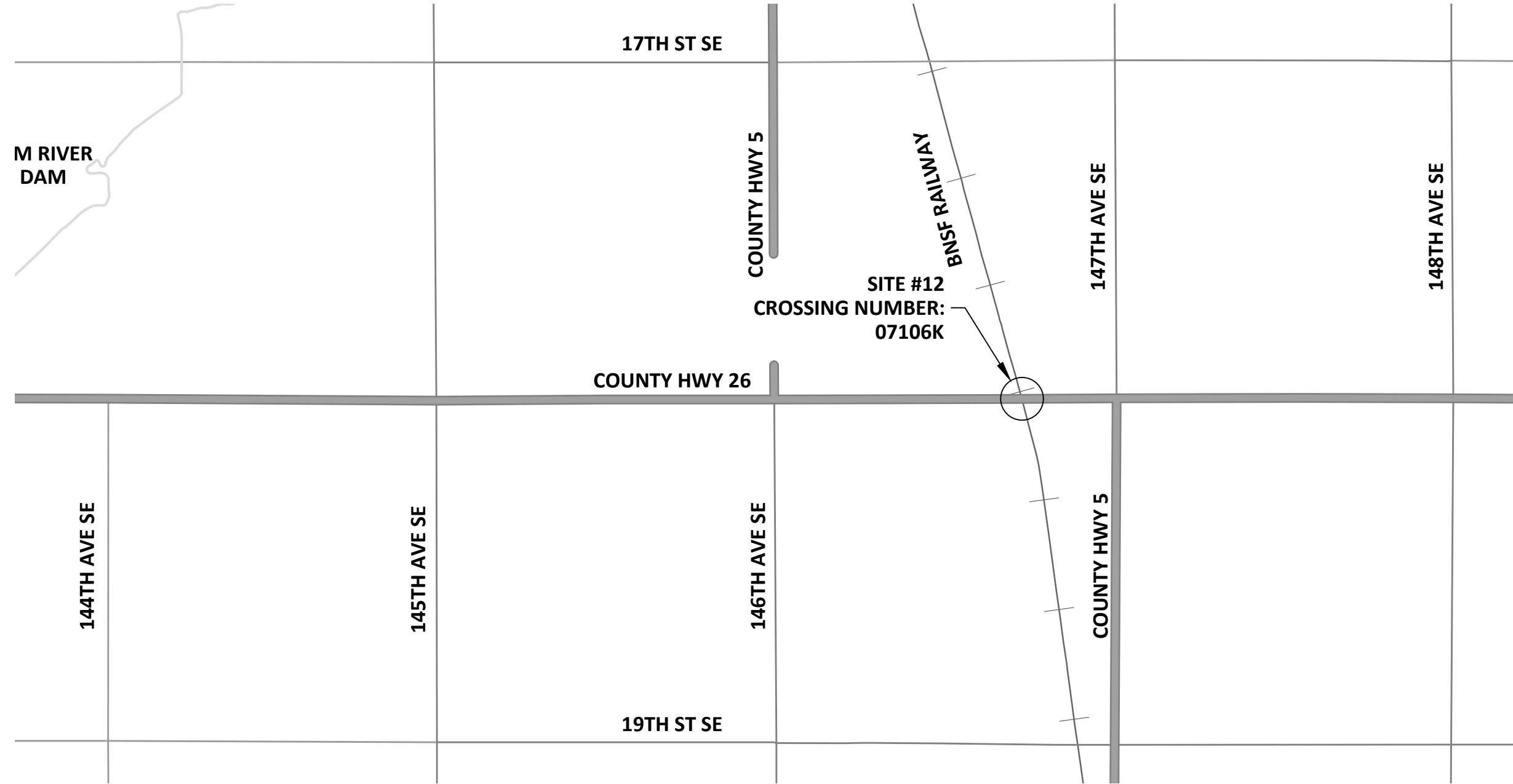

SCOPE OF WORK

NOT TO SCALE
COUNTY HIGHWAY 26
SITE # 12

THIS DOCUMENT WAS ORIGINALLY ISSUED AND SEALED BY KYLE LITCHY N.D.
REG. NO. 27408 ON 03/12/2025 AND THE ORIGINAL DOCUMENT IS STORED
AT THE CASS COUNTY HIGHWAY DEPARTMENT, WEST FARGO, ND

CASS COUNTY HIGHWAY DEPARTMENT
WEST FARGO, NORTH DAKOTA

CH2508

SCOPE OF WORK

Drawn By
ZSW

Checked By
KDL

REV DATE
03/12/2025

Scale
As Shown

SEC NO.
004

SHEET NO.
5

J:\Admin-Eng\Projects\Contract Bituminous Patching\2025\Design\CH2508 Plan Sheets.dwg-NOTES-3/11/2025 2:05 PM-(walnz)

100-P01 GENERAL PROVISIONS:

The cost of items on the plans, but not listed in the estimate of quantities, shall be included in the unit price for various items.

Thicknesses shown in the plans for surfacing are approximate. It is intended that the plan tonnages provided for by the basis of estimate shall be used uniformly throughout the project unless otherwise authorized by the Engineer.

The attention of the bidders is directed to M.S. 298.75 (Aggregate Material Tax), pursuant to the removal of aggregates from any deposit in Minnesota.

100-P02 PROJECT COMPLETION:

The completion date for the project is September 27th, 2025.

100-P03 COORDINATION OF PROJECTS:

Other projects in the vicinity of this project are under contract during the 2025 construction season. These projects are:

- Southwest Regional Pond Phase 2 FP-19-A4: Consists of Phase 2 of Lake Fargo project with the closure of 45th Street North of 76th Ave. This closure will make Cass Hwy 17 part of the detour route from 76th Ave South to 52nd Ave South. No work may proceed on Cass Hwy 17 until this detour is completed. Contact Rob Hasey from the City of Fargo (rhasey@fargond.gov) for coordination.
- Cass Hwy 26 Federal Aid Project SC-0950(063): Consists of Milling and HMA Overlay of Cass Hwy 26 from Cass Hwy 5 (North of Cass Hwy 26) to State Hwy 18. No work may proceed on Cass Hwy 26 BNSF RR Xing until this work is completed. Contact Central Specialties Project Manager Paul Nelson (218) 205-1663 for coordination.

107-P01 RAILROAD REQUIREMENTS:

Work on locations 9 & 12 will require a temporary occupancy permit from Burlington Northern Santa Fe Railway (BNSF). See attached (appendices A & B) agreements for required permitting, coordination & traffic control requirements. The permitting process may take up to 60 days and the Contractor will not be allowed to work in these areas prior to acquiring the permit. Include all costs associated with Railway requirements for permitting in the bid item "RAILWAY PROTECTION INSURANCE." Traffic control will be paid as a per site basis.

All costs associated with BNSF required traffic control, including erecting and maintaining traffic work zone signs throughout work zone, shall be included in the bid item "TRAFFIC CONTROL - RAILWAY."

107-P02 HAUL ROADS:

The Contractor's attention is directed to Section 107.08 of the Standard Specifications regarding the use of public roads for hauling materials to the project. It shall be the Contractor's responsibility to investigate the suitability of routes with the agency having control of the road prior to submitting a bid.

202-P01 REMOVAL OF BITUMINOUS SURFACING:

This item shall include all costs associated with the removal of bituminous surfacing at the specified locations to complete the bituminous paving as directed by the Engineer in the field. All asphalt material shall become property of the Contractor and hauled off site. This item will be measured on a per square yard basis per site. Dispose of asphalt material in accordance with Section 107.17 of the Standard Specifications. All costs associated with this shall be included in the bid item "REMOVAL OF BITUMINOUS SURFACING."

411-P01 MILLING PAVEMENT SURFACE:

This item shall include all costs associated with the milling at the specified locations to complete the bituminous paving as directed by the Engineer in the field. All millings shall become property of the

Contractor and hauled off site. This item will be measured on a per square yard basis per site. All costs associated with this shall be included in the bid item "MILLING PAVEMENT SURFACE."

430-P01 COMMERCIAL GRADE HOT MIX ASPHALT:

The HMA shall be placed and accepted according to Section 430 of the NDDOT Standard Specifications. The target mix is a **ND SUPERPAVE FAA 43 or greater**. The HMA mix may contain up to 20% recycled asphalt pavement (RAP). Tack oil at 0.01 gal/SY is required between the milled surface and the new mat and edges of the milled surfaces, 0.05 gal/SY is required between non-milled surface and new mat. All costs associated with tack oil to be included in the price bid for this item. Quantities listed are estimates and may vary by location. Total target thickness of the asphalt will also vary by location, see basis of estimate. Payment shall be actual tons used, with no change to item bid price per ton for over/under runs.

All costs associated with the application of Tack Coat, PG 58H-34 as well as placing Hot Mix Asphalt (HMA) at the specified locations, shall be included in the bid item "COMMERCIAL GRADE HOT MIX ASPHALT."

704-P01 TRAFFIC CONTROL:

Contractor shall provide traffic control for patching operations to be completed under traffic. Item may include flaggers and advanced warning signage for safe passage of traffic. Use portable sign supports in lieu of post mounted signs. This item shall only be for traffic control used on **Non-Railway locations**. Traffic control will be paid as a per site basis.

All costs associated with erecting and maintaining traffic work zone signs throughout work zone, shall be included in the bid item "TRAFFIC CONTROL."

704-P02 TRAFFIC CONTROL - RAILWAY:

Contractor shall provide traffic control for patching operations at railway crossing to be closed to traffic. Item shall follow the layout specified in the plans and may include flaggers. Use portable sign supports in lieu of post mounted signs. This item shall only be for traffic control used on **Railway locations**. Traffic control will be paid as a per site basis.

All costs associated with Type III Barricades to be incidental to bid item "TRAFFIC CONTROL - RAILWAY." All costs associated with erecting and maintaining traffic work zone signs throughout work zone, shall be included in the bid item "TRAFFIC CONTROL - RAILWAY."

704-P03 PORTABLE CHANGEABLE MESSAGE SIGN:

Bid item portable changeable message signs (PCMS) to be placed at locations specified in plans two weeks prior to the start of work at corresponding site, and are to be removed once work has started. The Engineer will determine the message to be displayed. This bid item will be paid for each individual sign place. All costs associated with this item shall be included in the price bid for "PORTABLE CHANGEABLE MESSAGE SIGN."

704-P04 MAINTAINING TRAFFIC:

The Contractor shall be responsible for providing continuous access to all residential dwellings and business establishments along and adjacent to specified locations. All costs associated with this work shall be incidental to price bid for "TRAFFIC CONTROL" and "TRAFFIC CONTROL - RAILWAY."

THIS DOCUMENT WAS ORIGINALLY ISSUED AND SEALED BY KYLE LITCHY N.D.
REG. NO. 27408 ON 03/12/2025 AND THE ORIGINAL DOCUMENT IS STORED
AT THE CASS COUNTY HIGHWAY DEPARTMENT, WEST FARGO, ND

CASS COUNTY HIGHWAY DEPARTMENT
WEST FARGO, NORTH DAKOTA

CH2508

Drawn By
ZSW

Checked By
KDL

REV DATE
03/12/2025

Scale
As Shown

SEC NO.
006

SHEET NO.
1

NOTES

J:\Admin-Eng\Projects\Contract Bituminous Patching\2025\Design\CH2508 Plan Sheets.dwg-Estimated QTY-3/11/2025 2:06 PM-(walnz)

ESTIMATED QUANTITIES				
ITEM	SPEC NO.	DECRPTION	UNIT	TOTAL
1	103	CONTRACT BOND	L SUM	1
2	107	RAILWAY PROTECTION INSURANCE	EA	2
3	202	REMOVAL OF BITUMINOUS SURFACING	SY	347
4	411	MILLING PAVEMENT SURFACE	SY	947
5	430	COMMERCIAL GRADE HOT MIX ASPHALT	TON	379
6	702	MOBILIZATION	L SUM	1
7	704	TRAFFIC CONTROL	EA	10
8	704	TRAFFIC CONTROL - RAILWAY	EA	2
9	704	PORTABLE CHANGEABLE MESSAGE SIGN	EA	6
10	762	PREFORMED PATTERNED PVMT MK 24IN LINE-GROOVED	LF	48

THIS DOCUMENT WAS ORIGINALLY ISSUED AND SEALED BY KYLE LITCHY N.D.
REG. NO. 27408 ON 03/12/2025 AND THE ORIGINAL DOCUMENT IS STORED
AT THE CASS COUNTY HIGHWAY DEPARTMENT, WEST FARGO, ND

CASS COUNTY HIGHWAY DEPARTMENT
WEST FARGO, NORTH DAKOTA
CH2508 QUANTITIES

Drawn By ZSW
Checked By KDL
REV DATE 03/12/2025
Scale As Shown
SEC NO. 008
SHEET NO. 1

J:\Admin-Eng\Projects\Contract Bituminous Patching\2025\Design\CH2508 Plan Sheets.dwg-Basis of Estimate-3/11/2025 2:06 PM (walnz)

<u>BASIS OF ESTIMATE</u>	
<u>MATERIAL</u>	<u>BASIS OF ESTIMATE</u>
HOT BITUMINOUS PAVEMENT	2.0 TON/CY
ADDED ASPHALT CEMENT (PG 58H-34)	5.0% OF HBP BY WEIGHT
EMULSIFIED ASPHALT FOR TACK COAT - NON MILLED SURFACE	0.05 GAL/SY
EMULSIFIED ASPHALT FOR TACK COAT - MILLED SURFACE	0.10 GAL/SY
<u>TRAFFIC CONTROL</u>	
FLAGGING	12 HOURS FLAGGING/FLAGGER/SITE/AS NEEDED
PILOT CAR	12 HOURS PILOT CAR/SITE/AS NEEDED

THIS DOCUMENT WAS ORIGINALLY ISSUED AND SEALED BY KYLE LITCHY N.D.
REG. NO. 27408 ON 03/12/2025 AND THE ORIGINAL DOCUMENT IS STORED
AT THE CASS COUNTY HIGHWAY DEPARTMENT, WEST FARGO, ND

CASS COUNTY HIGHWAY DEPARTMENT
WEST FARGO, NORTH DAKOTA
CH2508 BASIS OF ESTIMATE

Drawn By ZSW
Checked By KDL
REV DATE 03/12/2025
Scale As Shown
SEC NO. 010
SHEET NO. 1

J:\Admin\Eng\Projects\Contract Bituminous Patching\2025\Design\CH2508 Plan Sheets.dwg-Basis of Estimate (2)-3/11/2025 2:06 PM-(wainz)

PAVING TONNAGE ESTIMATED QUANTITIES						
LOCATION	SITE #	LENGTH (FT)	WIDTH (FT)	THICKNESS (IN)	AREA (SY)	TONS
C-81 1.81 MILES NORTH OF C-4 & C-81 INTERSECTION	1	120	24	1.5	320	27
C-81 1.77 MILES NORTH OF C-4 & C-81 INTERSECTION	2	60	22	1.5	147	12
C-81 0.22 MILES NORTH OF C-4 & C-81 INTERSECTION	3	40	24	1.5	107	9
C-4 PRIVATE DRIVE 0.13 MILES WEST OF 164TH AVE SE ON SOUTH SIDE OF C-4	4	VARIES	VARIES	3	35	6
C-4 PRIVATE DRIVE 0.13 MILES WEST OF 164TH AVE SE ON NORTH SIDE OF C-4	5	VARIES	VARIES	3	35	6
C-4 PRIVATE DRIVE 0.14 MILES WEST OF 165TH AVE SE ON NORTH SIDE OF C-4	6	VARIES	VARIES	3	30	5
C-4 PRIVATE DRIVE 0.29 MILES EAST OF 166TH AVE SE ON NORTH SIDE OF C-4	7	VARIES	VARIES	3	30	5
C-4 PRIVATE DRIVE 0.50 MILES WEST OF 168TH AVE SE ON SOUTH SIDE OF C-4	8	VARIES	VARIES	3	35	6
C-17 RAILROAD CROSSING 0.98 MILES SOUTH OF C-20 & C-17 INTERSECTION CROSSING NO. 092950W	9	40	VARIES	7	187	73
		20	VAIRES	1.5	96	8
C-17 SHEYENNE RIVER BOX CULVERT 0.45 MILES NORTH OF 64TH AVE S	10	80	40	3	356	59
C-5 2.30 MILES NORTH OF C-6	11	80	30	3	267	45
C-26 RAILROAD CROSSING 0.28 MILES WEST OF C-5 SOUTH CROSSING NO. 07106K	12	40	36	8.5	160	76
			2	8.5	9	4
		60	36	1.5	240	20
TOTAL =						361
5% OVERAGE =						18
GRAND TOTAL =						379

MILLING ESTIMATED QUANTITIES					
LOCATION	SITE #	LENGTH (FT)	WIDTH (FT)	DEPTH (IN)	AREA (SY)
C-81 1.81 MILES NORTH OF C-4 & C-81 INTERSECTION	1	120	24	1.5	320
C-81 0.22 MILES NORTH OF C-4 & C-81 INTERSECTION	3	40	24	1.5	107
C-4 PRIVATE DRIVE 0.13 MILES WEST OF 164TH AVE SE ON SOUTH SIDE OF C-4	4	95	3	1.5	32
C-4 PRIVATE DRIVE 0.13 MILES WEST OF 164TH AVE SE ON NORTH SIDE OF C-4	5	95	3	1.5	32
C-4 PRIVATE DRIVE 0.14 MILES WEST OF 165TH AVE SE ON NORTH SIDE OF C-4	6	65	3	1.5	22
C-4 PRIVATE DRIVE 0.29 MILES EAST OF 166TH AVE SE ON NORTH SIDE OF C-4	7	80	3	1.5	27
C-4 PRIVATE DRIVE 0.50 MILES WEST OF 168TH AVE SE ON SOUTH SIDE OF C-4	8	95	3	1.5	32
C-17 RAILROAD CROSSING 0.98 MILES SOUTH OF C-20 & C-17 INTERSECTION CROSSING NO. 092950W	9	20	VARIES	1.5	96
C-17 SHEYENNE RIVER BOX CULVERT 0.45 MILES NORTH OF 64TH AVE S	10	5	40	1.5	22
C-5 2.30 MILES NORTH OF C-6	11	5	30	1.5	17
C-26 RAILROAD CROSSING 0.28 MILES WEST OF C-5 SOUTH CROSSING NO. 07106K	12	60	36	1.5	240
GRAND TOTAL =					947

PAVEMENT MARKINGS ESTIMATED QUANTITIES							
LOCATION	SITE #	TYPE	DESCRIPTION	LANE	LENGTH (LF)		
C-17 RAILROAD CROSSING 0.98 MILES SOUTH OF C-20 & C-17 INTERSECTION CROSSING NO. 092950W	9	PREFORMED PATTERNED PVMT MK 24IN LINE-GROOVED	RR CROSSING STOP BAR	LT	12		
				RT	12		
C-26 RAILROAD CROSSING 0.28 MILES WEST OF C-5 SOUTH CROSSING NO. 07106K	12			LT	12		
				RT	12		
GRAND TOTAL =					48		

REMOVAL OF BITUMINOUS SURFACING ESTIMATED QUANTITIES					
LOCATION	SITE #	LENGTH (FT)	WIDTH (FT)	DEPTH (IN)	AREA (SY)
C-17 RAILROAD CROSSING 0.98 MILES SOUTH OF C-20 & C-17 INTERSECTION CROSSING NO. 092950W	9	40	VARIES	7	187
C-26 RAILROAD CROSSING 0.28 MILES WEST OF C-5 SOUTH CROSSING NO. 07106K	12	40	36	6	160
GRAND TOTAL =					347

THIS DOCUMENT WAS ORIGINALLY ISSUED AND SEALED BY KYLE LITCHY N.D.
REG. NO. 27408 ON 03/12/2025 AND THE ORIGINAL DOCUMENT IS STORED
AT THE CASS COUNTY HIGHWAY DEPARTMENT, WEST FARGO, ND

CASS COUNTY HIGHWAY DEPARTMENT
WEST FARGO, NORTH DAKOTA
CH2508
BASIS OF ESTIMATE

Drawn By
ZSW
Checked By
KDL
REV DATE
03/12/2025
Scale
As Shown
SEC NO.
010
SHEET NO.
2

J:\Admin-Eng\Projects\Contract Bituminous Patching\2025\Design\CH2508 Plan Sheets.dwg General Details-3/11/2025 2:06 PM-(wainz)

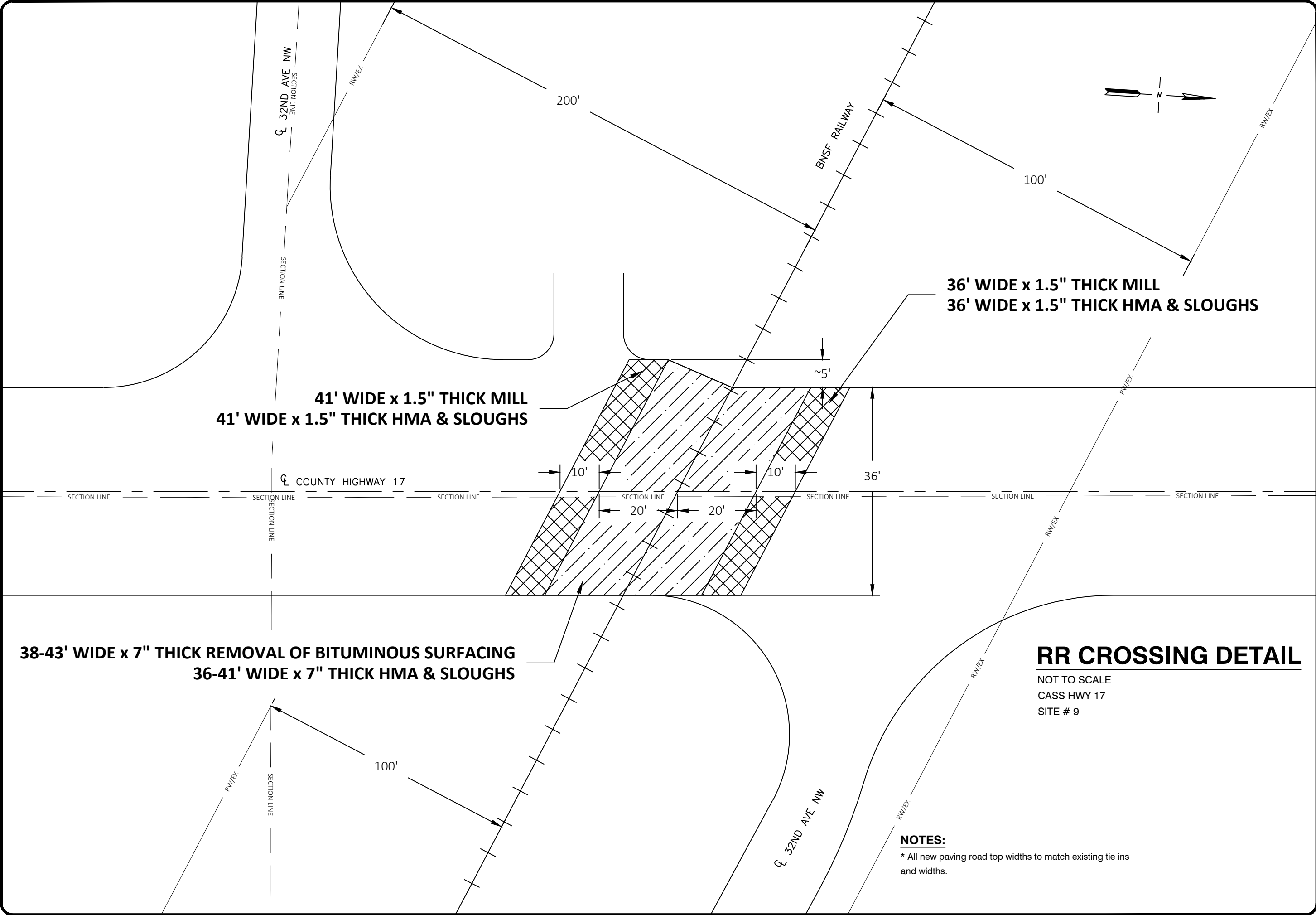

36' WIDE x 1.5" THICK MILL
36' WIDE x 1.5" THICK HMA & SLOUGHS

41' WIDE x 1.5" THICK MILL
41' WIDE x 1.5" THICK HMA & SLOUGHS

38-43' WIDE x 7" THICK REMOVAL OF BITUMINOUS SURFACING
36-41' WIDE x 7" THICK HMA & SLOUGHS

RR CROSSING DETAIL
NOT TO SCALE
CASS HWY 17
SITE # 9

NOTES:
* All new paving road top widths to match existing tie ins
and widths.

THIS DOCUMENT WAS ORIGINALLY ISSUED AND SEALED BY KYLE LITCHY N.D. REG. NO. 27408 ON 03/12/2025 AND THE ORIGINAL DOCUMENT IS STORED AT THE CASS COUNTY HIGHWAY DEPARTMENT, WEST FARGO, ND	
CASS COUNTY HIGHWAY DEPARTMENT WEST FARGO, NORTH DAKOTA	GENERAL DETAILS
CH2508	
Drawn By ZSW	
Checked By KDL	
REV DATE 03/12/2025	
Scale As Shown	
SEC NO. 020	
SHEET NO. 1	

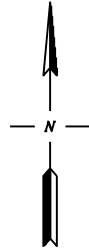

RW/EX

BNSF
RAILWAY

RW/EX

40' WIDE x 7" THICK REMOVAL OF BITUMINOUS SURFACING
36' WIDE x 8.5" THICK HMA & SLOUGHS

36' WIDE x 1.5" THICK MILL
36' WIDE x 1.5" THICK HMA & SLOUGHS

FEDERAL AID PROJECT LIMITS
SC-0950(063)

CL COUNTY HIGHWAY 26

30' 20' 20' 30'

36'

RW/EX

RW/EX

RW/EX

RW/EX

50'

50'

FEDERAL AID PROJECT LIMITS
SC-0950(063)

RR CROSSING DETAIL

NOT TO SCALE
CASS HWY 26
SITE # 12

NOTES:

* All new paving road top widths to match existing tie ins
and widths.

THIS DOCUMENT WAS ORIGINALLY ISSUED AND SEALED BY KYLE LITCHY N.D.
REG. NO. 27408 ON 03/12/2025 AND THE ORIGINAL DOCUMENT IS STORED
AT THE CASS COUNTY HIGHWAY DEPARTMENT, WEST FARGO, ND

CASS COUNTY HIGHWAY DEPARTMENT
WEST FARGO, NORTH DAKOTA

GENERAL DETAILS

CH2508

Drawn By
ZSW

Checked By
KDL

REV DATE
03/12/2025

Scale
As Shown

SEC NO.
020

SHEET NO.
2

J:\Admin-Eng\Projects\Contract Bituminous Patching\2025\Design\CH2508 Plan Sheets.dwg Sign List C:\7\3\11\2025 2:06 PM - (wainz)

SIGN NUMBER	SIGN SIZE	DESCRIPTION	AMOUNT REQUIRED	UNITS PER AMOUNT	UNITS SUB TOTAL
E5-1-48	48"x48"	EXIT GORE		35	
G20-1-60	60"x24"	ROAD WORK NEXT ___ MILES		28	
G20-1b-60	60"x24"	NO WORK IN PROGRESS (Sign and installation only)		18	
G20-2-48	48"x24"	END ROAD WORK		26	
G20-4-36	36"x18"	PILOT CAR FOLLOW ME (Mounted to back of pilot car)	1	18	18
G20-4b-36	36"x30"	WAIT FOR PILOT CAR		18	
G20-50a-72	72"x36"	ROAD WORK NEXT ___ MILES RT & LT ARROWS		43	
G20-52a-72	72"x24"	ROAD WORK NEXT ___ MILES RT or LT ARROW		36	
G20-55-96	96"x48"	SPEED LIMIT ENFORCED - MINIMUM FEE \$80 WHEN WORKERS PRESENT		59	
M1-1-36	36"x36"	INTERSTATE ROUTE MARKER (Post and installation only)		11	
M1-4-24	24"x24"	U.S. ROUTE MARKER (Post and installation only)		10	
M1-5-24	24"x24"	STATE ROUTE MARKER (Post and installation only)		10	
M3-1-24	24"x12"	NORTH (Mounted on route marker post)		7	
M3-2-24	24"x12"	EAST (Mounted on route marker post)		7	
M3-3-24	24"x12"	SOUTH (Mounted on route marker post)		7	
M3-4-24	24"x12"	WEST (Mounted on route marker post)		7	
M4-8-24	24"x12"	DETOUR (Mounted on route marker post)		7	
M4-9-30	30"x24"	DETOUR ARROW RIGHT or LEFT/AHD AND RT or LT		15	
M4-10-48	48"x18"	DETOUR (INSIDE ARROW) RIGHT or LEFT (Mounted on barricade)		7	
M5-1-21	21"x15"	ADVANCE TURN ARROW RT or LT(Mounted on route marker post)		7	
M5-1-30	30"x21"	ADVANCE TURN ARROW RT or LT(Mounted on route marker post)		9	
M6-1-21	21"x15"	DIRECTIONAL ARROW RT or LT (Mounted on route marker post)		7	
M6-1-30	30"x21"	DIRECTIONAL ARROW RT or LT (Mounted on route marker post)		9	
M6-3-21	21"x15"	DIRECTIONAL ARROW UP (Mounted on route marker post)		7	
R1-1-48	48"x48"	STOP		32	
R1-2-60	60"x60"	YIELD		29	
R2-1-36	36"x48"	SPEED LIMIT ___ (Portable only)		30	
R2-1-48	48"x60"	SPEED LIMIT ___		39	
R2-1aP-24	24"x18"	MINIMUM FEE \$80 (Mounted on Speed Limit post)		10	
R3-2-48	48"x48"	NO LEFT TURN		35	
R4-1-48	48"x60"	DO NOT PASS		39	
R4-7-48	48"x60"	KEEP RIGHT		39	
R5-1-48	48"x48"	DO NOT ENTER		35	
R6-1-54	54"x18"	ONE WAY RIGHT or LEFT (Mounted on STOP or DO NOT ENTER post)		14	
R7-1-12	12"x18"	NO PARKING ANY TIME		11	
R10-6-24	24"x36"	STOP HERE ON RED		16	
R11-2-48	48"x30"	ROAD CLOSED (Mounted on barricade)		12	
R11-2a-48	48"x30"	STREET CLOSED (Mounted on barricade)		12	
R11-3a-60	60"x30"	ROAD CLOSED ___ MILES AHEAD LOCAL TRAFFIC ONLY (Mtd on barricade)	1	15	15
R11-3c-60	60"x30"	STREET CLOSED ___ MILES AHEAD LOCAL TRAFFIC ONLY (Mtd on barricade)		15	
R11-4a-60	60"x30"	ROAD CLOSED TO THRU TRAFFIC (Mounted on barricade)	2	15	30
W1-3-48	48"x48"	REVERSE TURN RIGHT or LEFT		35	
W1-4-48	48"x48"	REVERSE CURVE RIGHT or LEFT		35	
W1-4b-48	48"x48"	TWO LANE REVERSE CURVE RIGHT or LEFT		35	
W1-6-48	48"x24"	ONE DIRECTION LARGE ARROW		26	
W3-1-48	48"x48"	STOP AHEAD		35	
W3-3-48	48"x48"	SIGNAL AHEAD		35	
W3-4-48	48"x48"	BE PREPARED TO STOP	2	35	70
W3-5-48	48"x48"	SPEED REDUCTION AHEAD		35	
W4-2-48	48"x48"	LANE ENDS RIGHT or LEFT		35	
W5-1-48	48"x48"	ROAD NARROWS		35	
W5-8-48	48"x48"	THRU TRAFFIC RIGHT LANE		35	
W5-9-48	48"x48"	ROAD WORK TRAFFIC ONLY DOWN & LT or RT ARROW		35	
W6-3-48	48"x48"	TWO WAY TRAFFIC		35	
W8-1-48	48"x48"	BUMP	2	35	70
W8-3-48	48"x48"	PAVEMENT ENDS	2	35	70
W8-7-48	48"x48"	LOOSE GRAVEL	2	35	70
W8-11-48	48"x48"	UNEVEN LANES	2	35	70
W8-12-48	48"x48"	NO CENTER LINE	2	35	70
W8-17-48	48"x48"	SHOULDER DROP-OFF SYMBOL		35	
W8-53-48	48"x48"	TRUCKS ENTERING HIGHWAY		35	
W8-54-48	48"x48"	TRUCKS ENTERING AHEAD or ___ FT or ___ MILE		35	
W8-55-48	48"x48"	TRUCKS CROSSING AHEAD or ___ FT or ___ MILE		35	
W8-56-48	48"x48"	TRUCKS EXITING HIGHWAY		35	

SIGN NUMBER	SIGN SIZE	DESCRIPTION	AMOUNT REQUIRED	UNITS PER AMOUNT	UNITS SUB TOTAL
W9-3a-48	48"x48"	CENTER LANE CLOSED SYMBOL		35	
W13-1P-30	30"x30"	___ MPH ADVISORY SPEED PLAQUE (Mounted on warning sign post)		14	
W14-3-64	64"x48"	NO PASSING ZONE		28	
W16-2P-30	30"x24"	___ FEET PLAQUE (Mounted on warning sign post)		10	
W20-1-48	48"x48"	ROAD WORK AHEAD or ___ FT or ___ MILE		35	
W20-2-48	48"x48"	DETOUR AHEAD or ___ FT or ___ MILE		35	
W20-3-48	48"x48"	ROAD or STREET CLOSED AHEAD or ___ FT or ___ MILE	9	35	315
W20-4-48	48"x48"	ONE LANE ROAD AHEAD or ___ FT or ___ MILE		35	
W20-5-48	48"x48"	RIGHT or CENTER or LEFT LANE CLOSED AHEAD or ___ FT or ___ MILE		35	
W20-7-48	48"x48"	FLAGGER	2	35	70
W20-8-18	18"x18"	STOP - SLOW PADDLE Back to Back	2	5	10
W20-52P-54	54"x12"	NEXT ___ MILES (Mounted on warning sign post)		12	
W21-1-48	48"x48"	WORKERS		35	
W21-2-48	48"x48"	FRESH OIL		35	
W21-3-48	48"x48"	ROAD MACHINERY AHEAD or ___ FT or ___ MILE		35	
W21-5-48	48"x48"	SHOULDER WORK		35	
W21-5a-48	48"x48"	RIGHT or LEFT SHOULDER CLOSED		35	
W21-5b-48	48"x48"	RIGHT or LEFT SHOULDER CLOSED AHEAD or ___ FT or ___ MILE		35	
W21-6-48	48"x48"	SURVEY CREW		35	
W21-50-48	48"x48"	BRIDGE PAINTING AHEAD or ___ FT		35	
W21-51-48	48"x48"	MATERIAL ON ROADWAY		35	
W21-52-48	48"x48"	PAVEMENT BREAKS		35	
W21-53-48	48"x48"	RUMBLE STRIPS AHEAD		35	
W22-8-48	48"x48"	FRESH OIL LOOSE ROCK		35	
W24-1-48	48"x48"	DOUBLE REVERSE CURVE		35	

SPECIAL SIGNS

SPEC & CODE

704-1000	TRAFFIC CONTROL SIGNS	TOTAL UNITS	878
----------	-----------------------	-------------	-----

SPEC & CODE	DESCRIPTION	UNIT	QUANTITY
704-0100	FLAGGING	MHR	
704-1048	PORTABLE RUMBLE STRIPS	EACH	
704-1049	TYPE I BARRICADES	EACH	
704-1050	TYPE III BARRICADES	EACH	7
704-1051	DELINEATOR DRUMS	EACH	
704-1052	TRAFFIC CONES	EACH	
704-1053	TUBULAR MARKERS	EACH	
704-1054	DELINEATOR	EACH	
704-1055	FLEXIBLE DELINEATORS	EACH	
704-1056	STACKABLE VERTICAL PANELS	EACH	
704-1057	VERTICAL PANELS - BACK TO BACK	EACH	
704-1058	SEQUENCING ARROW PANEL - TYPE A	EACH	
704-1059	SEQUENCING ARROW PANEL - TYPE B	EACH	
704-1060	SEQUENCING ARROW PANEL - TYPE C	EACH	
704-1061	OBLITERATION OF PVMT MK	SF	
704-1062	PORTABLE PRECAST CONCRETE MED BARRIER	LF	
704-1063	PRECAST CONCRETE MED BARRIER - STATE FURNISHED	EACH	
704-1064	RAISED PAVEMENT MARKERS	EACH	
704-1065	SHORT TERM 4IN LINE - TYPE R	LF	
704-1066	SHORT TERM 4IN LINE - TYPE NR	LF	

CONSTRUCTION SIGN LIST

CASS HWY 17

SITE #9



THIS DOCUMENT WAS ORIGINALLY ISSUED AND SEALED BY KYLE LITCHY N.D.
REG. NO. 27408 ON 03/12/2025 AND THE ORIGINAL DOCUMENT IS STORED
AT THE CASS COUNTY HIGHWAY DEPARTMENT, WEST FARGO, ND





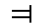

CASS COUNTY HIGHWAY DEPARTMENT
WEST FARGO, NORTH DAKOTA

CH2508 WORK ZONE TRAFFIC CONTROL

Drawn By ZSW
Checked By KDL
REV DATE 03/12/2025
Scale As Shown
SEC NO. 100
SHEET NO. 1

TRAFFIC CONTROL LEGEND

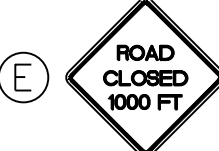
-  PORTABLE CHANGEABLE MESSAGE BOARD
-  SKID-MOUNTED SIGN
-  TYPE III BARRICADE

-  R11-3a-60
-  R11-4a-60
-  W20-3-48
-  W20-3-48
-  W20-3-48
-  W20-3-48

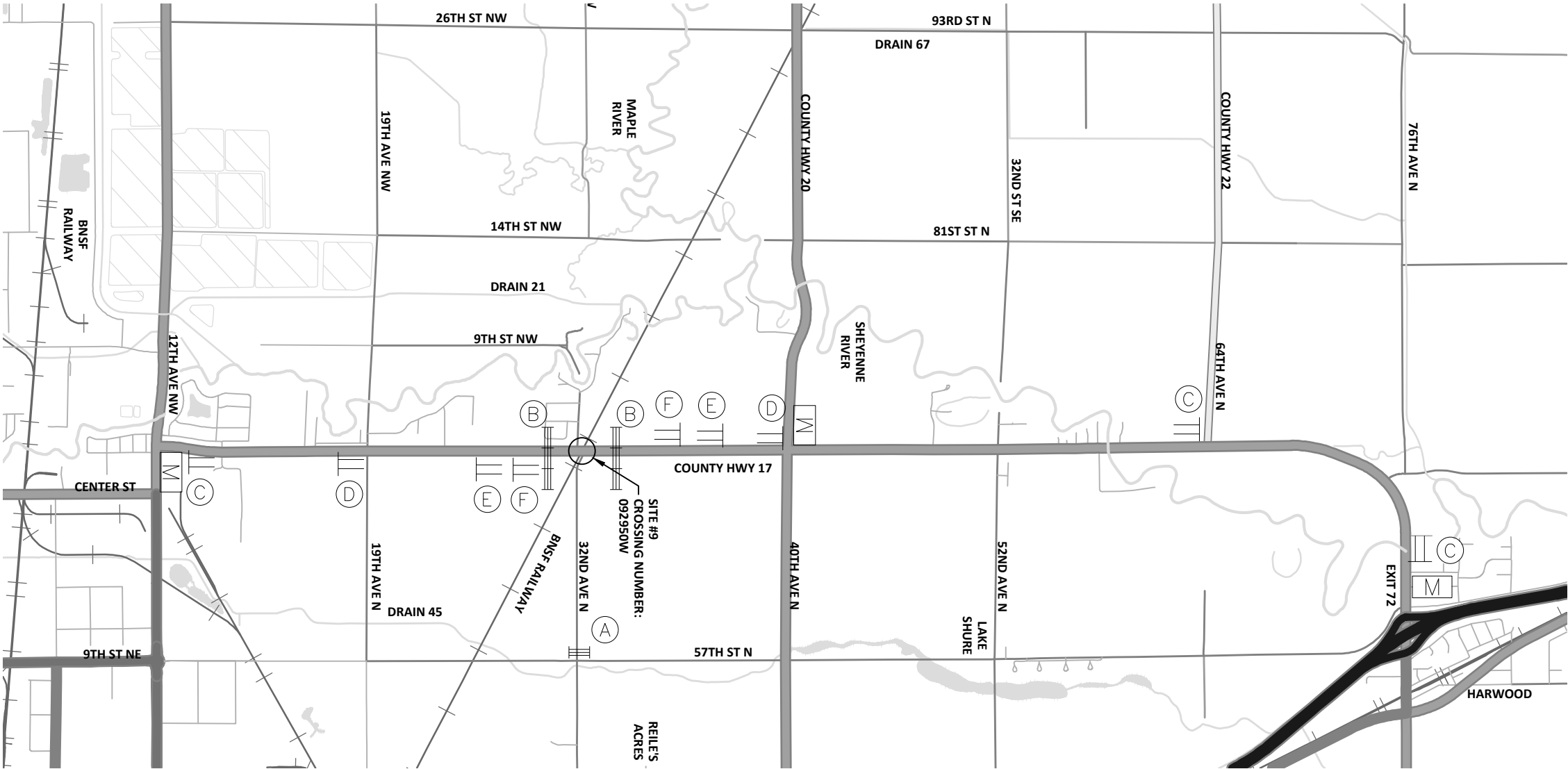

CONSTRUCTION SIGN LAYOUT

NOT TO SCALE
CASS HWY 17
SITE #9

THIS DOCUMENT WAS ORIGINALLY ISSUED AND SEALED BY KYLE LITCHY N.D.
REG. NO. 27408 ON 03/12/2025 AND THE ORIGINAL DOCUMENT IS STORED
AT THE CASS COUNTY HIGHWAY DEPARTMENT, WEST FARGO, ND

CASS COUNTY HIGHWAY DEPARTMENT
WEST FARGO, NORTH DAKOTA
CH2508 WORK ZONE TRAFFIC CONTROL

Drawn By	ZSW
Checked By	KDL
REV DATE	03/12/2025
Scale	As Shown
SEC NO.	100
SHEET NO.	2

J:\Admin-Eng\Projects\Contract Bituminous Patching\2025\Design\CH2508 Plan Sheets.dwg Sign List C-26-3/11/2025 2:06 PM - (wainz)

SIGN NUMBER	SIGN SIZE	DESCRIPTION	AMOUNT REQUIRED	UNITS PER AMOUNT	UNITS SUB TOTAL
E5-1-48	48"x48"	EXIT GORE		35	
G20-1-60	60"x24"	ROAD WORK NEXT ___ MILES		28	
G20-1b-60	60"x24"	NO WORK IN PROGRESS (Sign and installation only)		18	
G20-2-48	48"x24"	END ROAD WORK		26	
G20-4-36	36"x18"	PILOT CAR FOLLOW ME (Mounted to back of pilot car)		18	
G20-4b-36	36"x30"	WAIT FOR PILOT CAR		18	
G20-50a-72	72"x36"	ROAD WORK NEXT ___ MILES RT & LT ARROWS		43	
G20-52a-72	72"x24"	ROAD WORK NEXT ___ MILES RT or LT ARROW		36	
G20-55-96	96"x48"	SPEED LIMIT ENFORCED - MINIMUM FEE \$80 WHEN WORKERS PRESENT		59	
M1-1-36	36"x36"	INTERSTATE ROUTE MARKER (Post and installation only)		11	
M1-4-24	24"x24"	U.S. ROUTE MARKER (Post and installation only)		10	
M1-5-24	24"x24"	STATE ROUTE MARKER (Post and installation only)		10	
M3-1-24	24"x12"	NORTH (Mounted on route marker post)		7	
M3-2-24	24"x12"	EAST (Mounted on route marker post)		7	
M3-3-24	24"x12"	SOUTH (Mounted on route marker post)		7	
M3-4-24	24"x12"	WEST (Mounted on route marker post)		7	
M4-8-24	24"x12"	DETOUR (Mounted on route marker post)		7	
M4-9-30	30"x24"	DETOUR ARROW RIGHT or LEFT/AHD AND RT or LT		15	
M4-10-48	48"x18"	DETOUR (INSIDE ARROW) RIGHT or LEFT (Mounted on barricade)		7	
M5-1-21	21"x15"	ADVANCE TURN ARROW RT or LT(Mounted on route marker post)		7	
M5-1-30	30"x21"	ADVANCE TURN ARROW RT or LT(Mounted on route marker post)		9	
M6-1-21	21"x15"	DIRECTIONAL ARROW RT or LT (Mounted on route marker post)		7	
M6-1-30	30"x21"	DIRECTIONAL ARROW RT or LT (Mounted on route marker post)		9	
M6-3-21	21"x15"	DIRECTIONAL ARROW UP (Mounted on route marker post)		7	
R1-1-48	48"x48"	STOP		32	
R1-2-60	60"x60"	YIELD		29	
R2-1-36	36"x48"	SPEED LIMIT ___ (Portable only)		30	
R2-1-48	48"x60"	SPEED LIMIT ___		39	
R2-1aP-24	24"x18"	MINIMUM FEE \$80 (Mounted on Speed Limit post)		10	
R3-2-48	48"x48"	NO LEFT TURN		35	
R4-1-48	48"x60"	DO NOT PASS		39	
R4-7-48	48"x60"	KEEP RIGHT		39	
R5-1-48	48"x48"	DO NOT ENTER		35	
R6-1-54	54"x18"	ONE WAY RIGHT or LEFT (Mounted on STOP or DO NOT ENTER post)		14	
R7-1-12	12"x18"	NO PARKING ANY TIME		11	
R10-6-24	24"x36"	STOP HERE ON RED		16	
R11-2-48	48"x30"	ROAD CLOSED (Mounted on barricade)		12	
R11-2a-48	48"x30"	STREET CLOSED (Mounted on barricade)		12	
R11-3a-60	60"x30"	ROAD CLOSED ___ MILES AHEAD LOCAL TRAFFIC ONLY (Mtd on barricade)		15	
R11-3c-60	60"x30"	STREET CLOSED ___ MILES AHEAD LOCAL TRAFFIC ONLY (Mtd on barricade)		15	
R11-4a-60	60"x30"	ROAD CLOSED TO THRU TRAFFIC (Mounted on barricade)	2	15	30
W1-3-48	48"x48"	REVERSE TURN RIGHT or LEFT		35	
W1-4-48	48"x48"	REVERSE CURVE RIGHT or LEFT		35	
W1-4b-48	48"x48"	TWO LANE REVERSE CURVE RIGHT or LEFT		35	
W1-6-48	48"x24"	ONE DIRECTION LARGE ARROW		26	
W3-1-48	48"x48"	STOP AHEAD		35	
W3-3-48	48"x48"	SIGNAL AHEAD		35	
W3-4-48	48"x48"	BE PREPARED TO STOP	2	35	70
W3-5-48	48"x48"	SPEED REDUCTION AHEAD		35	
W4-2-48	48"x48"	LANE ENDS RIGHT or LEFT		35	
W5-1-48	48"x48"	ROAD NARROWS		35	
W5-8-48	48"x48"	THRU TRAFFIC RIGHT LANE		35	
W5-9-48	48"x48"	ROAD WORK TRAFFIC ONLY DOWN & LT or RT ARROW		35	
W6-3-48	48"x48"	TWO WAY TRAFFIC		35	
W8-1-48	48"x48"	BUMP	2	35	70
W8-3-48	48"x48"	PAVEMENT ENDS	2	35	70
W8-7-48	48"x48"	LOOSE GRAVEL	2	35	70
W8-11-48	48"x48"	UNEVEN LANES	2	35	70
W8-12-48	48"x48"	NO CENTER LINE	2	35	70
W8-17-48	48"x48"	SHOULDER DROP-OFF SYMBOL		35	
W8-53-48	48"x48"	TRUCKS ENTERING HIGHWAY		35	
W8-54-48	48"x48"	TRUCKS ENTERING AHEAD or ___ FT or ___ MILE		35	
W8-55-48	48"x48"	TRUCKS CROSSING AHEAD or ___ FT or ___ MILE		35	
W8-56-48	48"x48"	TRUCKS EXITING HIGHWAY		35	

SIGN NUMBER	SIGN SIZE	DESCRIPTION	AMOUNT REQUIRED	UNITS PER AMOUNT	UNITS SUB TOTAL
W9-3a-48	48"x48"	CENTER LANE CLOSED SYMBOL		35	
W13-1P-30	30"x30"	___ MPH ADVISORY SPEED PLAQUE (Mounted on warning sign post)		14	
W14-3-64	64"x48"	NO PASSING ZONE		28	
W16-2P-30	30"x24"	___ FEET PLAQUE (Mounted on warning sign post)		10	
W20-1-48	48"x48"	ROAD WORK AHEAD or ___ FT or ___ MILE		35	
W20-2-48	48"x48"	DETOUR AHEAD or ___ FT or ___ MILE		35	
W20-3-48	48"x48"	ROAD or STREET CLOSED AHEAD or ___ FT or ___ MILE	9	35	315
W20-4-48	48"x48"	ONE LANE ROAD AHEAD or ___ FT or ___ MILE		35	
W20-5-48	48"x48"	RIGHT or CENTER or LEFT LANE CLOSED AHEAD or ___ FT or ___ MILE		35	
W20-7-48	48"x48"	FLAGGER		35	
W20-8-18	18"x18"	STOP - SLOW PADDLE Back to Back		5	
W20-52P-54	54"x12"	NEXT ___ MILES (Mounted on warning sign post)		12	
W21-1-48	48"x48"	WORKERS		35	
W21-2-48	48"x48"	FRESH OIL		35	
W21-3-48	48"x48"	ROAD MACHINERY AHEAD or ___ FT or ___ MILE		35	
W21-5-48	48"x48"	SHOULDER WORK		35	
W21-5a-48	48"x48"	RIGHT or LEFT SHOULDER CLOSED		35	
W21-5b-48	48"x48"	RIGHT or LEFT SHOULDER CLOSED AHEAD or ___ FT or ___ MILE		35	
W21-6-48	48"x48"	SURVEY CREW		35	
W21-50-48	48"x48"	BRIDGE PAINTING AHEAD or ___ FT		35	
W21-51-48	48"x48"	MATERIAL ON ROADWAY		35	
W21-52-48	48"x48"	PAVEMENT BREAKS		35	
W21-53-48	48"x48"	RUMBLE STRIPS AHEAD		35	
W22-8-48	48"x48"	FRESH OIL LOOSE ROCK		35	
W24-1-48	48"x48"	DOUBLE REVERSE CURVE		35	

SPECIAL SIGNS

SPEC & CODE

704-1000	TRAFFIC CONTROL SIGNS	TOTAL UNITS	765
----------	-----------------------	-------------	-----

SPEC & CODE	DESCRIPTION	UNIT	QUANTITY
704-0100	FLAGGING	MHR	
704-1048	PORTABLE RUMBLE STRIPS	EACH	
704-1049	TYPE I BARRICADES	EACH	
704-1050	TYPE III BARRICADES	EACH	6
704-1051	DELINEATOR DRUMS	EACH	
704-1052	TRAFFIC CONES	EACH	
704-1053	TUBULAR MARKERS	EACH	
704-1054	DELINEATOR	EACH	
704-1055	FLEXIBLE DELINEATORS	EACH	
704-1056	STACKABLE VERTICAL PANELS	EACH	
704-1057	VERTICAL PANELS - BACK TO BACK	EACH	
704-1058	SEQUENCING ARROW PANEL - TYPE A	EACH	
704-1059	SEQUENCING ARROW PANEL - TYPE B	EACH	
704-1060	SEQUENCING ARROW PANEL - TYPE C	EACH	
704-1061	OBLITERATION OF PVMT MK	SF	
704-1062	PORTABLE PRECAST CONCRETE MED BARRIER	LF	
704-1063	PRECAST CONCRETE MED BARRIER - STATE FURNISHED	EACH	
704-1064	RAISED PAVEMENT MARKERS	EACH	
704-1065	SHORT TERM 4IN LINE - TYPE R	LF	
704-1066	SHORT TERM 4IN LINE - TYPE NR	LF	

CONSTRUCTION SIGN LIST

CASS HWY 26

SITE #12

THIS DOCUMENT WAS ORIGINALLY ISSUED AND SEALED BY KYLE LITCHY N.D.
REG. NO. 27408 ON 03/12/2025 AND THE ORIGINAL DOCUMENT IS STORED
AT THE CASS COUNTY HIGHWAY DEPARTMENT, WEST FARGO, ND



CASS COUNTY HIGHWAY DEPARTMENT
WEST FARGO, NORTH DAKOTA

CH2508 WORK ZONE TRAFFIC CONTROL

Drawn By ZSW
Checked By KDL
REV DATE 03/12/2025
Scale As Shown
SEC NO. 100
SHEET NO. 3

J:\Admin\Eng\Projects\Contract Bituminous Patching\2025\Design\CH2508 Plan Sheets.dwg C-26 Traffic Control-3/11/2025 2:06 PM (walnz)

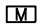
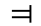
TRAFFIC CONTROL LEGEND

-  PORTABLE CHANGEABLE MESSAGE BOARD
-  SKID-MOUNTED SIGN
-  TYPE III BARRICADE

- (A)



R11-4a-60
- (B)



W20-3-48
- (C)

W20-3-48
- (D)

W20-3-48
- (E)

W20-3-48
- (F)

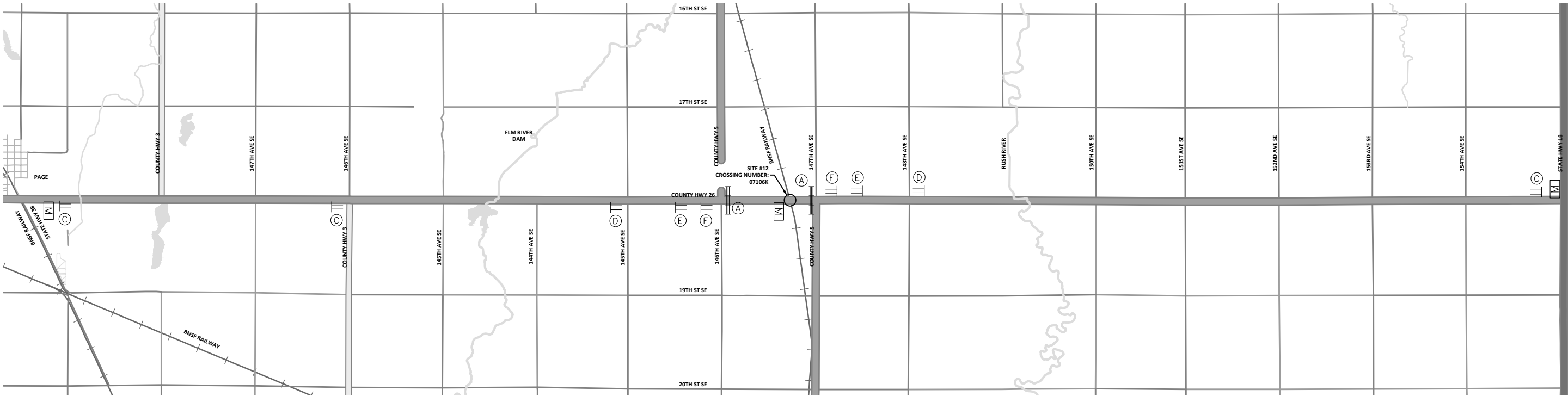
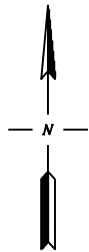
W20-3-48



CONSTRUCTION SIGN LAYOUT

NOT TO SCALE
CASS HWY 26
SITE #12

THIS DOCUMENT WAS ORIGINALLY ISSUED AND SEALED BY KYLE LITCHY N.D.
REG. NO. 27408 ON 03/12/2025 AND THE ORIGINAL DOCUMENT IS STORED
AT THE CASS COUNTY HIGHWAY DEPARTMENT, WEST FARGO, ND

CASS COUNTY HIGHWAY DEPARTMENT
WEST FARGO, NORTH DAKOTA

CH2508 WORK ZONE TRAFFIC CONTROL

Drawn By	ZSW
Checked By	KDL
REV DATE	03/12/2025
Scale	As Shown
SEC NO.	100
SHEET NO.	4