



TODD COUNTY PUBLIC WORKS
44 RIVERSIDE DRIVE
LONG PRAIRIE, MN 56347

HIGHWAY CONSTRUCTION PROPOSAL

FOR HIGHWAY CONSTRUCTION WITH BIDS RECEIVED UNTIL 10:00 AM ON MARCH 11th, 2025

PROPOSAL OF

(NAME OF FIRM)

(MAILING ADDRESS)

(AREA CODE) TELEPHONE NUMBER

E-MAIL ADDRESS

TO FURNISH AND DELIVER ALL MATERIALS AND TO PERFORM ALL WORK IN ACCORDANCE WITH THE CONTRACT, THE PLANS AND THE APPROVED DEPARTMENT OF TRANSPORTATION "STANDARD SPECIFICATIONS FOR CONSTRUCTION" 2020 EDITION, EXCEPT AS STATED OTHERWISE IN THE SPECIAL PROVISIONS WHICH ARE PART OF THIS PROPOSAL, FOR:

COUNTY PROJECT #: CP 25:71
LOCATION: COUNTY ROAD 71
LENGTH: 3.002 MILES
TYPE OF WORK: GRAVEL SURFACING

COUNTY PROJECT #: CP 25:85
LOCATION: COUNTY ROAD 85
LENGTH: 4.777 MILES
TYPE OF WORK: GRAVEL SURFACING

COUNTY PROJECT #: CP 25:86
LOCATION: COUNTY ROAD 86
LENGTH: 5.139 MILES
TYPE OF WORK: GRAVEL SURFACING

STARTING DATE: On August 4th, 2025

PROJECT ACCEPTANCE: On or before October 10th, 2025

NOTICE TO BIDDERS: In submitting a bid, you must return this complete proposal. You must initial changes made in the Schedule of Prices in the Proposal and acknowledge addenda on the back cover sheet.

I certify that this Proposal was prepared by me or under my direct supervision, and that I am a licensed professional engineer under the laws of the State of Minnesota.

Eric Zell
Todd County Public Works Director -- PE License #43144

01-30-2025

Date

BID RIGGING IS A SERIOUS CRIME. IF YOU HAVE ANY INFORMATION CONCERNING COLLUSIVE BIDDING, EVEN A REQUEST TO SUBMIT A COMPLIMENTARY BID, PLEASE CALL THE MINNESOTA ATTORNEY GENERAL'S OFFICE AT 651-296-1796

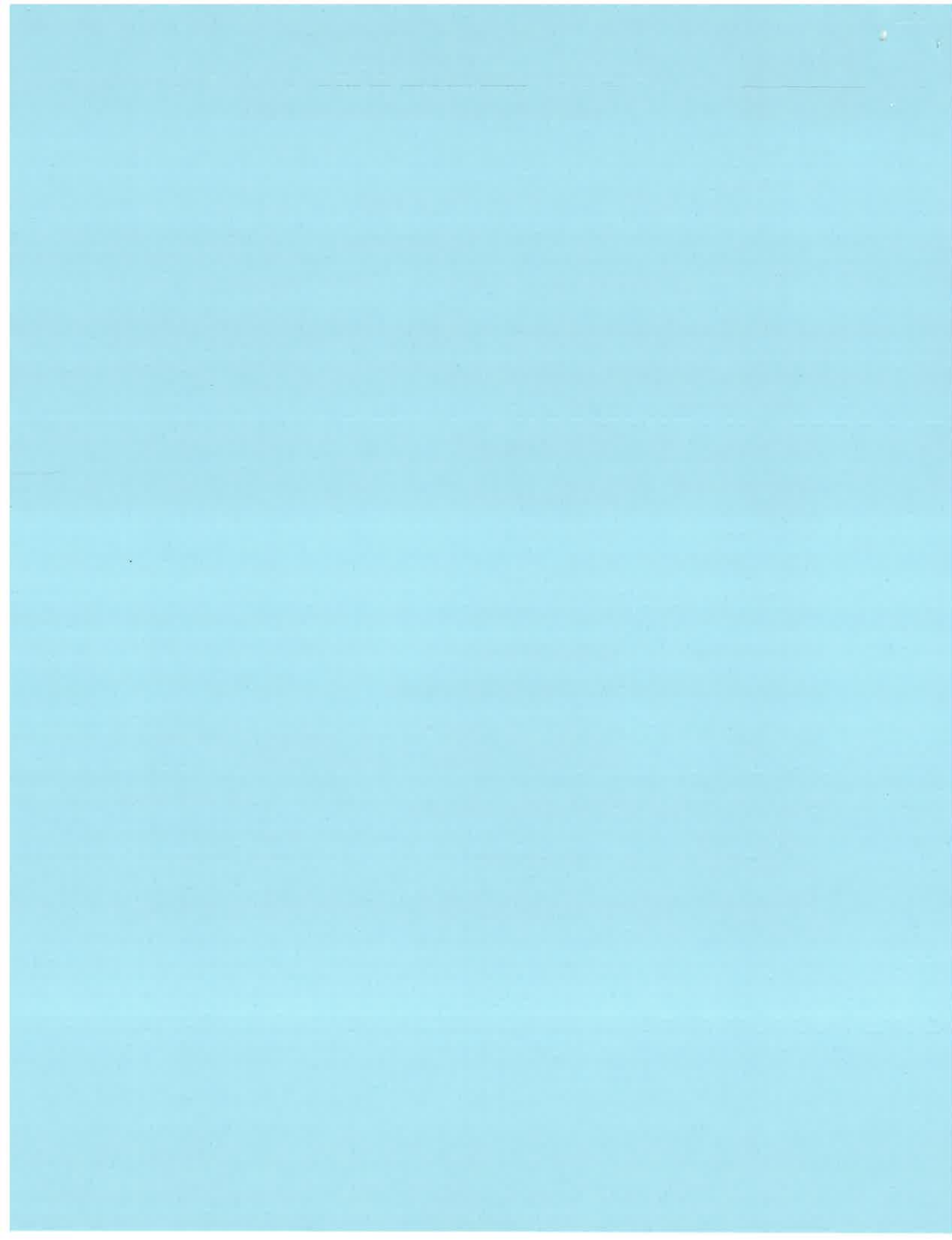

To Todd County Board of Commissioners:

According to the advertisement of Todd County inviting proposals for the improvement of the section of highway hereinbefore named, and in conformity with the Contract, Plans, Specifications and Special Provisions pertaining thereto, all on file in the office of the Engineer of Todd County:

(I)(We) hereby certify that (I am)(we are) the only person(s) interested in this proposal as principal(s); that this proposal is made and submitted without fraud or collusion with any other person, firm or corporation at all; that an examination has been made of the site of the work and the Contract form, with the Plans, Specifications and Special Provisions for the improvement.

(I)(We) understand that the quantities of work shown herein are approximate only and are subject to increase or decrease; that all quantities of work, whether increased or decreased within the limits specified in MnDOT 1903 and 1402, are to be done at the unit prices shown on the attached schedule; that, at the time of opening bids, totals only will be read, but that comparison of bids will be based on the correct summation of item totals obtained from the unit prices bid, as provided in MnDOT 1301.

(I)(We) propose to furnish all necessary machinery, equipment, tools, labor and other means of construction and to furnish all materials specified, in the manner and at the time prescribed, all according to the terms of the Contract and Plans, Specifications, and the Special Provisions forming a part of this.

(I)(We) further propose to do all Extra Work that may be required to complete the contemplated improvement, at unit prices or lump sums to be agreed upon in writing before starting such work, or if such prices or sums cannot be agreed upon, to do such work on a Force Account basis, as provided in MnDOT 1904.

(I)(We) further propose to execute the form of Contract within 7 days after receiving written notice of award, as provided in MnDOT 1306.

(I)(We) further propose to furnish a Payment Bond and a Performance Bond each equal to the Contract Amount as required by MN Statute § 574.26, as security for the construction and completion of the improvement according to the Plans, Specifications and Special Provisions as provided in MnDOT 1305.

(I)(We) further propose to do all work according to the Plans, Specifications and Special Provisions, and to renew or repair any work that may be rejected due to defective materials or workmanship, before completion and acceptance of the Project by Todd County.

(I)(We) agree to all provisions of Minnesota Statutes, Section 181.59.

(I)(We) further propose to begin work and to prosecute and complete the same according to the time schedule set forth in the Special Provisions for the improvement.

(I)(We) assign to Todd County all claims for overcharges as to goods and materials purchased in connection with this Project resulting from antitrust violations that arise under the antitrust laws of the United States and the antitrust laws of the State of Minnesota. This clause also applies to subcontractors and first tier suppliers under this Contract.

For Publication dates of February 12th, February 19th, and February 26th, 2025

(ABBREVIATED ADVERTISEMENT)

**TODD COUNTY
2025 GRAVEL SURFACING PROJECT
Closing date: March 11th, 2025**

Sealed bids will be accepted until 10:00 A.M., March 11th, 2025 by the Todd County Public Works Director/Engineer and County Auditor/Treasurer at 44 Riverside Drive, Long Prairie, Minnesota 56347 for the following construction projects:

CP 25:71

CP 25:85

CP 25:86

This is an abbreviated advertisement. A full advertisement can be viewed by going to the Public Works website at <https://egram.co.todd.mn.us/oneoffice/bidding>

Loren Fellbaum
Todd County Public Works Director/Engineer

This page was intentionally left blank.

TODD COUNTY
2025 GRAVEL SURFACING PROJECT
Closing date: March 11th, 2025

Sealed bids will be accepted until 10:00 A.M., March 11th, 2025 by the Todd County Public Works Director/Engineer and County Auditor/Treasurer at 44 Riverside Drive, Long Prairie, Minnesota 56347 for the following construction projects:

CP 25:71
Gravel Surfacing Project
County Road 71 (4,900 tons)

CP 25:85
Gravel Surfacing Project
County Road 85 (7,800 tons)

CP 25:86
Gravel Surfacing Project
County Road 86 (11,100 tons)

The above listed projects will be awarded as **one** contract. This contract includes, but is not limited to the application of 23,800 tons of gravel surfacing.

Paper copies of the Plan and Proposal are available for viewing and /or purchase at the Office of the Todd County Public Works Department, 44 Riverside Drive, Long Prairie, MN 56347. The non-refundable cost for the complete set of plans and proposal is \$50.00 (Minnesota State Sales Tax included). **Paper copies of the Plans and Proposal must be purchased from Todd County to become a plan holder, receive addendums and bid on the projects in this Contract.** Electronic versions of the Plan and Proposal are available ONLY as review copies and can be viewed / downloaded at: <https://egram.co.todd.mn.us/oneoffice/bidding> ; Look under Contracts in Bidding for the posted files.

Bid envelope shall be clearly labeled in the lower left-hand corner with the appropriate project number(s). The Todd County Board of Commissioners reserves the right to reject any or all bids, to waive any informalities or technicalities therein, and to award Contract to bidder submitting proposal which best serves the interests of Todd County.

Loren Fellbaum - Todd County Public Works Director/Engineer

This page was intentionally left blank.

NOTICE TO ALL BIDDERS

To report bid rigging activities call:

1-800-424-9071

The U.S. Department of Transportation (DOT) operates the above toll-free "hotline" Monday through Friday, 8:00 a.m. to 5:00 p.m., eastern time. Anyone with knowledge of possible bid rigging, bidder collusion, or other fraudulent activities should use the "hotline" to report such activities.

The "hotline" is part of the DOT's continuing effort to identify and investigate highway construction contract fraud and abuse and is operated under the direction of the DOT Inspector General. All information will be treated confidentially and caller anonymity will be respected.

This page was intentionally left blank.

**MINNESOTA DEPARTMENT OF TRANSPORTATION
NOTICE TO BIDDERS:
SUSPENSIONS/DEBARMENTS
THIS NOTICE APPLIES TO STATE-FUNDED AND FEDERALY-FUNDED PROJECTS**

Do not use suspended or debarred parties as subcontractors or material suppliers on this project!

Both the federal government and the State of Minnesota suspend and debar vendors. Review the list of suspended and debarred vendors before submitting a bid or a request to sublet. If your bid is based on using a suspended or debarred vendor, you will not be entitled to additional compensation for replacing the suspended or debarred vendor with a qualified vendor.

State Suspensions and Debarments

The State of Minnesota's list of suspended and debarred vendors is maintained by the Minnesota Department of Administration, Office of State Procurement, and can be found at this link: <https://mn.gov/admin/osp/government/suspended-debarred/index2.jsp> . This list includes parties suspended and debarred by the Minnesota Department of Transportation and the Minnesota Department of Administration.

Federal Suspensions and Debarments

The federal government maintains a searchable database of suspensions and debarments, called the System for Award Management (SAM), which is found at this link: <https://www.sam.gov/SAM/> . You can use the "Search Records" function without registering for an account.

September 29, 2023

This page was intentionally left blank.

INSTRUCTIONS TO BIDDERS

1. EXAMINATION OF PLANS, SPECIFICATIONS AND SITE WORK	1
2. PROPOSAL GUARANTY.....	1
3. CONTRACT DOCUMENTS	1
4. PREPARATION OF PROPOSAL	1
5. CONDITIONS IN THE BIDDER'S PROPOSAL	2
6. INTERPRETATION OF ESTIMATES	2
7. DELIVERY OF PROPOSALS	2
8. REJECTION OF PROPOSAL	2
9. WITHDRAWAL OF PROPOSAL	2
10. PUBLIC OPENING OF PROPOSALS	2
11. DISQUALIFICATION OF BIDDERS	2
12. EQUIPMENT	2
13. FURNISHING OF EVIDENCE OF RESPONSIBILITY	2
14. AWARD OF CONTRACT	3
15. RESPONSIVE/RESPONSIBLE BID	3
16. REQUIREMENTS OF CONTRACT BOND	3
17. FAILURE TO EXECUTE CONTRACT	3
18. UNIT PRICES	3
19. OWNER DELETION RIGHT	3
20. NONDISCRIMINATION IN EMPLOYMENT	3
21. SURETY DEPOSITS	3
22. ADDENDA	3

INSTRUCTIONS TO BIDDERS

1. EXAMINATION OF PLANS, SPECIFICATIONS AND SITE WORK

The bidder shall examine to his satisfaction the quantities of work to be done as determined from the plans and specifications. Quantities indicated by the Engineer on drawings or elsewhere are estimated only, and bidders must rely on their own calculations. Bidders shall be thoroughly familiar with Contract Documents including all General Conditions and Special Provisions.

Bidders shall inform themselves of the character and magnitude of work and the conditions under which the work is to be performed concerning the site of the work, the structure of the ground, the existence of surface and ground water, availability of drainage, the obstacles which may be encountered, means of approach to the site, manner of delivery and handling materials, facilities of transporting equipment and all other relevant matters pertaining to the complete execution of this Contract. No plea of ignorance of conditions that exist or that may hereafter exist, or of difficulties that will be encountered in the execution of the work hereunder which result from failure to make necessary examinations and investigations, will be accepted as a sufficient excuse for any failure or omission on the part of the Contractor to fulfill in every detail all the requirements of this Contract, or will be accepted as a basis for any claim whatsoever for extra compensation, or for an extension of time. No bidder may rely upon any statements or representations of any officer, agent, or employee of the Owner with reference to the conditions of the work, of the character of the soil, or other hazards which may be encountered in the course of construction.

2. PROPOSAL GUARANTY

Each bid shall be accompanied by a bid security in the form and amount as specified in the Standard Specification for Construction. Such bid security is a guarantee that the bidder will enter into a contract with the Owner for the work described in the proposal; and the amount of the bid security of a successful bidder shall be forfeited to the Owner as liquidated damages in the event that such bidder fails to enter into a contract and furnish Contractor's bond.

3. CONTRACT DOCUMENTS

The Contract Documents will consist of the Advertisement for Bids, Instruction to Bidders, Special Provisions, Specifications, Schedule(s) of Prices, Proposal Form, Contract for Construction, Non-Collusion Affidavit, Contract Bond, and all plans and drawings. These documents are on file with the Owner.

4. PREPARATION OF PROPOSAL

The bidder shall submit his proposal on the form provided by the Engineer.

The blank spaces in the proposal shall be filled in correctly with ink or where indicated for each and every item for which a quantity is given, and the bidder shall state the prices for which he proposes to do each item of the work contemplated. All alterations, corrections, or deletions shall nullify the bid unless each alteration, correction, or deletion is initialed by the bidder. No use of white correction fluid or tape will be allowed to make bid corrections.

The bidder's proposal shall be signed correctly with ink. If the proposal is made by an individual, his name and post office address shall be shown. If made by a firm or partnership, the name and post office address of each member of the firm or partnership shall be shown. If made by a corporation, the person signing the proposal shall show the name of the state under the law of which the corporation was chartered, and names, titles and business addresses of the president, secretary, and treasurer. All bids for corporations shall bear the official seal of the corporation.

5. CONDITIONS IN THE BIDDER'S PROPOSAL

The bidder shall not stipulate in his proposal any conditions not provided for on the Proposal Form.

6. INTERPRETATION OF ESTIMATES

The Engineer's estimate of quantities as shown in the proposal shall be used as a basis of calculation upon which the award of contract will be made, but these quantities are not guaranteed to be accurate and are furnished without any liability on the part of the Owner.

7. DELIVERY OF PROPOSALS

All bids shall be placed in a sealed envelope with a statement thereon showing the work covered by the bid, and addressed as stipulated in the Advertisement for Bids. Proposals may be mailed or submitted in person. No bids will be received after the time set for receiving them. Bids arriving by mail at the office of the Owner after the hour designated for receiving bids will be returned to the sender unopened.

8. REJECTION OF PROPOSAL

Proposals may be rejected if they show any omission, alteration of form, additions not called for, conditional bids or alternate bids not specified, or irregularities of any kind. Proposals in which the prices are obviously unbalanced may be rejected.

9. WITHDRAWAL OF PROPOSAL

A bidder may withdraw his proposal without prejudice to himself, provided he files a written request to the Owner before the hour of opening of bids and such withdrawn proposal may be modified and resubmitted by the bidder at any time prior to the hour set for the opening of bids.

10. PUBLIC OPENING OF PROPOSALS

Proposals will be opened publicly and read aloud in such place as designated at the time and the date set in the "Advertisement for Bids". Bidders or their authorized agents are invited to be present.

11. DISQUALIFICATION OF BIDDERS

More than one proposal for the same project from an individual firm, partnership, or corporation under the same or different names will not be considered. Evidence that any bidder is interested in more than one proposal for the same work will cause rejection of all such proposals. Collusion between the bidders will be considered sufficient cause for the rejection of all bids so affected.

Failure on the part of any bidder to carry out previous contracts satisfactorily or his lack of the experience or equipment necessary for the satisfactory completion of the work may be deemed sufficient cause for his disqualification.

12. EQUIPMENT

When requested by the Owner, the bidder shall furnish a complete statement of the make, size, weight (where weight is one of the specified requirements), condition, and previous length of service of all equipment to be used in the proposed work.

13. FURNISHING OF EVIDENCE OF RESPONSIBILITY

When requested by the Owner, the bidder shall furnish a balance sheet, certified by a certified public accountant as to a date not more than sixty (60) days prior to the date of the opening of the proposals which shall set forth outstanding assets and liabilities in reasonable detail. The bidder shall also furnish when requested, a list of work of a similar nature performed with dates of completion thereof. The bidder shall also furnish any other additional information relative to financial responsibility and competence to do the work as may be requested by the Owner prior to the acceptance of any proposal.

14. AWARD OF CONTRACT

The award of the Contract will be made to the lowest responsive, responsible Bidder, based on the Proposal Form with the lowest TOTAL BID AMOUNT. If discrepancies exist between an extension, or indicated sum of any column of figures, the corrected extensions or sum thereof will govern. Owner reserves the right to reject any and all bids, the right to waive any and all informalities, and the right to disregard all nonconforming or conditional bids or counter proposals.

15. RESPONSIVE/RESPONSIBLE BID

A responsible Bid is one from a Bidder that has:

- a. Financial resources, technical qualifications, experience, organization, and facilities adequate to carry out the project, or a demonstrated ability to obtain these;
- b. Resources to meet the completion schedule contained in the Agreement;
- c. A satisfactory performance record for completion of other projects.

A "responsive" bid must include the following:

- a. Complete Proposal Form.
- b. Bid Security.

16. REQUIREMENTS OF CONTRACT BOND

The successful bidder, at the time of the execution of the Contract, shall furnish and at all times maintain a satisfactory and sufficient bond in full amount of the Contract as required by law with a corporate surety satisfactory to the Owner. The form of bond is that required by statute. Personal sureties will not be approved.

17. FAILURE TO EXECUTE CONTRACT

Failure to furnish the Contract Bond in a sum equal to the amount of the award, or to execute the Contract within ten (10) days, as specified, shall be just cause for the annulment of the award, and it shall be understood by the bidder that in the event of the annulment of the award, the amount of the guaranty deposited with the proposal shall be retained by the Owner, not as a penalty, but as liquidated damages.

18. UNIT PRICES

In case of error in the extension of prices, the unit bid prices shall govern. The Owner reserves the right to waive any informality in the bids at his discretion.

19. OWNER DELETION RIGHT

The Owner reserves the right to delete any line item from the bid prior to final contract execution.

20. NONDISCRIMINATION IN EMPLOYMENT

If awarded the project, the Bidder agrees not to discriminate on account of race, creed, or color as per Minnesota Statutes, Section 181.59 and Minnesota Statutes 363.

21. SURETY DEPOSITS

All out-of-state contractors on construction work over \$100,000 will be required to file an exemption from Surety Deposit (Form SD-E) prior to their first progress payment.

22. ADDENDA

If any addenda are required as determined by the Engineer, it is the responsibility of the Contractor to verify the issuance and receipt of any addenda, and to properly acknowledge such addenda in the appropriate location on the Proposal Form. The Engineer will not accept phone calls nor issue addenda 24 hours before the bid date.

PROPOSAL INDEX

Notice to Bidders - Prompt Payments to Subcontractors		1-2
Section	Special Provisions Division S - Special Requirements	Page
S-1	(1203) Access to Proposal Package	1-S
S-2	(1206) Preparation of Proposal	1-S
S-3	(1208) Proposal Guaranty	2-S
S-4	(1209) Delivery of Proposals	2-S
S-5	(1210) Revision of Proposal Package or Withdrawal of Proposals	3-S
S-6	(1212) Opening of Proposals	3-S
S-7	(1404/1707/2563) Maintenance of Traffic/Public Safety/Traffic Control	3-S
S-8	(1603) Materials: Specifications, Samples, Test and Acceptance	5-S
S-9	(1701) Laws to Be Observed	5-S
S-10	(1702) Permit, Licenses, and Taxes	6-S
S-11	(1801) Subletting of Contract	6-S
S-12	(1806) Determination and Extension of Contract Time	6-S
S-13	(1807) Failure to Complete the Work on Time	7-S
S-14	(1906) Partial Payments	7-S
S-15	(2118) Aggregate Surfacing	7-S
S-16	(3138) Aggregate for Surface and Base Courses	7-S
S-17	(3146) Binder Soil	11-S
S-18	Pre-Construction Conference	11-S
S-19	Award of Contract	11-S
S-20	Responsible Contractor	11-S

Attachments	
CP 25:71 Plan Set	1-2
CP 25:85 Plan Set	1-2
CP 25:86 Plan Set	1-2
SALT Schedule of Materials Control - Local Government Agency	1-38
Non-Collusion Affidavit	1
Affirmative Action Certification	1
Responsible Contractor Verification and Certification of Compliance	1-5
Schedule of Prices	1-2
MnDOT Form 2116D	1

This page was intentionally left blank.

NOTICE TO BIDDERS

Minnesota Statutes require prompt payment to subcontractors:

Minn. Stat. § 471.425 PROMPT PAYMENT OF LOCAL GOVERNMENT BILLS.

Subdivision 1. **Definitions.** For the purposes of this section, the following terms have the meanings here given them.

. . . (d) "Municipality" means any home rule charter or statutory city, county, town, school district, political subdivision or agency of local government. "Municipality" means the Metropolitan Council or any board or agency created under chapter 473.

. . . Subd. 4a. **Prompt payment to subcontractors.** Each contract of a municipality must require the prime contractor to pay any subcontractor within ten days of the prime contractor's receipt of payment from the municipality for undisputed services provided by the subcontractor. The contract must require the prime contractor to pay interest of 1-1/2 percent per month or any part of a month to the subcontractor on any undisputed amount not paid on time to the subcontractor. The minimum monthly interest penalty payment for an unpaid balance of \$100 or more is \$10. For an unpaid balance of less than \$100, the prime contractor shall pay the actual penalty due to the subcontractor. A subcontractor who prevails in a civil action to collect interest penalties from a prime contractor must be awarded its costs and disbursements, including attorney's fees, incurred in bringing the action.

Minn. Stat. § 15.72 PROGRESS PAYMENTS ON PUBLIC CONTRACTS; RETAINAGE.

. . . Subd. 2. **Retainage.** . . . (c) A contractor on a public contract for a public improvement must pay all remaining retainage to its subcontractors no later than ten days after receiving payment of retainage from the public contracting agency, unless there is a dispute about the work under a subcontract. If there is a dispute about the work under a subcontract, the contractor must pay out retainage to any subcontractor whose work is not involved in the dispute, and must provide a written statement detailing the amount and reason for the withholding to the affected subcontractor.

This page was intentionally left blank.

SPECIAL PROVISIONS

DIVISION S

Special Requirements

S-1 (1203) ACCESS TO PROPOSAL PACKAGE

MnDOT 1203 is hereby deleted from the MnDOT Standard Specifications.

S-2 (1206) PREPARATION AND DELIVERY OF PROPOSAL

The provisions of MnDOT 1206 are supplemented and/or modified with the following:

MnDOT 1206.1 is hereby deleted from the MnDOT Standard Specifications.

1206.2 ALLOWABLE SUBSTITUTIONS

For all Proposals the Bidder shall use the following method:

- (1) Submit a Proposal on the Bid Schedule forms provided by the Department. The Bidder shall:
 - (1.1) Submit a Unit Price in numeric figures for each Pay Item for which a quantity is shown. Assume a numeric quantity of "1" for each "Lump Sum" Pay Item, except as not required in the case of alternate Pay Items,
 - (1.2) Show the extensions resulting from Unit Prices multiplied by the shown quantities in the specified column, and
 - (1.3) Add the extended Pay Item amounts to show the total amount of the Proposal.

The Bidder shall write the figures in ink or provide typed or computer printed figures. In the case of a discrepancy between a Unit Price and extension in a Proposal, the Unit Price will govern.

If a Bidder fails to provide a Unit Price for any Pay Item on the Bid Schedule, except for "Lump Sum" Pay Items, the Department will reject the Proposal.

If a Pay Item in the Proposal requires the Bidder to choose an alternate Pay Item, the Bidder shall indicate its choice in accordance with the Specifications for that Pay Item.

An authorized representative of the Bidder must sign the Proposal.

An authorized representative of the Bidder must sign the Proposal.

When submitting a Proposal in accordance with 1206.2, "Allowable Substitutions," of these Special Provisions, the Bidder shall deliver the Proposal and the Proposal Guaranty in a sealed envelope. The Bidder shall mark the sealed envelope with the name of the Bidder, the Project number, and the letting date. The Bidder shall deliver the sealed envelope to the Department as specified in the Advertisement for Bids as follows:

- (1) To the address specified,
- (2) In care of the official receiving the Proposals, and
- (3) By the date and time for opening Proposals.

The Bidder shall return paper copies of the following with the submitted Proposal:

- (1) Proposal title sheet;
- (2) The complete "Schedule of Prices," with all changes made in ink and initialed;
- (3) Form 21126D, "Proposal Signature Page" attached to the back of the Proposal, with signatures and all Addenda acknowledged;
- (4) Form CM 32-34, "EEO Clause;"
- (5) Non-collusion affidavit; and
- (6) Any other forms included in the Proposal Package.

If the Department receives a Proposal after the date and time for opening Proposals, the Department will return the Proposal to the Bidder unopened.

S-3 (1208) PROPOSAL GUARANTY

The provisions of MnDOT 1208 are supplemented and/or modified with the following:

The Bidder shall include with its Proposal a Proposal Guaranty that meets the following requirements:

- (1) Equal to 5 percent of the total amount of the Proposal
- (2) Made payable to the Department
- (3) In the form of a certified check, a cashier's check, or a bond

If providing a Proposal Guaranty in the form of a bond, the bond must meet the following requirements:

- (1) Issued by a corporation authorized by the Minnesota Department of Commerce to contract as a Surety in the State of Minnesota
- (2) Conditioned on execution of the Contract in accordance with 1306, "Execution and Approval of Contract"

S-4 (1209) DELIVERY OF PROPOSALS

The provisions of MnDOT 1209 shall contain the following:

When submitting a Proposal in accordance with 1206.2, "Allowable Substitutions," of these Special Provisions, the Bidder shall deliver the Proposal and the Proposal Guaranty in a sealed envelope. The Bidder shall mark the sealed envelope with the name of the Bidder, the Project number, and the letting date. The Bidder shall deliver the sealed envelope to the Department as specified in the Advertisement for Bids as follows:

- (1) To the address specified,
- (2) In care of the official receiving the Proposals, and
- (3) By the date and time for opening Proposals.

The Bidder shall return paper copies of the following with the submitted Proposal:

- (1) Proposal title sheet;
- (2) The complete "Schedule of Prices," with all changes made in ink and initialed;
- (3) Form 21126D, "Proposal Signature Page" attached to the back of the Proposal, with signatures and all Addenda acknowledged;

- (4) Non-collusion affidavit; and
- (5) Any other forms included in the Proposal Package.

If the Department receives a Proposal after the date and time for opening Proposals, the Department will return the Proposal to the Bidder unopened.

S-5 (1210) REVISION OF PROPOSAL PACKAGE OR WITHDRAWAL OF PROPOSALS

The provisions of MnDOT 1210 are deleted and replaced with the following:

When submitting a Proposal in accordance with 1206.2, "Allowable Substitutions," of these Special Provisions, the Bidder may revise or withdraw its Proposal after delivery to the Department if the Department receives the Bidder's written request for withdrawal or revision before the date and time for opening Proposals.

The Department reserves the right to revise the Proposal Package at any time before the date and time for opening Proposals. The Department will issue a numbered and dated Addendum for any revision of the Proposal Package. The Department will post each Addendum as announced in an e-mail or other method of notification to each Bidder on the Department's list of Bidders.

The Department will include each Addendum with all Proposal Forms issued to the Bidder after the date of the Addendum.

If revisions made by an Addendum require change to Proposals or reconsideration by the Bidder, the Department may postpone opening Proposals. If the Department postpones opening Proposals, the Department will specify the new date and time for opening Proposals in the Addendum.

The Bidder shall acknowledge receipt of each Addendum in the proposal.

S-6 (1212) OPENING OF PROPOSALS

The provisions of MnDOT 1212 are modified with the following:

MnDOT 1212 is hereby deleted from the MnDOT Standard Specifications and replaced with the following:

1212 OPENING OF PROPOSALS

The Department will open Proposals at the time, date, and place defined in the Proposal Package and the Advertisement for Bids.

S-7 (1404) MAINTENANCE OF TRAFFIC, (1707) PUBLIC SAFETY, AND (2563) TRAFFIC CONTROL

The provisions of Mn/DOT 1404 are supplemented as follows:

The Contractor shall furnish, install, maintain, and remove all traffic control devices required to provide safe movement of vehicular and/or pedestrian traffic passing through the work zone

during the life of the Contract from the start of Contract operations to the final completion thereof. The Engineer will have the right to modify the requirements for traffic control as deemed necessary due to existing field conditions.

Traffic control devices include, but are not limited to, barricades, warning signs, trailers, flashers, cones, drums, pavement markings and flaggers as required and sufficient barricade weights to maintain barricade stability.

The Contractor shall furnish names, addresses, and phone numbers of at least three (3) individuals responsible for the placement and maintenance of traffic control devices. At least one of these individuals shall be "on call" 24 hours per day, seven days per week during the times any traffic control devices, furnished and installed by the Contractor, are in place. The required information shall be submitted to the Engineer at the Pre-construction Conference. The Contractor shall also furnish the names, addresses, and phone numbers of those individuals to the following:

- | | |
|---|-----------------------|
| 1. Todd County Public Works Department | (320) 732-2722 |
| 2. Todd County Sheriff's Department | (320) 732-2157 |

The Contractor shall, at pre-construction conference, designate a Work Zone Safety Coordinator who shall be responsible for safety and traffic control management in the Project work zone. The Work Zone Safety Coordinator shall be either an employee of the Contractor such as a superintendent or a foreman, or an employee of a firm which has a subcontract for overall work zone safety and traffic control management for the Project. The responsibilities of the Work Zone Safety Coordinator shall include, but not be limited to:

- Coordinating all work zone traffic control operations of the Project, including those of the Contractor, subcontractors and suppliers.
- Establishing contact with local school district, government, law enforcement, and emergency response agencies affected by construction before work begins.
- Maintaining a record of all known crashes within a work zone. This record should include all available information, such as: time of day, probable cause, location, pictures, sketches, weather conditions, interferences to traffic, etc. These records shall be made available to the Engineer upon request.

The Contractor shall inspect, on a daily basis, all traffic control devices, which the Contractor has furnished and installed, and verify that the devices are placed in accordance with the Traffic Control Layouts, these Special Provisions, and/or the MN MUTCD. Any discrepancy between the placement and the required placement shall be immediately corrected. The person performing the inspection shall be required to make a daily log. This log shall also include the date and time any changes in the stages, phases, or portions thereof go into effect. The log shall identify the location and verify that the devices are placed as directed or corrected in accordance with the Plan. All entries in the log shall include the date and time of the entry and be signed by the person making the inspection. The Engineer reserves the right to request copies of the logs as he deems necessary.

Measurement and Payment:

All traffic control required under this Contract shall be performed as incidental work for which no direct payment will be made.

The Contractor shall furnish, install and maintain all traffic control devices for projects in this contract, this includes all the signage as indicated in the construction plans. The Contractor will be required to maintain traffic flow throughout the life of the contract.

S-8 (1603) MATERIALS: SPECIFICATIONS, SAMPLES, TESTS AND ACCEPTANCE

The first paragraph of MnDOT 1603.2 is hereby deleted and replaced with the following:

Sampling and testing of materials for this project will be in accordance with the State Aid for Local Transportation (SALT) "Schedule of Materials Control – Local Government Agency" (SMC-LGA). The SMC-LGA establishes the size of samples and the minimum rate of testing. The SMC-LGA references the 2020 MnDOT Standard Specifications for Construction and does not set contract requirements for the material.

S-9 (1701) LAWS TO BE OBSERVED

The provisions of MnDOT 1701 are supplemented and/or modified with the following:

1701.7 Compliance with Tax Law Requirements

The Department cannot make final payment to the Contractor until the Contractor demonstrates that it and all its Subcontractors have complied with the Income Tax withholding requirements of Minnesota Statutes, section 290.92 and section 270C.66 for wages paid for Work performed under the Contract. To establish compliance, the Contractor must submit a "Contractor Affidavit" either online or in paper form (IC134) to the Minnesota Department of Revenue. The Contractor will receive a written certification of compliance when the Department of Revenue determines that all withholding tax returns have been filed and all withholding taxes attributable to the Work performed on the Contract have been paid. The Contractor must then provide this written certification to the Department to receive final payment.

Every Subcontractor working on the Project must submit an approved "Contractor Affidavit" from the Minnesota Department of Revenue to the Contractor before the Contractor can file its own Contractor Affidavit. The Contractor is advised to obtain the certification from each Subcontractor as soon as the Subcontractor completes Work on the Project. Experience has shown that waiting until the Project is complete to obtain the forms from all Subcontractors is likely to result in significant additional Work for the Contractor as it will be difficult or impossible to collect all forms.

The Department of Revenue, in association with the Department of Employment and Economic Development, offers a free seminar to help Contractors understand tax law requirements. The Department strongly urges the Contractor and all Subcontractors to attend the "Employment Taxes & Employer Responsibilities Seminar" or similarly offered classes. You can find a schedule and more information on the Department of Revenue website (www.revenue.state.mn.us).

Complying with this requirement is considered part of the Work under this Contract. The Department will enforce this requirement equally with all other Contract requirements. The Contractor delay in complying with this requirement will cause the Department to delay final payment and Contract Acceptance. The Department may also report non-compliance to the

Department of Revenue, which may result in enforcement action by the Department of Revenue.

Contractor Affidavit requirements and Form IC134 can be found on the Department of Revenue website (www.revenue.state.mn.us).

S-10 (1702) PERMITS, LICENSES, AND TAXES

The provisions of MnDOT 1702 are supplemented as follows:

Any such permits required to complete the work shall be the Contractor's responsibility to obtain and will be considered incidental. This includes, but is not limited to;

S-10.1 Water Use Permits:

MN DNR Water Appropriation permitting associated with dewatering, water use, or transport.

S-10.2 Land Use Permits:

Todd County Mining and Extraction Permits (for pits within Todd County) from the Todd County Soil Water Conservation Development/Planning & Zoning Department. The Contractor shall supply the County Engineer with a copy of the permit(s) before work begins.

Conditional Use Permits require approval from the Todd County Planning Commission on their scheduled meeting dates which can be found at:

<https://www.co.todd.mn.us/divisions/soil-water-conservation-and-development/planning-zoning/>

S-10.3 Others / Existing Permits:

In addition, it shall be the Contractor's responsibility to comply with the Special Conditions of all permits already obtained by the County for the construction of these projects; copies of which are on file at the Todd County Public Works Department and included in this proposal.

S-11 (1801) SUBLETTING OF CONTRACT

The provisions of MnDOT 1801 are modified as follows:

For Projects in excess of \$50,000, the Contractor may sublet work only to subcontractors that meet the definition of "responsible contractor" in Minnesota Statutes §16C.285, subdivision 3. The Contractor shall obtain verifications of compliance with §16C.285 from subcontractors using a form provided by the Department. The Contractor must provide such verifications to the Department upon the Department's request.

S-12 (1806) DETERMINATION AND EXTENSION OF CONTRACT TIME

The provisions of MnDOT 1806 are supplemented as following:

Contractor must complete all Work to meet the requirements of 1516.2 (Project Acceptance) under this Contract before **October 10th, 2025**.

S-13 (1807) FAILURE TO COMPLETE THE WORK ON TIME

The provisions of MnDOT 1806 are supplemented as following:

The Department will deduct liquidated damages from money due the Contractor for each calendar day that the Work remains incomplete after expiration of the Contract Time, according to the completion requirements of 1516.2 (Project Acceptance). The Engineer will deduct liquidated damages based on the original Contract Amount and Table 1807.1-1.

S-14 (1906) PARTIAL PAYMENTS

The provisions of Spec. 1906 are modified as follows:

From the total amount ascertained as payable on each partial estimate, an amount equal to five percent (5%) will be retained by the contracting agency. This five percent (5%) will be held and included in the final payment and will be considered necessary to protect the Agency's interests in consideration of charges or assessments against the Contractor.

S-15 (2118) AGGREGATE SURFACING

The provisions of Spec. 2118 are supplemented as following:

No recycled materials will be allowed in the production of the surfacing aggregate. All surfacing aggregate will be produced using virgin material only.

S-16 (3138) AGGREGATE FOR SURFACE AND BASE COURSES

The provisions of Spec. 3138 are replaced with the following:

3138.1 SCOPE

This specification lists the quality requirements for aggregates used for 2118, 2211, and 2221.

3138.2 REQUIREMENTS

A General

Use aggregate sources meeting the requirements of 1601, "Source of Supply and Quality."

Provide certified aggregate materials that have uniform: appearance, texture, moisture content, and performance characteristics.

Provide binder soils from sources meeting the requirements of 3146, "Binder Soil." Add binder soils during the crushing and screening operations.

B Virgin Materials

Provide virgin aggregates meeting the following requirements:

- (1) Comprised of naturally occurring mineral materials, and contains no topsoil, organics, or disintegrating rock as defined in Laboratory Manual section 1209,
- (2) Class 2 must be composed of 100% crushed quarry rock, and
- (3) Conforms to the quality requirements of Table 3138-1.

Table 3138-1 Quality Requirements for Virgin Materials				
Requirement	Class			
	1 and 2	3 and 4	5 and 5Q	6
Max Shale, if No. 200 ≤ 7% by mass	NA	10.0%	10.0%	7.0%
Max Shale, if No. 200 > 7% by mass	NA	7.0%	7.0%	7.0%
Minimum Crushing Requirements *	NA	NA	10%	15%
Maximum Los Angeles Rattler (LAR) loss from carbonate quarry rock	40%	40%	40%	35%
Maximum Insoluble residue for the portion of quarried carbonate aggregates passing the No. 200 sieve	10%	10%	10%	10%
* Material crushed from quarries is considered crushed material.				

C Recycled Materials

The Contactor may substitute recycled aggregates for virgin aggregates, if meeting the following requirements:

- (1) Recycled aggregates contain only recycled asphalt pavement (RAP), recycled concrete materials, recycled aggregate materials, or certified recycled glass, and
- (2) Must meet the requirements of Table 3138-2.

Table 3138-2 Quality Requirements for Recycled Materials	
Requirement	Classes 1, 3, 4, 5, 5Q and 6
Maximum Bitumen Content of Composite	3.5%
Maximum Masonry block %	10%
Maximum percentage of glass *	10%
Maximum size of glass *	¾ in
Crushing (Class 1, 5, 5Q, and 6)	10% for Class 1 & 5 †, 60% for Class 5Q †, and 15% for Class 6 †
Maximum amount of Brick	1.0% #
Maximum amount of other objectionable materials including but not limited to: wood, plant matter, plastic, plaster, and fabric	0.3% #
* Glass must meet certification requirements on the Grading and Base website. Combine glass with other aggregates during the crushing operation. † If material ≥ 20% RAP and/or Concrete, Class 5 crushing requirement is met.] † If material ≥ 60% RAP and/or Concrete, Class 5Q crushing requirement is met. † If material ≥ 30% RAP and/or Concrete, Class 6 crushing requirement is met. Material crushed from quarries is considered crushed material. # The Contractor/Supplier may not knowingly allow brick and other objectionable material and must employ a QC process to screen it out, before it becomes incorporated into the final product.	

D Surfacing Aggregates

Provide surfacing aggregates in accordance with 3138.2.A, “General,” 3138.2.B, “Virgin Materials,” and 3138.2.C, “Recycled Materials,” and meeting the following requirements:

- (1) 100% of the material passes the ¾” sieve, regardless of the class specified; this modifies the requirements of Tables 3138-3, 3138-4, and 3138-5 for surfacing aggregates.
 - (2) Does not use glass,
 - (3) Recycled concrete materials may only be used for the roadway shoulders, and
 - (4) There is no restriction on the bitumen content, if used for shouldering.
 - (5) Provide aggregate with a minimum clay content of 3% and a Plasticity Index (PI) of 5 – 12.
- The requirements for PI and minimum clay content are met:

- ☐ if the bitumen content is 1% or greater, or
- ☐ the material is composed of at least 25% recycled materials, or the material is composed of at least 50% crushed quarry aggregate.

Note: Class 2 must be composed of 100% crushed quarry rock per 3138.2.B.3.

E Gradation Requirements

- (1) For products containing less than 25 percent recycled materials, conform to Table 3138-3.
- (2) For products containing 25 percent or more recycled materials and less than 75% recycled concrete, conform to Table 3138-4. Bituminous millings meeting a gradation of 100% passing the 1.5" sieve and 95-100% passing the 1" sieve may be used for the 1-2' fillet/rollover outside of a paved shoulder for class 1 and class 2.
- (3) For products containing 75 percent or more recycled concrete, conform to Table 3138-5.
- (4) Perform gradation tests prior to bituminous extraction.

Sieve Size	Class 1 (Surfacing £)	Class 2 (Surfacing β)	Class 3 (Subbase)	Class 4 (Subbase)	Class 5 (Base)	Class 5Q (Base)	Class 6 (Base)
2 in	—	—	100	100	—	100	—
1½ in	—	—	—	—	100	—	100
1 in	—	—	—	—	—	65 – 95	—
¾ in	100	100	—	—	70 – 100	45 – 85	70 – 100
⅝ in	65 – 95	65 – 90	—	—	45 – 90	35 – 70	45 – 85
No. 4	40 – 85	35 – 70	35 – 100	35 – 100	35 – 80	15 – 45	35 – 70
No. 10	25 – 70	25 – 45	20 – 100	20 – 100	20 – 65	10 – 30	20 – 55
No. 40	10 – 45	12 – 30	5 – 50	5 – 35	10 – 35	5 – 25	10 – 30
No. 200	8.0–15.0	5.0–13.0	5.0–10.0	4.0–10.0	3.0–10.0	3.0–10.0	3.0–7.0

* If product contains recycled aggregate, add letters in parentheses for each aggregate blend designating the type of recycled products included in the mixture.
 (B) = Bituminous, (C) = Concrete, (G) = Glass
 (BC) = Bituminous and Concrete, (BG) = Bituminous and Glass
 (CG) = Concrete and Glass, (BCG) = Bituminous, Concrete, and Glass
 £ Recycled concrete is only allowed for shoulders
 β Class 2 must be composed of 100% crushed quarry rock per 3138.2.B.2.

Sieve Size	Class 1 (Surfacing £)	Class 3 (Subbase)	Class 4 (Subbase)	Class 5 (Base)	Class 5Q (Base)	Class 6 (Base)
2 in	—	100	100	—	100	—
1½ in	—	—	—	100	—	100
1 in	—	—	—	—	65 – 95	—
¾ in	100	—	—	70 – 100	45 – 85	70 – 100
⅝ in	65 – 95	—	—	45 – 90	35 – 70	45 – 85
No. 4	40 – 85	35 – 100	35 – 100	35 – 80	15 – 45	35 – 70
No. 10	25 – 70	20 – 100	20 – 100	20 – 65	10 – 30	20 – 55
No. 40	10 – 45 † 5 – 45	5 – 50	5 – 35	10 – 35	5 – 25	10 – 30
No. 200	5.0 – 15.0 † 0 – 15.0	0 – 10.0	0 – 10.0	0 – 10.0	0 – 10.0	0 – 7.0

* Add letters in parentheses for each aggregate blend designating the type of recycled products included in the mixture.
 (B) = Bituminous, (C) = Concrete, (G) = Glass
 (BC) = Bituminous and Concrete, (BG) = Bituminous and Glass
 (CG) = Concrete and Glass, (BCG) = Bituminous, Concrete, and Glass
 † Note: For Class 1, if the bitumen content is ≥ 1.5%, the gradation requirement is modified to 5 – 45% for the #40 sieve and 0 – 15.0% for the #200 sieve.
 £ Recycled concrete is only allowed for shoulders

Table 3138-5 Base and Surfacing Aggregate (containing more than 75 percent recycled concrete) Total Percent Passing *						
Sieve Size	Class 1 (Surfacing £)	Class 3 (Subbase)	Class 4 (Subbase)	Class 5 (Base)	Class 5Q (Base)	Class 6 (Base)
2 in	—	100	100	100	100	100
1½ in	—	—	—	—	—	—
1 in	—	—	—	—	65 – 95	—
¾ in	100	—	—	45 – 100	45 – 85	45 – 100
⅜ in	65 – 95	—	—	25 – 90	35 – 70	25 – 85

Table 3138-5 Base and Surfacing Aggregate (containing more than 75 percent recycled concrete) Total Percent Passing *						
Sieve Size	Class 1 (Surfacing £)	Class 3 (Subbase)	Class 4 (Subbase)	Class 5 (Base)	Class 5Q (Base)	Class 6 (Base)
No. 4	40 – 85	35 – 100	35 – 100	15 – 65	15 – 45	15 – 65
No. 10	25 – 70	20 – 100	20 – 100	10 – 45	10 – 30	10 – 45
No. 40	10 – 45	0 – 20	0 – 20	0 – 20	0 – 20	0 – 20
No. 200	5.0 – 15.0	0 – 6.0	0 – 6.0	0 – 6.0	0 – 6.0	0 – 6.0
* Add letters in parentheses for each aggregate blend designating the type of recycled products included in the mixture. (B) = Bituminous, (C) = Concrete, (G) = Glass, (BC) = Bituminous and Concrete, (BG) = Bituminous and Glass, (CG) = Concrete and Glass, (BCG) = Bituminous, Concrete, and Glass £ Recycled concrete is only allowed for shoulders						

3138.3 SAMPLING AND TESTING

Report the No. 200 sieve results to the nearest 0.1 percent and all other sieve results to the nearest 1 percent.

A Sampling, Sieve Analysis and Crushing Tests Grading and Base Manual

B Los Angeles Rattler Loss Laboratory Manual Method 1210

C Shale Tests Laboratory Manual Method..... 1207 & 1209

D Bitumen Content Laboratory Manual Method1852

E Insoluble Residue Laboratory Manual Method.....1221

F Reclaimed Glass AGI Visual Method (AGI Data sheet 15.1 and 15.2)

G Particle Size Analysis Laboratory Manual Method..... 1302

H Liquid Limit Determination Laboratory Manual Method..... 1303

I Plastic Limit Determination Laboratory Manual Method..... 1304

S-17 (3146) BINDER SOIL

The provisions of MnDOT 3146.3 are supplemented with the following:

- C The Engineer may perform Organic Content in Soils Test in accordance with AASHTO T267 (Standard Method of Test for Determination of Organic Content in Soils by Loss on Ignition) in order to determine if the material contains any organic material. The following monetary payment schedule will be used as follow:

<u>Percent Organics</u>	<u>Monetary Payment Deduction</u>
0.0% – 0.2%	0%
0.2% – 1.0%	10%
1.0% – 1.5%	20%
1.5% – 2.0%	30%
2.0% – 2.5%	40%
2.5% – 3.0%	50%
Greater than 3.0%	Material Removal

S-18 PRE-CONSTRUCTION CONFERENCE

There will be no preconstruction conference held for this project.

S-19 AWARD OF CONTRACT

CP 25:71, CP 25:85, & CP 25:86 will be awarded as one (1) contract.

S-20 RESPONSIBLE CONTRACTOR

The Department cannot award a construction contract in excess of \$50,000 unless the Bidder is a “responsible contractor” as defined in Minnesota Statutes §16C.285, subdivision 3. A Bidder submitting a Proposal for this Project must verify that it meets the minimum criteria specified in that statute by submitting the “Responsible Contractor Verification and Certification of Compliance” form. A company owner or officer must sign the “Responsible Contractor Verification and Certification of Compliance” form under oath verifying compliance with each of the minimum criteria. THE COMPLETED FORMS MUST BE SUMMITTED WITH THE BID PROPOSAL.

A bidder must obtain a verification from each subcontractor it will have a direct contractual relationship with. At the Department’s request, a bidder must submit signed subcontractor verifications. A contractor or subcontractor must obtain an annual verification from each motor carrier it has a direct contractual relationship with. A motor carrier must give immediate written notice if it no longer meets the minimum responsible contractor criteria. The requirement for subcontractor verifications does not apply to:

- Design professionals licensed under Minnesota Statutes §326.06; and
- A business or person that supplies materials, equipment, or supplies to a subcontractor on the Project, including performing delivering and unloading services in connection with the supply of materials, equipment, and supplies.

But, a business or person must submit a verification if it delivers mineral aggregate such as sand, gravel, or stone that will be incorporated into the Work by depositing the material substantially in place, directly or through spreaders, from the transporting vehicle.

A bidder or subcontractor who does not meet the minimum criteria specified in the statute, or who fails to verify compliance with the criteria, is not a “responsible contractor” and is ineligible to be awarded the Contract for this Project or to work on this Project. Submitting a false verification makes the bidder or subcontractor ineligible to be awarded a construction contract for this Project. Additionally, submitting a false statement may lead to contract termination. If only one bidder submits a bid, the Department may, but is not required to, award a contract even if that bidder does not meet the minimum criteria.

MINNESOTA DEPARTMENT OF TRANSPORTATION

TODD COUNTY

CONSTRUCTION PLAN FOR AGGREGATE SURFACING LOCATED ON CR #71 FROM 300TH ST TO 330TH ST

COUNTY PROJECT NO. 25:71
GROSS LENGTH 15,850 FEET 3.002 MILES
BRIDGES-LENGTH FEET MILES
EXCEPTIONS LENGTH FEET MILES
NET LENGTH 15,850 FEET 3.002 MILES

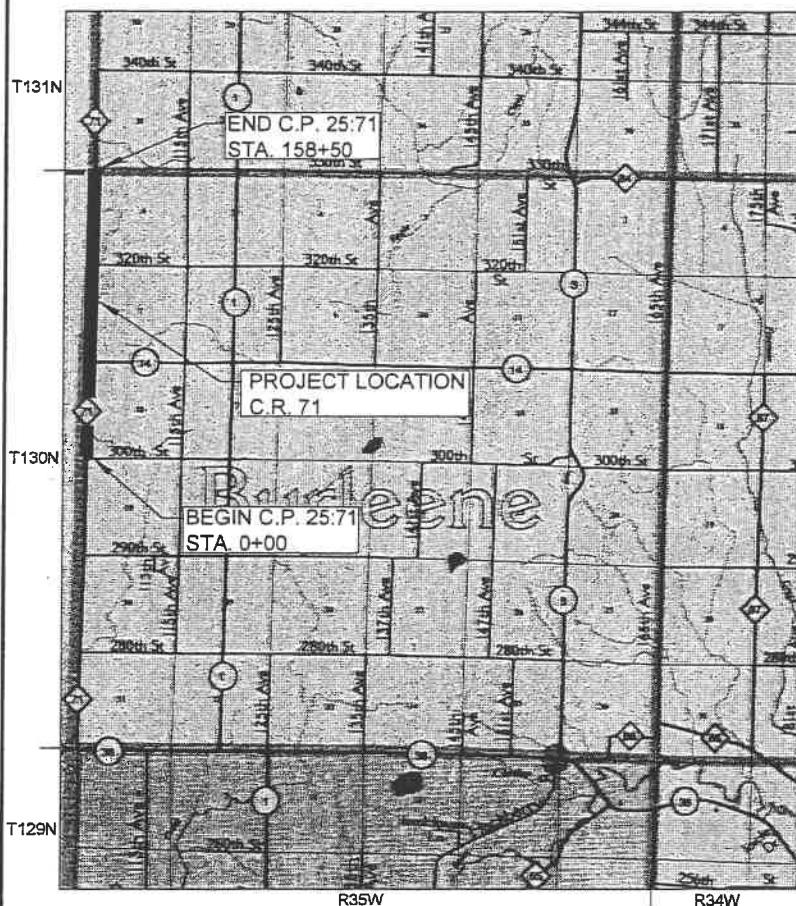

PARTIAL MAP - TODD COUNTY
SCALE: AS SHOWN



SCALE (IN MILES)

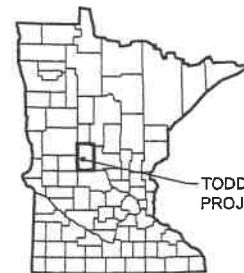

TODD COUNTY
PROJECT LOCATION

GOVERNING SPECIFICATIONS:

THE 2020 EDITION OF THE MINNESOTA DEPARTMENT OF
TRANSPORTATION "STANDARD SPECIFICATIONS FOR
CONSTRUCTION" SHALL GOVERN.

INDEX TO SHEETS:

SHEET NO.	DESCRIPTION
1	TITLE SHEET
2	ESTIMATED QUANTITIES & TYPICAL SECTION

THIS PLAN CONTAINS 2 SHEETS

ALL APPLICABLE FEDERAL, STATE, AND LOCAL LAWS AND
ORDINANCES WILL BE COMPLIED WITH IN THE CONSTRUCTION OF
THIS PROJECT.

I HEREBY CERTIFY THAT THIS PLAN WAS PREPARED BY ME OR UNDER MY DIRECT
SUPERVISION AND THAT I AM A DULY LICENSED PROFESSIONAL ENGINEER UNDER THE LAWS
OF THE STATE OF MINNESOTA.

APPROVED: Loren L. Fellbaum
LOREN L. FELLBAUM
TODD COUNTY ENGINEER

DATE: 01-10-25

TODD COUNTY PUBLIC WORKS
C.P. NO. 25:71
TITLE SHEET

SHEET NO.
1

SHEET 1 OF 2

STATEMENT OF ESTIMATED QUANTITIES				
NOTES	SPEC. NUMBER	ITEM	UNIT	EST. QUANT.
(1), (2), (3)	2118.509	AGGREGATE SURFACING CLASS 1 (MOD.)	TON	4,900

CONSTRUCTION NOTES:

- (1) MATERIAL SHALL CONFORM TO SPEC. 3138 FOR CLASS 1 AGGREGATE AND SHALL CONTAIN AT LEAST 10 PERCENT CRUSHED MATERIAL. NO ORGANIC MATERIAL WILL BE ALLOWED IN PRODUCTION, SEE SPECIAL PROVISIONS.
- (2) CONTRACTOR SHALL PROVIDE "ROAD WORK AHEAD" SIGNS ON THE ENDS OF THE PROJECT AND AT EACH INTERSECTING ROAD APPROACH AS DIRECTED BY THE ENGINEER. THIS WORK WILL BE CONSIDERED INCIDENTAL.
- (3) QUANTITY CONTAINS 10% ADDITIONAL QUANTITY FOR STRENGTHENING AND MISCELLANEOUS SHAPING.

BASIS FOR ESTIMATED QUANTITIES

AGGREGATE BASE DENSITY	105 LBS/SQ. YD./1" DEPTH
------------------------	--------------------------

STANDARD PLATES

THE FOLLOWING STANDARD PLATES, APPROVED BY THE FEDERAL HIGHWAY ADMINISTRATION SHALL APPLY ON THIS PROJECT

PLATE NO.	DESCRIPTION
8000K	TEMPORARY CHANNELIZERS

AGGREGATE SURFACING

STATION 0+00 TO STATION 158+50

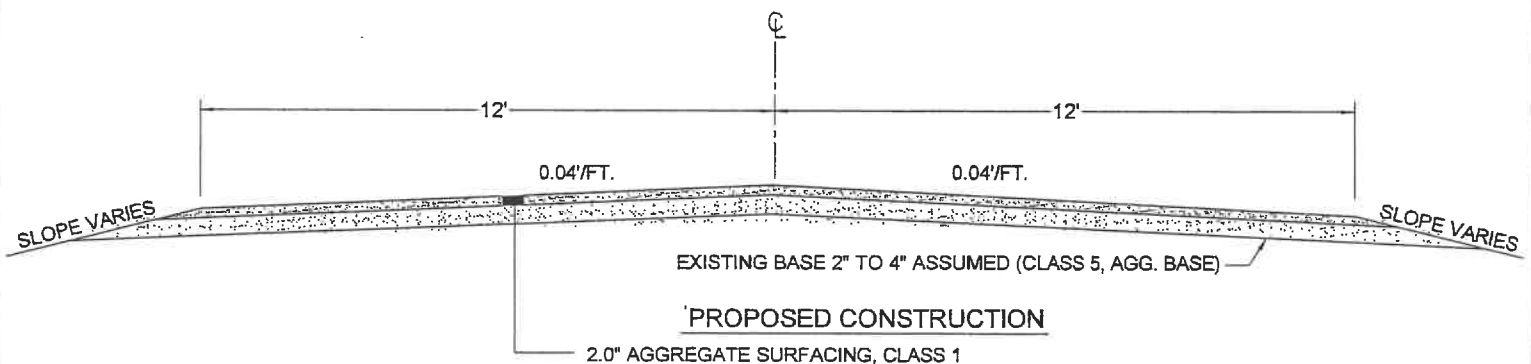

H:\PROJECTS\2025 PROJECTS\Gravel Surface Project\CDP 25-TICP-25-71-PL.dwg Plotted by: Todd Jackson 1/10/2025 11:38:00 AM



DATE: JAN. 2025
 HORIZ. SCALE: N/A
 VERT. SCALE: N/A
 DRAWN BY: T.B.L.
 CHECKED BY: W.W.J.
 PLAN STATUS: FINAL

I HEREBY CERTIFY THAT THIS PLAN WAS PREPARED BY ME OR UNDER MY DIRECT SUPERVISION AND THAT I AM A DULY LICENSED PROFESSIONAL ENGINEER UNDER THE LAWS OF THE STATE OF MINNESOTA.

Loren L. Fellbaum 01-10-25
 LOREN L. FELLBAUM LIC. NO. 43144 DATE

TODD COUNTY PUBLIC WORKS
 C.P. NO. 25:71
ESTIMATED QUANTITIES & TYPICAL SECTION

SHEET NO.
2

SHEET 2 OF 2

MINNESOTA DEPARTMENT OF TRANSPORTATION

TODD COUNTY

CONSTRUCTION PLAN FOR AGGREGATE SURFACING LOCATED ON CR #85 FROM 985' N. OF CSAH #10 TO CSAH #1

COUNTY PROJECT NO. 25:85
GROSS LENGTH 25,224 FEET 4.777 MILES
BRIDGES-LENGTH FEET MILES
EXCEPTIONS LENGTH FEET MILES
NET LENGTH 25,224 FEET 4.777 MILES

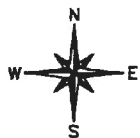
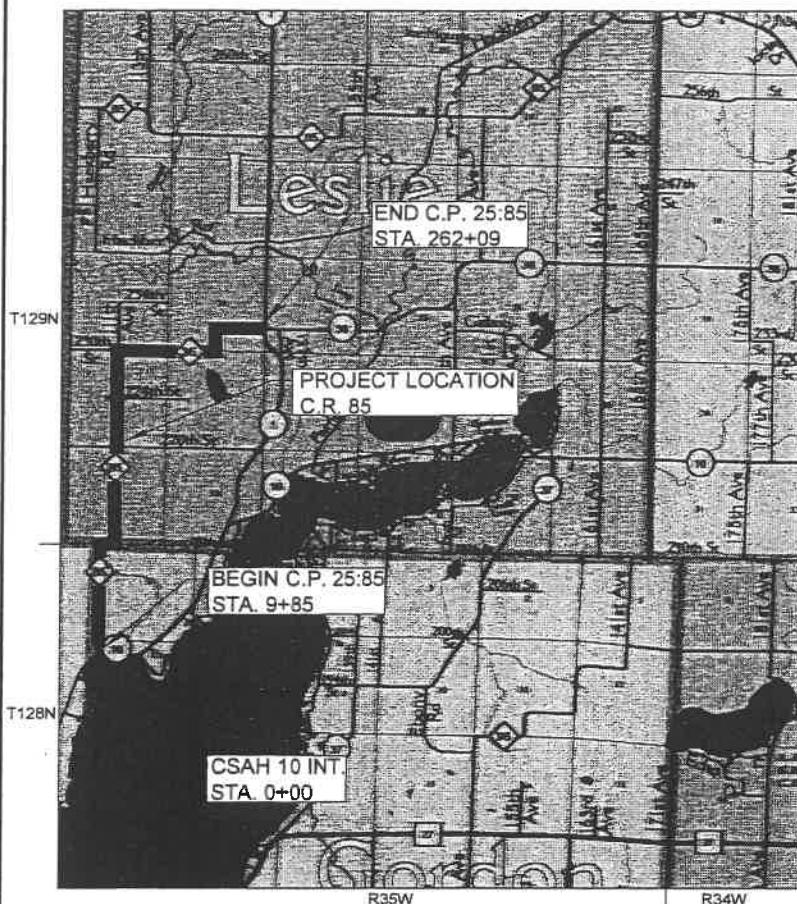

PARTIAL MAP - TODD COUNTY
SCALE: AS SHOWN



SCALE (IN MILES)

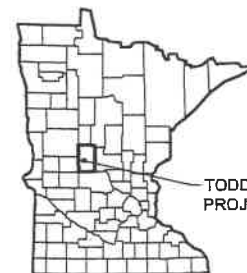

TODD COUNTY
PROJECT LOCATION

GOVERNING SPECIFICATIONS:

THE 2020 EDITION OF THE MINNESOTA DEPARTMENT OF
TRANSPORTATION "STANDARD SPECIFICATIONS FOR
CONSTRUCTION" SHALL GOVERN.

INDEX TO SHEETS:

SHEET NO.	DESCRIPTION
1	TITLE SHEET
2	ESTIMATED QUANTITIES & TYPICAL SECTION

THIS PLAN CONTAINS 2 SHEETS

ALL APPLICABLE FEDERAL, STATE, AND LOCAL LAWS AND
ORDINANCES WILL BE COMPLIED WITH IN THE CONSTRUCTION OF
THIS PROJECT.

I HEREBY CERTIFY THAT THIS PLAN WAS PREPARED BY ME OR UNDER MY DIRECT
SUPERVISION AND THAT I AM A DULY LICENSED PROFESSIONAL ENGINEER UNDER THE LAWS
OF THE STATE OF MINNESOTA.

APPROVED: 
LOREN L. FELLBAUM
TODD COUNTY ENGINEER

LIC. NO. 43144

DATE: 01-10-25

TODD COUNTY PUBLIC WORKS
C.P. NO. 25:85
TITLE SHEET

SHEET NO.

1

SHEET 1 OF 2

STATEMENT OF ESTIMATED QUANTITIES

NOTES	SPEC. NUMBER	ITEM	UNIT	EST. QUANT.
(1), (2), (3)	2118:509	AGGREGATE SURFACING CLASS 1 (MOD.)	TON	7,800

CONSTRUCTION NOTES:

- (1) MATERIAL SHALL CONFORM TO SPEC. 3138 FOR CLASS 1 AGGREGATE AND SHALL CONTAIN AT LEAST 10 PERCENT CRUSHED MATERIAL. NO ORGANIC MATERIAL WILL BE ALLOWED IN PRODUCTION, SEE SPECIAL PROVISIONS.
- (2) CONTRACTOR SHALL PROVIDE "ROAD WORK AHEAD" SIGNS ON THE ENDS OF THE PROJECT AND AT EACH INTERSECTING ROAD APPROACH AS DIRECTED BY THE ENGINEER. THIS WORK WILL BE CONSIDERED INCIDENTAL.
- (3) QUANTITY CONTAINS 10% ADDITIONAL QUANTITY FOR STRENGTHENING AND MISCELLANEOUS SHAPING.

BASIS FOR ESTIMATED QUANTITIES

AGGREGATE BASE DENSITY	105 LBS/SQ. YD./1" DEPTH
------------------------	--------------------------

STANDARD PLATES

THE FOLLOWING STANDARD PLATES, APPROVED BY THE FEDERAL HIGHWAY ADMINISTRATION SHALL APPLY ON THIS PROJECT

PLATE NO.	DESCRIPTION
8000K	TEMPORARY CHANNELIZERS

AGGREGATE SURFACING

STATION 9+85 TO STATION 262+09

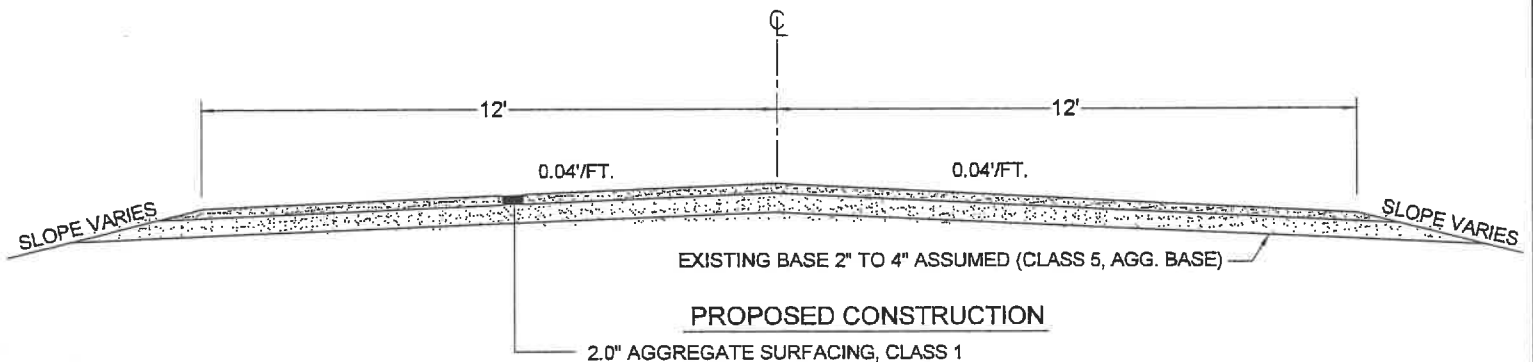

H:\PROJECTS\2025 PROJECTS\Travel Surface Projects\CP 25-85\CP-25-85-PL.dwg Plotted by: Todd Jankins 1/8/2025 11:42:17 AM



DATE: JAN. 2025
 HORIZ. SCALE: N/A
 VERT. SCALE: N/A
 DRAWN BY: T.B.J.
 CHECKED BY: W.W.J.
 PLAN STATUS: FINAL

I HEREBY CERTIFY THAT THIS PLAN WAS PREPARED BY ME OR UNDER MY DIRECT SUPERVISION AND THAT I AM A DULY LICENSED PROFESSIONAL ENGINEER UNDER THE LAWS OF THE STATE OF MINNESOTA.

Loren L. Fellbaum 01-10-25
 LOREN L. FELLBAUM LIC. NO. 43144 DATE

TODD COUNTY PUBLIC WORKS

C.P. NO. 25:85

ESTIMATED QUANTITIES & TYPICAL SECTION

SHEET NO.

2

SHEET 2 OF 2

MINNESOTA DEPARTMENT OF TRANSPORTATION TODD COUNTY

CONSTRUCTION PLAN FOR AGGREGATE SURFACING LOCATED ON CR #86 FROM CSAH #38 TO CSAH #11

COUNTY PROJECT NO. 25:86
GROSS LENGTH 27,134 FEET 5,139 MILES
BRIDGES-LENGTH FEET MILES
EXCEPTIONS LENGTH FEET MILES
NET LENGTH 27,134 FEET 5,139 MILES

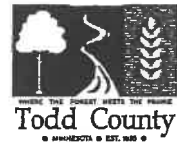
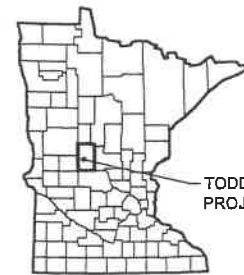
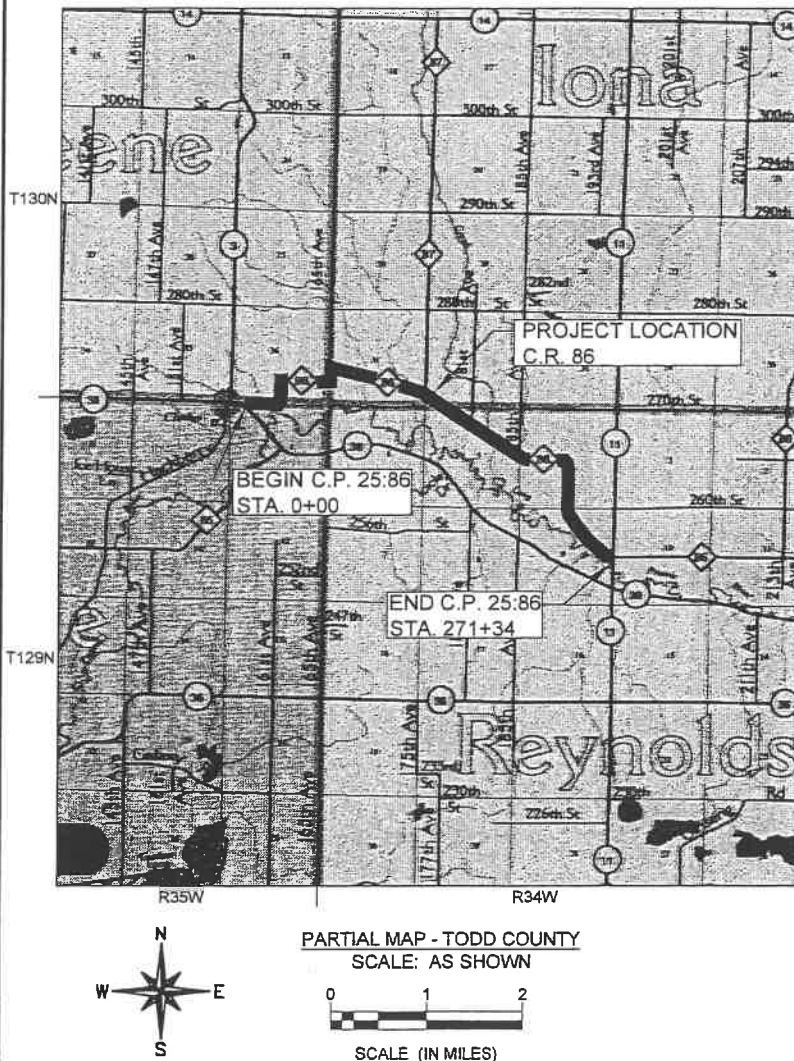

TODD COUNTY
PROJECT LOCATION

GOVERNING SPECIFICATIONS:

THE 2020 EDITION OF THE MINNESOTA DEPARTMENT OF
TRANSPORTATION "STANDARD SPECIFICATIONS FOR
CONSTRUCTION" SHALL GOVERN.

INDEX TO SHEETS:

SHEET NO.	DESCRIPTION
1	TITLE SHEET
2	ESTIMATED QUANTITIES & TYPICAL SECTION

THIS PLAN CONTAINS 2 SHEETS

ALL APPLICABLE FEDERAL, STATE, AND LOCAL LAWS AND
ORDINANCES WILL BE COMPLIED WITH IN THE CONSTRUCTION OF
THIS PROJECT.

I HEREBY CERTIFY THAT THIS PLAN WAS PREPARED BY ME OR UNDER MY DIRECT
SUPERVISION AND THAT I AM A DULY LICENSED PROFESSIONAL ENGINEER UNDER THE LAWS
OF THE STATE OF MINNESOTA.

APPROVED: 
LOREN L. FELLBAUM LIC. NO. 43144
TODD COUNTY ENGINEER

DATE: 01-10-25

HP\PROJECTS\2025 PROJECTS\Gravel Surface Projects\CP 25-86\CP-25-86-PL.dwg Plotted by: Todd Jackson 1/8/2025 11:27:18 AM

TODD COUNTY PUBLIC WORKS
C.P. NO. 25:86
TITLE SHEET

SHEET NO.

1

SHEET 1 OF 2

STATEMENT OF ESTIMATED QUANTITIES				
NOTES	SPEC. NUMBER	ITEM	UNIT	EST. QUANT.
(1), (2), (3)	2118.509	AGGREGATE SURFACING CLASS 1 (MOD.)	TON	11,100

CONSTRUCTION NOTES:

- (1) MATERIAL SHALL CONFORM TO SPEC. 3138 FOR CLASS 1 AGGREGATE AND SHALL CONTAIN AT LEAST 10 PERCENT CRUSHED MATERIAL. NO ORGANIC MATERIAL WILL BE ALLOWED IN PRODUCTION, SEE SPECIAL PROVISIONS.
- (2) CONTRACTOR SHALL PROVIDE "ROAD WORK AHEAD" SIGNS ON THE ENDS OF THE PROJECT AND AT EACH INTERSECTING ROAD APPROACH AS DIRECTED BY THE ENGINEER. THIS WORK WILL BE CONSIDERED INCIDENTAL.
- (3) QUANTITY CONTAINS 10% ADDITIONAL QUANTITY FOR STRENGTHENING AND MISCELLANEOUS SHAPING.

BASIS FOR ESTIMATED QUANTITIES

AGGREGATE BASE DENSITY	105 LBS/SQ. YD./1" DEPTH
------------------------	--------------------------

STANDARD PLATES

THE FOLLOWING STANDARD PLATES, APPROVED BY THE FEDERAL HIGHWAY ADMINISTRATION SHALL APPLY ON THIS PROJECT

PLATE NO.	DESCRIPTION
8000K	TEMPORARY CHANNELIZERS

AGGREGATE SURFACING

STATION 0+00 TO STATION 271+34

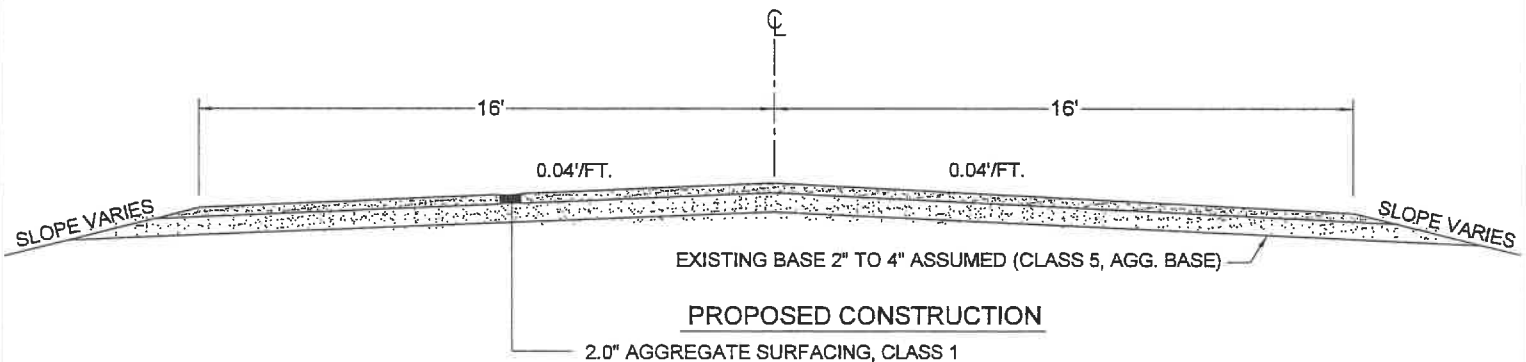

H:\PROJECTS\2025 PROJECTS\Road Surface Project\CP 25-ABCP-25-AB-PL.dwg - Plotted by Todd Jackson - 1/8/2025 11:57:20 AM



DATE: JAN. 2025
 HORIZ. SCALE: N/A
 VERT. SCALE: N/A
 DRAWN BY: T.B.J.
 CHECKED BY: W.W.J.
 PLAN STATUS: FINAL

I HEREBY CERTIFY THAT THIS PLAN WAS PREPARED BY ME OR UNDER MY DIRECT SUPERVISION AND THAT I AM A DULY LICENSED PROFESSIONAL ENGINEER UNDER THE LAWS OF THE STATE OF MINNESOTA.

Loren L. Fellbaum
 LOREN L. FELLBAUM

LIC. NO. 43144

01-10-25
 DATE

TODD COUNTY PUBLIC WORKS

C.P. NO. 25:86

ESTIMATED QUANTITIES & TYPICAL SECTION

SHEET NO.

2

SHEET 2 OF 2

2024

SALT Schedule of Materials Control



Contents

Introduction	3
Material Acceptance Summary Instructions	4
Material Acceptance Summary	5
Bituminous Quality Management	6-7
Bituminous Specialty Items	8
Cold Inplace Recycling (CIR), Stabilized Full Depth Reclamation (SFDR).....	9
Grading and Base Construction Items.....	10-13
Certified Ready-Mix Concrete	14-16
Concrete Plant and Field Materials	17
Concrete Pavement – Agency	18-19
Concrete Pavement – Producer/Contractor	20-21
Concrete Wearing Course for Bridges.....	22
Concrete Pavement Repair – CPR for 3U18	23
Dowel Bar Retrofit – (DBR).....	24
Landscaping and Erosion Control Items	25
Chemical Items	26
Metals.....	27-28
Geosynthetics, Pipe, Tile, Precast/ Prestressed Concrete	29
Electrical and Signal Equipment Items	30-31
Brick, Stone and Masonry Units	32
Miscellaneous Materials	33
Approved/Qualified Products & Resources	34
Contacts.....	35-37
Sample Sizes	38

Introduction

This Schedule of Materials Control (SMC) outlines the **MINIMUM** testing requirements for State Aid Funded and/or Federal Aid Projects **OFF** the National Highway and Trunk Highway System. Optional to this SMC is the MnDOT Materials Control Schedule. Usage of either schedule must be defined in the project proposal.

The SMC – LGA serves as a guide for material testing with allowable acceptance “as directed by the Engineer” detailed in Specification 1501.1(1) – Authority of the Engineer. These testing rates are a minimum and additional test may be taken at the Engineer’s discretion. A minimal testing rate does not always ensure a quality product; field observations and attention to detail is crucial. Materials not listed on an approved products list may be sampled and tested as directed by the Engineer. Materials listed on a Qualified Products list may be accepted or tested at the discretion of the Engineer.

Federal Aid projects require Independent Assurance Inspection. Contact the MnDOT District IA Inspector when the job starts to provide the proper servicing of your project.

*****Agencies using MnDOT Metro Inspection Services will be sampled at the current MnDOT Schedule of Materials Control rates and will be billed accordingly.**

*****Contact the MnDOT District IA Inspector to provide servicing for your federal aid project.**

Definitions

Schedule of Materials Control

Schedule of Materials Control (SMC) are inserted into project proposals to direct how materials are to be sampled and tested. The SMC is updated yearly. Each SMC is project specific. Therefore, one needs to refer to their specific proposal.

Approved/ Qualified Products List

Products are “approved” when they have been found to routinely meet all applicable standards and specifications. The product is placed on the list based upon established successful manufacturer’s quality control and warranties, but the listing may expire or require periodic renewal to verify the product has not changed over time. The approval process for the individual product should specify any expiration requirement. Testing may still be on at the Engineers discretion.

Certified Sources

Certified Sources must comply with each individual product’s defined “certification procedure”. Acceptance of products from certified sources follows the same sampling and testing as “approved/ qualified” products.

Quality control (QC): The activities performed by the **Contractor/Producer** that have to do with making sure the quality of a product or process meets the relevant contract requirements. All testing shall be performed by a certified tester.

Quality assurance (QA): The activities performed by the **Department/Agency** that have to do with making sure the quality of a product or process meets the relevant contract requirements. All testing shall be performed by a certified tester.

Verification Testing: Sampling and testing performed as called out herein to validate the quality of the product(s). **Part of QA.**

Bituminous Quality Management

The Contractor shall provide and maintain a quality control program as detailed in Specification 2360.2.G. The Engineer shall review the quality control program for compliance. This shall be provided at the precon.

	Type of Test	Spec Section (1)	Contractor / Producer – QC Testing Rates	Agency – QA Testing Rates
Start-Up Testing Rates for the 1 st 2000 tons (2)	Bulk Specific Gravity	2360.2.G.7.b	1 test per 500 tons 55 lb. sample 3 full cylinder molds (7)	(3) (10) 1 Verification Mixture Sample test per day, all Verification samples are from a split (QC/QA) sample.
	Maximum Specific Gravity	2360.2.G.7.c		
	Air Voids (calculated)	2360.2.G.7.d		
	Asphalt Content	2360.2.G.7.a		
	Adj. Asphalt Film Thickness (AFT)	2360.2.E.7.e		
	Gradation	2360.2.G.7.f		
	Fines to Effective Asphalt Ratio (calculated)	2360.2.G.7.a/f	1 test per 1000 tons (4) (5) (6) (7)	
	Coarse Aggregate Angularity (CAA)	2360.2.G.7.g		
	Fine Aggregate Angularity (FAA)	2360.2.G.7.h		
Added AC/Total AC Ratio (calculated)	2360.2.G.7.a			
Production Testing Rates	Bulk Specific Gravity	2360.2.G.7.b	1 test per 1000 tons 55 lb. sample 3 full cylinder molds (7)	(3) (10) Verification Mixture Sample test per day/ mix type, submit companion to the QC – CAA & FAA test results.
	Maximum Specific Gravity	2360.2.G.7.c		
	Air Voids (calculated)	2360.2.G.7.d		
	Asphalt Content	2360.2.G.7.a		
	Adj. Asphalt Film Thickness (AFT)	2360.2.E.7.e		
	Gradation (minimum of 1 per day)	2360.2.G.7.f		
	Added AC/Total AC Ratio (calculated)	2360.2.G.7.a		
	Coarse Aggregate Angularity (CAA)	2360.2.G.7.g		
	Fine Aggregate Angularity (FAA)	2360.2.G.7.h	(4) (6) (7)	
	TSR	2360.2.G.7.i	When directed by the Engineer	
	Aggregate Specific Gravity	2360.2.G.7.j		
	Mixture Moisture Content	2360.2.G.7.k	As directed by the Engineer	
	Asphalt Binder (QA ONLY)	2360	(8) 1 qt. steel container for asphalt binder	
	Asphalt Emulsion (QA ONLY)	2357	(9) ½ gal plastic container for asphalt emulsion. (Tack)	
	Compaction / Density Requirements	2360.3.D	Review special provisions	
Small Quantity Requirements	< 500 tons per project may be accepted by the Engineer without testing.			

NOTES: Testing rates are minimum rates; additional testing is encouraged to ensure a quality product.

(1) Review Special Provisions & 2360.2G Mixture Quality Management.

(2) The testing rates apply only to mixtures that have not been tested on previous projects in the current year.

(3) The Agency shall witness a minimum of 1 (one) complete QC mixture sampling, splitting and test per day.

The Agency shall take possession of all split QA samples immediately. The Agency shall randomly submit one QA split sample to the District Lab for Verification testing and inform with contractor the following day of test number. Additional verification samples can be taken at any time or location. When additional verification samples are taken, the contractor must test the Verification Companion split of this sample and include the results in the QC program.

(4) The Contractor will retain the extracted gradation samples in containers with field identification numbers for a period of 10 calendar days. The Engineer will identify which extracted gradation sample is the Verification Companion Sample and whether it is to be tested for coarse and fine aggregate angularity.

- (5) At start-up or new Mix Design:** 2 tests/ day for a minimum of 2 days, then 1/day if CAA is met. If CAA > 8% of requirement, 1 sample/ day but test 1/ week. No testing required for Class A and B Aggregates.
- (6) At start-up or new Mix Design:** 2 tests per day for a minimum of 2 days, then 1/day if FAA is met. If FAA > 5% of requirement, 1 sample/ day but test 1/week.
- (7)** Random number generation and determination of random sample location shall be consistent with Section 5 of ASTM D3665. The Engineer may approve alternate methods of random number generation.
- (8) During Asphalt Mixture Production (Field Verification):** Shall be from a certified supplier. Obtain asphalt binder samples from a sampling valve located between the pump and the drum. Contractor personnel shall obtain samples, under the observation of a department representative, by random selection from shipments of material at the project site. The samples shall be taken from the first load and subsequently 1 per 1000 tons of liquid asphalt binder for each supplier and grade of asphalt binder per contract. For contracts with less than approximately 25 tons (one truck transport) of asphalt binder, sampling may be waived. A minimum of 1 gallon of binder must be drawn and wasted from the sampling valve before the actual sample is drawn. Sample shall be sent in for verification testing.
- (9) During Mixture Production (Field Verification):** Shall be from a certified supplier. The Contractor shall sample first shipment, then submit 1 per 50,000 gallons. Sample emulsified asphalt in clean ½ gallon plastic container with wide screw top and send to MnDOT Chemical Lab within 7 days of sampling. Sample all emulsified asphalt from the distributor. Sample shall be sent in for verification testing. No Samples required unless directed by the Engineer.
- (10)** Conduct random belt samples and test for aggregate quality as directed by the Engineer.

Bituminous Specialty Items

Type of Test	Spec	Contractor/Producer – QC Testing Rates	Agency- QA Testing Rates
Gradation	2363	1 per 1,000 Ton with a minimum 1 per day.	1 per day. 35 lbs.
PASSRC & PASB	3139.3		
Micro-Surfacing	2354 3139.5	Stockpile: 1/1,500 Tons (min 1/day) Machine Hopper: 1/500 Ton (min 1/day)	Machine Hopper: 1/day, 30 lbs.
Seal Coat, Underseal & Otta Seal	2356 3137.2B	Stockpile: 1/1,500 Tons (min 1/day) Chip Spreader Hopper: 1/day	1/day from Hopper. 30 lbs.
% Crushing – CAA	2363	1 per 1,000 Ton with a minimum 1 per day.	1 per day from gradation test. 35 lbs.
PASSRC & PASB	3139.3		
Moisture / Aggregate	2354	Machine Hopper: 1/500 Tons (min 3/day)	1/day 2lbs
Micro-Surfacing	3139.5		
Sand Equivalence	2354	1/day	Test at Engineer discretion, 25 lbs.
Micro-Surfacing			
Flakiness Index		Sample taken from first load on first day, submit to Agency: 30 lbs.	Agency will test at their discretion, see Lab Manual 1223
Bituminous Seal Coat & Bituminous Underseal	2356		
Bituminous Mixture	2353	1/500 Tons, min 1/day. %AC, Gradation, Max SpG, Adj.AFT	1/day, 20 lbs. 1 cylinder from truck box.
UTBWC	3151.2G		
PASSRC & PASB	3151 2363	Asphalt spot check: min 1/day	-
Stone Matrix Asphalt – SMA Lab Manual 1203, 1204, 1205, 1211, 1214, 1806, 1807, 1808, 1813, 1853, 1854, 1855, AI SP-2 AASHTO T305	2365	Tests, %AC, gradation, Gmm, Gmb, Voids, VMA, CAA, Draindown, VCA, fines/effective asphalt. Rate, (1/1000 tons, min.1/day) Agg SpG, mix moisture, TSR to be tested as directed by Engineer. Submit companion 1 per day to agency: 3 full 6" by 12" cylinders	Tests: %AC, Gradation, Gmm, Gmb, Voids, VMA, CAA, VCA, fines/effective asphalt. Agency is not required to do drain down. Copy MDR to Project Engineer and Grading & Base Engineer.
Asphalt Binder Tests		Asphalt Emulsion List	Asphalt Binder List
UTBWC	2353 3151	Asphalt Binder: Sample first load, then 1/250,000 gallons. Sample size of 1 quart metal container. Emulsified Asphalt: Sample first load, then 1/50,000 gallons. Sample size of ½ gallon wide screw top plastic container.	
Micro-Surfacing	2354		
Seal Coat, Underseal & Otta Seal	2356		
Tack Coat	2357		
PASSRC & PASB	3151		
Asphalt Binder Rate		Verify Application Rate 3/day	Verify Application Rate 1/day
Micro-Surfacing	2354		
Fog Seal	2355	Verify Application Rate 1/day	Verify Application Rate 1/day
Seal Coat, Underseal & Otta Seal	2356		
Bit Tack Coat	2357		

Specification 2215 – Cold Inplace Recycling (CIR), Stabilized Full Depth Reclamation (SFDR) and Cold Central Plant Recycling Bituminous (CCPR)

Test Type	Contractor/Producer QC Testing Rates	Agency QA Testing Rates	Grading & Base Manual/Form
Gradation SFDR (Simple) Pre-ground un-stabilized material	1 per mile – report sieves 2" & 3"	Run gradation at the discretion of the Engineer	.215 / 101 report sieve 2" & 3"
Gradation (Entire) (Material to be stabilized)	One per day, give split sample to the Engineer	Run gradation at the discretion of the Engineer	.215 / 101 report sieve 2", 1.5", 1.25", 1", ¾", 3/8", #4, #10, #30.
Gradation (Simple) (Material to be stabilized)	1 per mile for SFDR & CIR. 1 per 2,000 ton for CCPR.	Run gradation at the discretion of the Engineer	.215 & .293 / 101 report sieve 2" & 1.5" for SFDR, 1.5" and 1.25" for CIR
CIR & SFDR Depth Check – Unstabilized and Stabilized	None	1 per day	.284 / 401
SFDR & CCPR Moisture – before injecting with bituminous.	1 per mile of anticipated daily production and after rain. 1 per mile for SFDR after mechanical drying.	Run moisture at the discretion of the Engineer	.245 Speedy tester not allowed.
Penetration Index (DCP) – SFDR only Unstabilized.	2 per mile	1 per mile	.255 / 205
Calibrate: mineral stabilizing agent application rate.	Once using design rate per vane feeder.	Observe contractor calibration	.286 or .287
Moisture: before injecting liquid bituminous material	1 per mile of daily anticipated SFDR & one after rain or mechanical drying out (disking, etc.).	none	.281 / 105
Yield: Mineral Stabilizing Agent and/or Liquid Bituminous Material	1 per transport load each type	1 per day each type	.286 & .287 / 402 & 403
Compaction: Nuclear density for SFDR stabilized and CIR	10 per lane mile, (see note below).	Observe the Contractor.	.282
Control Strip: SFDR Stabilized and CIR	Minimum of once per project	Observe the Contractor.	
Bituminous Material Samples		. 1 per 50,000 gallons; sample first load	1 quart each sample
Mineral Stabilizing Agent Samples	None	1 sample	none
Foaming asphalt checks expansion ratio & half life	1 per load	Observe the Contractor.	.285
Moisture (stabilized) – before placement of next layer during curing.	2 per day until moisture stabilizes & placement of HMA.	None	Grading & Base Manual

Note: The Engineer may require a Contractor to perform additional nuclear density tests in areas that the Engineer believes are failing density requirements.

Grading and Base Construction Items (1 of 4)

		Material Type	Spec.	Contractor / Producer QC Testing Rates	Minimum Required Agency QA Testing Rates	Verification Testing Sample
Gradation Testing (2) (3)		Aggregate Surfacing	3138	1 / 1,000 CY (CV) stockpile gradation only required for material on hand.	> 250 yd ³ (CV) or 500 Tons and < 2000 yd ³ (CV) or 4000 tons. Material is a minimum of one lot (5). Test two random samples from each lot and average. > 2000 yd ³ (CV) or 4000 Tons. Divide into lots with lot size (5) no greater than 2000 yd ³ (CV) or 4000 Tons. Test two random samples from each lot and average.	1/source 30 lb.
		Aggregate Base	3138			
		Shoulder Base Aggregate	3138			
		Drainable Aggregate Base (OGAB & DSB)	3136			
		Granular and Select Granular Material (borrow/embankment)	3149.2B	1/10,000 CY (CV) only required for material on hand.	1/40,000 yd ³ (CV)	1/source 30 lb.
		Stabilizing Aggregate	3149.2C			
		Reclamation FDR	3135.2B	None	Test at Engineer's discretion. Inspect for oversize chunks (+3"), after the motor grader has overturned the material	None
		Granular Filter	3601.2B	1/source – before delivery on the project. Only required for materials on hand. Spec 1906.2	1/ source	1/source 30 lb.
		Backfill Materials	3149.2D			
		Granular Bedding	3149.2F			
		Aggregate Bedding	3149.2G			
		Coarse Filter Agg.	3149.2H			
		Filter Aggregate	3149.2J			
		Sand Cover	3149.2K			
Proctor	Specified Density *	Non-Granular Material Used to determine optimum moisture & maximum density.	2106 3149	None	1 per major soil, subgrade prep specified density requires 100% of proctor density.	1 sample 25 lb.
Sand Cone, Nuclear Density or LWD		Non-Granular Material For non-granular material, i.e., material that does not meet 3149.2B.1		<p>AGENCY TESTING: Roadway Embankment: One test per 4,000 yd³ (CV) <u>or if test rolled, One test per 10,000 yd³ (CV)</u></p> <p>Transverse culverts & abutments: 1 test per every 2 feet of fill.</p> <p>Structures and Longitudinal Trenches: One test per 300 feet of each structure per 2 feet per fill.</p> <p>Sidewalks and Trails: 1 per 500 feet.</p> <p>Subgrade Preparation: One per 25 road stations.</p>		

Grading and Base Construction Items (2 of 4)

Material Type		Spec.	Contractor / Producer QC Testing Rates	Minimum Required Agency QA Testing Rates	Verification Testing Sample
Penetration Index Method (DCP) or LWD *	Aggregate Base	3138 2211.3C	None	1 DCP tests per 500 yd ³ (CV) or 1 per 1000 Tons. If test rolled, 1 test / 1,500 yd3 (CV) or 3000 Tons.	None
	Shoulder Base Aggregate				
	Reclamation FDR	3135.2B 2215.2C		1 DCP test per 3,000 yd ² . If test rolled, 1 test / 10,000 yd ²	
	Walks & Trails	2521		1 per 500 feet of Sidewalk or Trail	
	Granular Materials Subgrade Preparation (for materials meeting 3149.2B1)	3149.2B	AGENCY TESTING: Roadway Embankment: One test per 2,000 yd3 (CV) <u>or if test rolled, One test per 6,000 yd3 (CV)</u> Transverse culverts & abutments: 1 test per every 2 feet of fill. Structures and Longitudinal Trenches: One test per 300 feet of each structure per 2 feet per fill. Sidewalks and Trails: 1 per 500 feet. Subgrade Preparation: One per 25 road stations.		
Moisture Content Test During All Compaction Methods (4)	Aggregate Base, Shoulder, Surfacing & Walks	3138	None	For 2118, 2211,2221, and 2521: 1 / 1,000 yd3 up to 10 Maximum	None
	Drainable Aggregate Base (OGAB & DSB)			For 2451: 1 per structure, for multiple adjacent structures, may test once, use judgement For Quality Compaction: Test as directed by Engineer.	
	Reclamation FDR	3135.2B	None	1 / 20,000 yd ²	
	All Embankment Materials	2106 3149	None	1/10,000 yd3 up to 10 Maximum For Quality Compaction: Test as directed by Engineer.	
	Subgrade Preparation	2106 3149		1 per 25 road stations For Quality Compaction: Test as directed by Engineer.	
Percent Crushing	Particle Count (1)	1906.2	1 required for Material on hand	1/source unless directed by Engineer, (required for 3138.2B & C, 3149.2C & G1, 3136.2B).	1 / source
Quality	Aggregate Quality Tests	3138 3149 3601	1 required for material on hand, Spec 1906.2	1/ source unless directed by Engineer	1 / source 30lb
Depth Check	Reclamation FDR	3135.2B	1/Mile.	1 per day unless directed by Engineer	

Material Type	Spec.	Contractor / Producer QC Testing Rates	Minimum Required Agency QA Testing Rates	Verification Testing Sample
Test Rolling	Test Rolling (as directed in the special provisions)	2111	As directed by the Engineer the contractor will perform test rolling at the top of all <ul style="list-style-type: none"> Subgrade Base layers (2211) Non-Stabilized FDR (2215) Granular layers not meeting the requirements of 3149.2B2 (2106) Minimum 12' width and 300' length. Agency to observe test rolling. 	

Verification Testing Samples are companion split samples to the QA sample:

- Companion gradation, proctor, QA crushing, aggregate quality samples not required 1,000 tons or less.
- Include the laboratory companion with the first field sample.
- Include the field sample results with the laboratory sample.
- Laboratories with AMRL Accreditation are not required to submit laboratory companion samples.
- Carbonate aggregate materials require 50 lb. samples for the laboratory testing.

NOTES:

(1) Percent crushing test is not required when the material is crushed from a quarry or contains 25% or greater recycled materials.

(2) Submit a laboratory companion to the first Acceptance Gradation sample for a bituminous extraction, see 3138.2C. Full Depth Reclamation samples are not required.

(3) The Certification of Aggregates and Granular Materials procedure and documentation of testing locations is at the discretion of the Engineer.

(4) For quality compaction per spec 2106.3G.2, test at Engineer's discretion.

(5) Lot sizes may be adjusted by the Engineer. This may be good practice if parts of the project are taking place in separate areas or at separate times, such as many turn lane or excavation areas or separate project stages.

* Review the Special Provisions. The Grading and Base Manual allows the nuclear density gauge, see pages 60 and 65.

NOTES:

Conversions: 1 ton = 0.55 yd³ (CV), 1 ton = 0.7 yd³ (LV), 1 yd³ (CV) = 1.8 tons.

Contact the MnDOT District IA Inspector to provide servicing of your Federal Aid Project.

Less than 500 tons (250 CY) may be accepted by the Engineer without testing.

Grading and Base Construction Items (4 of 4)

Guidelines for Required Crushing & Aggregate Quality Tests

	3149 Granular Materials	3138 Aggregate for Surface and Base	3136 Drainable Bases
Crushing	Yes, for Stabilizing Aggregate, Fine Aggregate Bedding and Medium Filter Aggregate. Test waived if material contains recycled at twice the minimum crushing requirement. Not required for quarried sources.	Yes, for Class 5, 5Q & 6. Test waived if material contains recycled at twice the minimum crushing requirement. Not required for quarried sources. Class 2 must contain 100% crushed quarry rock.	Yes. Not required for quarried sources.
Bitumen Content	At the discretion of the Engineer	At the discretion of the Engineer	Not applicable
LAR	Not applicable	Yes, if source is carbonate quarry and does not contain bitumen.	Yes
Insoluble Residue	Yes, if source is carbonate quarry and does not contain bitumen.	Yes, if source is carbonate quarry and does not contain bitumen.	Yes, if source is carbonate quarry.
Litho Exam & Shale Float Test	Yes, for Medium Filter Aggregate	Yes, for Class 3, 4, 5, 5Q & 6, when not from quarried rock, and does not contain bitumen.	Yes, when not from a quarried source.

Testing procedures in the Grading & Base Manual.

Forms and worksheets at the Grading & Base website.

Gradation worksheets at the SALT Construction website.

****MAKE SURE TO FILL OUT THE REQUIRED PRELIMINARY AND FINAL GRADING AND BASE REPORTS AND SUBMIT TO PROJECT ENGINEER.****

http://www.dot.state.mn.us/materials/gradingandbasedocs/Forms/form001_08_043019.xlsx

Certified Ready-Mix Concrete (1 of 3)

The Prime Contractor is responsible to assure that all ready-mix concrete used is produced by an annually Certified Ready-Mix plant as detailed in Specification 2461.3F.

Material Spec.	Test Type (Concrete Manual)	Contractor / Producer QC Testing Rates				Form
bridge 2406.2 2411.2 2461.2 2461.3 general 2301** 2452.2 2461.2 2461.3 2506.2 2511.2 2514.2 2520.2 2521.2 2531.2 2533.2 2545.2 2554.2 2557.2 2564.2 2565.2	Gradation (5-694.145) (5-694.148) 3126, 3131, 3137	For all JMF's & Bridge Deck Mix Designs Daily Concrete Quantity: 1 per fraction per source per day between 20 – 400 yd³. If over 400 yd³ per day, take a second gradation after the DAILY total exceeds 400 yd³. Bridge Deck Concrete must have passing gradations prior to mixing.				Concrete Agg. Work sheet, Agg. Grad. Control Charts, R-M Plant QC workbook, R-M Plant QA Workbook
		For all other mix designs, Weekly Concrete Quantity: 1 per fraction per source per week between 20 – 400 yd³. If over 400 yd³ produced per week, take a second gradation after the WEEKLY total exceeds 400yd³.				
		Department Plant Monitor Testing Rates: Verification only Verification Sample: When weekly concrete quantity is ≥ 20 yd³: 1 per fraction per source per week, split and tested by both Agency and Contractor				
	Moisture Content (5-694.142)	QC rates:	1 every 4 hours When Daily Concrete Quantity ≥ 20 yd³	QA rates:	None	
	Test Type	Agency QA Testing Rates (1)				
	Aggregate Quality (5-694.146)	Minimum of 1 per each fraction - use of MnDOT test results for the same 30-day time period is acceptable. For all bridge deck concrete poured during the month: Test monthly quality to 3137.2D2 for each coarse aggregate fraction. Designate 3137.2D2 on the sample card. Gradation results will be included with the monthly quality tests.				
	Coarse Aggregate (% Passing 200) (5-694.146)					
	Minimum Aggregate Sample Size All Aggregate Gradation and Quality samples require companions, double sample size					
	Aggregate Size	Gradation	Quality	Moisture	% -200 Course.Agg.	
	3/4" Plus, #4	30 lb.	50 lb.	2000 g	5000 g	
	3/4" Minus, #67	10 lb.	30 lb.	2000 g	2500 g	
	#7, CA-70	6 lb.	20 lb.	2000 g	2500 g	
	CIA to meet #67	6 lb.	20 lb.	500 g	500 g	
	CIA to meet JMF, FIA, CS, FS	500 g	20 lb.	500 g	500 g	
	CA-80, #89	1.1 lb. (500 g)	20 lb.	500 g	500 g	
	Fine Aggregate	1.1 lb. (500 g)	20 lb.	500 g	-	

Concrete Plant Production Testing Rates *

2410 Sample ID Card

Certified Ready-Mix Concrete (2 of 3)

Spec.		Test Type	Agency QA Testing Rates (1)	Form
bridge 2406.2 2411.2 2461.2 2461.3	Concrete Field-Testing Rates	<u>Sampling Locations for Air, Slump (when required), Temperature and Cylinder Testing</u> First load each day per mix - Take sample after discharging approximately 1/4 yd ³ , stop further discharge until both slump and air content test are completed. The first load of concrete <u>must have passing air content and slump prior to placement</u> . Cast strength specimens from the same load as the air content and slump test. Test whenever adjustments are made to the mix. Take all tests at the point of placement. Subsequent tests - Sample from the middle portion of the load.		
		Air Content - Type 3 Concrete (5-694.541)	1 test per 100 yd ³ . Test first load each day per mix. Test when adjustments are made to the mix.	
		Slump (5-694.531)	Test first load each day per mix, then as necessary to verify passing slump. For Bridge Concrete: 1 test per 100 yd ³ . No testing required for slip form placement.	
		Air and Concrete Temperature (5-694.550)	Record temperature each time air content, slump or compressive strength specimen is performed/fabricated.	
general 2301** 2452.2 2461.2 2461.3 2506.2 2511.2 2514.2 2520.2 2521.2 2531.2 2533.2 2545.2 2554.2 2557.2 2564.2 2565.2		Compressive Strength (5-694.511) Standard cylinder size is 4 x 8, use 6 x 12 with aggregate greater than 1 1/4". Review 2461.3G.5 Test Methods and Specimens.	<u>General Concrete Grades F, G, M, P, and R</u> : 1 set of 3 cylinders per 300 yd ³ per mix per day.	2409 Concrete Cylinder ID Card
			<u>Bridge Concrete Grades B, S, and Y</u> : 1 set of 3 cylinders per 100 yd ³ , then 1 set of 3 cylinders per 300 yd ³ per mix per day	
			Agency will break 1 set of 3 cylinders at 28 days. Agency will cast up to 3 control cylinders, any additional control cylinders are the responsibility of the Contractor.	
			Cellular Concrete: 1 set of 4 cylinders (28 days) per day, fill in 2 equal lifts, <u>do not rod</u> , lightly tap the sides, cover and move to area with no vibration. Do not disturb for 24 hours.	

NOTES:

(1) Review the requirements of 2461.3F Certified Ready-Mix Concrete, 2461.3G Concrete Placement and 5-694.010 Inspector's Checklist in the Concrete Manual.

*Small Quantity Requirements are for less than 20 yd³ per day, Plant Monitoring is not required but Concrete Field Testing is required.

**Concrete Pavement: Use Certified Ready-Mix Concrete testing rates when: a) The entire concrete paving project is less than 3,500 cu. yd. b) When a secondary plant is used to provide minor work.

Certified Ready-Mix Concrete (3 of 3)

The Prime Contractor is responsible to assure that all ready-mix concrete used is produced by an annually Certified Ready-Mix plant as detailed in Specification 2461.3F.

Guidelines

- The testing rates shown in this Schedule of Materials Control are minimums. Take as many tests as necessary to ensure quality concrete. Should circumstances arise on a project which makes the testing rate impractical, contact the Concrete Engineering Unit.
- All samples shall be taken in a random manner using an appropriate number generator.
- The first load of concrete for any pour must have passing air content and slump results, prior to placing.
- If batching or field adjustments are made, test the adjusted load for air content and if suspect, slump, before it gets into the work. The Engineer will determine if additional testing is required after each water adjustment made during slip form placement. Continue to test for air content and slump, if suspect, when test results are inconsistent or marginal.
- If any field test fails, reject the concrete or if the Producer adjusts the load to meet requirements, record the adjustments on the Certificate of Compliance. Retest the air content of the load, slump if required, and record the adjusted test results. Test the next load for air content and slump, if required, before it gets into the work.
- Material not meeting requirements shall not knowingly be placed in the work. If failing concrete inadvertently gets placed in the work, review either the MnDOT Standard Specifications for Construction or contact the Concrete Engineering Unit for monetary deduction recommendations.

Best practices

- It is recommended that the Agency Plant Monitor be present during critical pours, such as superstructure or paving concrete (i.e., 3A21, S mixes, JMF mixes).
- It is recommended that the Agency representative continually monitor the progress of all concrete pours in the field and review Certificate of Compliances. It is not a recommended practice to only perform minimum testing requirements and leave the pour.
- It is recommended to make standard strength cylinders after the first load of concrete unless that is the only load of concrete for that mix that day.
- The Agency is responsible for verification sampling. For safety and consistency in sampling and splitting of the sample, it is recommended that the agency and the producer/contractor obtain the verification sample in tandem. This will allow the producer/contractor to witness the sampling process and take possession of the verification companion.

Concrete Plant and Field Materials

All materials must come from certified or qualified sources. All certified sources must state so on the delivery invoices. The most current list of certified/approved sources can be found at MnDOT Material website. Materials listed on the Approved/Certified Products List are not required to be sampled but need to be listed on the Material Acceptance Summary detailed in the SALT SMC. Samples can be submitted as directed by the Engineer.

Concrete Plant Batching Materials	Material	Spec. No.	Agency QA Field Sampling Rate	Form No.
	Portland Cement	3101	Shall be a Certified Supplier - For certified ready-mix and concrete paving sample rates: 1 sample when the plant is certified. Take additional samples if the plant changes sources or as the contract requires. The producer obtains a 5 lb. sample and stores the sample in a sealed container provided by the Agency and includes the supplier's delivery invoice from which the sample is obtained.	24300 ID Card Cement Samples
	Slag	3102		
	Blended Cement	3103		
	Fly Ash	3115		24308 Fly Ash
	Admixtures (Acceleration, Retarding, Water-Reducing, Air-Entraining, etc.)	3113	For all concrete: 1 sample of Air Entrainment and Type A Water Reducer in a 1/2-pint plastic container provided by the Agency when the plant is certified. Take additional samples if the plant changes sources or as the contract requires. The Producer should agitate the admixture tank prior to obtaining samples from dispensing tubes and store the samples in sealed plastic containers provided by the Agency.	2410 Sample ID Card
	Water	3906	1 Non-Potable Water sample in a 1-gallon clean glass or plastic container from a questionable source. Clarified Water: 1 per month during Department production	
Concrete Field Materials	Preformed Joint Filler	3702	Visual Inspection	2410 Sample ID Card
	Preformed Elastomeric Type	3721	1 per lot. Only materials from a qualified source. Link to Approved Products List.	
	Silicone Joint Sealer	3722		
	Hot Poured Elastomeric Type	3723 3725		
	Burlap	3751	Visual Inspection	
	Colored Concrete Membrane Curing Compound	3752	Visual Inspection - Use only from qualified source.	
	Membrane Curing Compound	3753 3754 3755	Visual Inspection - Use only pre-approved curing compounds.	
	Plastic	3756	Visual Inspection - Must be white opaque and free from holes.	
Refer to the "Metals" schedule for sampling requirements for concrete reinforcement.				

Concrete Pavement – Agency (1 of 2)

Test Type (concrete manual)	Spec.	Concrete Paving Batch Plant Agency QA Testing	Certified Ready-Mix Plant Agency QA Testing	Form
Gradation (1) (5-694.145) (5-694.148)	3126 3131 3137	Daily Concrete Quantity ≥ 500 Agency QA Testing Rates: Verification only Verification Sample: -, *1 per fraction per source per day, split and tested by both Agency and Contractor	Daily Concrete Quantity ≥ 100 yd3 Agency QA Testing Rates: Verification only Verification Sample: -, *1 per fraction per source per week, split and tested by both Agency and Contractor	JMF Concrete Aggregate Workbook
Aggregate Moisture - QC Verification (2) (5-694.142)	2301	If w/c incentives apply: 1 per 1000 yd3 or every 4 hours, whichever is greater. Take initial sample within the first 250 yd3.	If w/c incentives apply: 1 per 200 yd3 or every 4 hours, whichever is greater. Take initial sample within the first 100 yd3.	Concrete W/C Ratio Work sheet
Water Content, Microwave Oven Verification (3) (5-694.532)	2301	Take initial sample within the first 250 yd3. At least one additional verification test should be taken if more than 1000 yd3 is produced in a day.	Take initial sample within the first 100 yd3. At least one additional verification test should be taken if more than 400 yd3 is produced in a day.	
Coarse Aggregate, -200 sieve (5-694.146)	3131 3137	Test Verification sample on the first day of production and each time the Contractor mobilizes the plant, changes the aggregate sources, or the cleanliness of the coarse aggregate is in question, then 1 per week randomly thereafter. -200 test may be performed at the lab instead at the plant at the discretion of the Engineer.		JMF Concrete Aggregate Workbook
Coarse and Fine Aggregate Quality (4)	3126 3131 3137	During concrete production: 1 randomly selected test each fraction every 20,000 yd3 of production. Split the Quality sample 4 ways: 1) Provide 2 quarters of the sample to the producer/contractor. 2) Submit the remaining sample to the lab for quality testing including testing the -200 sieve on the coarse aggregate.		2410 Sample ID Card
Alkali Silica Reactivity (ASR) Testing	2301	1 per paving project per sand source. Provide one 5 lb. sample of: cement, supplementary cementitious material (fly ash or slag), and sand. Write "Project Specific ASR Testing" on all 3 sample cards. ASR Testing is not required if the entire project is less than 3,500 cubic yards.		2410 24300 24308
Coarse Aggregate Quality Testing of Incentive / Disincentive	3137	If coarse aggregate quality incentives apply: Test the Class B aggregates for % absorption and Class C aggregates for % carbonate including any other test necessary to make those determinations. Sample the 2 largest fractions in accordance with the following table and 2301:		Coarse Agg Quality Incentive / Disincentive Work sheet 2410 Sample ID Card
		Coarse Aggregate Quality Incentive/Disincentive Sampling Rates		
		Plan Concrete Cubic Yards	Samples per fraction	
		3,500 - 7,500	3	
		7,501 - 10,000	5	
		10,001 - 25,000	10	
		25,001 - 50,000	15	
50,001 +	20			

*Use Certified Ready-Mix Concrete testing rates when: a) The entire concrete paving project is less than 3,500 cu. yd. b) When a secondary plant is used to provide minor work.

Concrete Pavement – Agency (2 of 2)

Test Type	Spec.	Concrete Field Testing - Agency QA Testing	Form
Air Content before consolidation	Review Concrete Manual Website	1 correlation air test per day	2162 Test Beam Data
Concrete Temperature		Record temperature each time air content, slump or strength test specimen is performed/fabricated by the Agency.	
Flexural Strength		Supply beam boxes or cylinder molds. Cure and test beams and cylinders MnDOT standard beam box size is 6" x 6" x 20" unless others are approved by the Concrete Engineer.	
Opening to Traffic Strength		Supply beam boxes or cylinder molds for field control testing. Cure and test beams and cylinders.	
Concrete Pavement Texture		Determine texture testing locations using random numbers. Observe Contractor Testing when possible.	Probing, Coring, Texture and MIT-Scan T2 Report
Thickness		Determine probing and coring locations using random numbers. Initial pavement at core locations and re-initial the sides of specimens after coring to clearly verify their authenticity. Field measure cores to the nearest 1/8". Transport to the MnDOT Office of Materials and Road Research for final thickness determination	
Surface Smoothness/ Dowel and Tie Bar Steel Location		Observe Contractor Testing when possible	

NOTES:

(1) All gradation samples shall be taken in the presence of the Agency, unless otherwise authorized by the Engineer. All samples shall be taken off the belt leading to the weigh hopper unless otherwise approved by the Engineer. **All gradations and quality tests require companion samples.** If Coarse Aggregate Quality Incentive / Disincentives apply: The Agency may also use the QA samples for incentive / disincentive testing. Notify the Contractor/Producer to double the QC/QA sample size. If well-graded aggregate incentives apply: Use the Contractor's gradation results for well-graded aggregate incentive calculations as verified by Agency testing. Use the Well-graded Concrete Agg. Worksheet.

(2) If w/c incentives apply: Use aggregate moisture results for determining the water content to calculate the w/c incentive/disincentive. Use the Concrete W/C Ratio Calculation Worksheet and do not leave sample unattended. Microwave oven verification testing to verify the w/c ratio is completed in conjunction with Agency aggregate moisture testing. Do not leave samples unattended.

(3) If w/c incentives apply: Microwave oven verification testing to verify the w/c ratio is completed in conjunction with Agency aggregate moisture testing. Do not leave samples unattended.

(4) Prior to concrete production: Obtain pre-production samples for quality testing at least 16 hours prior to concrete production. Samples may be taken from the stockpile and -200 test may be performed at the lab instead at the plant at the discretion of the Engineer. If the entire project is <3,500 yd³, pre-production sampling is not required.

Minimum Aggregate Sample Size				
*companion required, double sample				
Aggregate Size	Gradation*	Quality*	Moisture	% -200 C. Agg.
3/4" Plus, #4	30 lb.	50 lb.	2000 g	5000 g
3/4" Minus, #67	10 lb.	30 lb.	2000 g	2500 g
#7, CA-70	6 lb.	20 lb.	2000 g	2500 g
CIA to meet #67	6 lb.	20 lb.	500 g	500 g
CIA to meet JMF	500 g	20 lb.	500 g	500 g
FIA, CS, FS	500 g	20 lb.	500 g	-
CA-80, #89	500 g	20 lb.	500 g	500 g
Fine Aggregate	500 g	20 lb.	500 g	-

Concrete Pavement – Producer/Contractor (1 of 2)

Test Type (concrete manual)	Spec.	Concrete Paving Batch Plant Contractor/Producer QC Testing	Certified Ready-Mix Plant Contractor/Producer QC Testing
Gradation (1) (5-694.145) (5-694.148)	3126 3131 3137	When > 250 yd ³ produced/ day: 1 per 2500 yd ³ per fraction per source. Take initial samples for aggregate gradation testing within the first 500 yd ³ . Test the verification companion sample on the day the sample was taken.	When 20-400yd ³ produced/ day: 1 per fraction per source. If over 400 yd ³ per day, take a second gradation after the total exceeds 400 yd ³ . Test the verification companion sample on the day the sample was taken.
Coarse Aggregate -200 sieve (5-694.146)	3131 3137	Test the verification companion sample. Test these samples at the plant.	
Aggregate Moisture QC Verification (2) (5-694.142)	2301	If w/c incentives do not apply: 1 per 1000 yd ³ , or 1 completed every 4 hours, whichever is the higher sampling rate.	If w/c incentives do not apply: 1 completed every 4 hours.
Water Content, Microwave Oven Verification	<u>Review Concrete Manual 2301</u>	If w/c incentives apply: Obtain the plastic concrete sample at the plant. See Concrete Manual (5-694.532)	
Unit Weight QC		Test one load of concrete per day at the plant. See Concrete Manual (5-694.542)	
Air Content QC (5-694.541)		Test the first load of concrete at the plant	
Coarse Aggregate Quality	3126 3131 3137	Test at Producer/Contractor Discretion	
Unit Weight		Test 1 load of concrete per day at the plant.	
Air Content for Type 3 Concrete (QC)		Test the first load of concrete at the plant.	
Coarse Aggregate Quality Testing for Incentive / Disincentive	3137	Test at the Contractor's discretion.	

* Use Certified Ready-Mix Concrete testing rates when: a) The entire concrete paving project is less than 3,500 cu. yd. b) When a secondary plant is used to provide minor work.

Concrete Pavement – Producer/Contractor (2 of 2)

NOTES:

(1) Performing testing on representative material at the end of the most recent day of production is allowed. If well-graded aggregate incentives apply: Use the Contractor's gradation results for well-graded aggregate incentive calculations as verified by Agency testing. Washing the fine aggregate gradation (QC) sample is not required when the result on the -#200 sieve of the unwashed sample is less than 1.0%. Wash all fine aggregate Verification Companion samples.

(2) Complete the initial moisture content and adjust the batch water prior to the start of concrete production each day. If weather conditions allow, performing moisture testing on representative material at the end of production the prior evening is allowed. Enter results into the batching system in real time.

Test Type	Spec.	Concrete Field Testing - Contractor QC Testing
Air Content before consolidation for Type 3 concrete	<u>Review Concrete Manual Website</u>	1 per 300 yd ³ or 1 per hour, whichever is less. Test first load each day per mix.
Slump		Test slump if concrete is suspected to be outside of required slump range as directed by the Engineer.
Concrete Temperature		Record temperature each time air content, slump or strength test specimen is performed/fabricated by the Contractor.
Flexural Strength		For information only: 1 beam (28-day) per week per mix. 1 cylinder (28-day) per week per mix may be substituted at the discretion of the Engineer. Provide moist curing environments, fabricate beams or cylinders, deliver to curing site, and clean beam boxes
Opening to Traffic		For opening to traffic: Make field control beams within the last hour of concrete poured each day. Substitute field control cylinders for field control beams at the discretion of the Engineer. Maturity testing is allowed in lieu of field control cylinders or beams. Fabricate beams or cylinders, deliver to curing site, and clean beam boxes.
Concrete Pavement Texture		Perform texture testing at locations determined by the Engineer in accordance with the Contract
Thickness		Probe, scan and core at locations determined by the Engineer in accordance with the Contract
Surface Smoothness		Measure smoothness of the final concrete as required by the Contract. Perform all profiling in the presence of the Engineer unless otherwise approved by the Engineer.
Dowel Bar and Tie Bar Steel Location		For Concrete projects greater than 3500 yd ³ . On the first day and each day of slip form pavement: (1) Verify the adequacy of the dowel bar anchoring by scanning seven random doweled contraction joints in each subplot. (2) Verify the presence and alignment of tie bar steel by scanning 75 lin. Ft. in each subplot. If the Engineer determines the first day's dowel bar anchoring and tie bar placement processes are acceptable, the Engineer may allow a reduction in scanned joints in each subplot as follows: (1) Verify the adequacy of the dowel bar anchoring by scanning four random doweled contraction joints per subplot. (2) Verify the presence and alignment of tie bar steel by scanning 25 lin. ft. out of every subplot.

Concrete Wearing Course for Bridges

Test Type (Concrete Manual)	Spec.	Contractor/Producer QC Testing	Agency QA Testing	Form
Gradation, Quality, Coarse Agg -200 QC/Verification (5-694.145) (5-694.146) (5-694.148)	3126 3137	<p>Prior to production: The Contractor shall provide the Agency with: Aggregate pit numbers, 1 passing gradation result per fraction per source. Test Agency companion samples are Contractor's discretion.</p> <p>No quality tests are required.</p>	<p>Prior to production and each time aggregate is delivered to site: 1 gradation and quality per fraction prior to concrete production and each time aggregate is delivered to the site.</p> <p>Identify quality samples with a "Q" on the Sample ID Card and the Quality companion sample.</p>	2410 Sample ID Card
Air Content - Type 3 Concrete (Verification) (5-694.541)	2431	None	1 per 15 yd ³ , Test at beginning of pour each day.	Weekly Report of Low Slump Concrete
Slump (Verification) (5-694.531)		None	1 per 15 yd ³ Test at beginning of pour each day. For concrete from a concrete mobil, allow mix to hydrate 5 minutes before slump test to assure all cement is saturated.	
Compressive Strength (5-694.511)		None	1 cylinder (28 day) per 30 yd ³ , standard cylinder mold size is 4 x 8 inch.	2409 Cyl. ID Card
Cement	3101	None	Each time cement is delivered to site. Obtain a 5 lb. sample. Store sample in a sealed container and include the supplier's delivery invoice from which the sample is obtained.	2430 Sample ID Card
Admixtures	3113	None	Each time new lot/batch admixture is delivered to site: Obtain a ½ pint sample. Store the sample in a sealed plastic container.	2410 Sample ID Card
Test	Minimum Sample Size All gradation and aggregate quality tests require companion samples, double sample size. Samples taken at location identified on Contact Report located at plant.			
Gradation	6 lb. for # 7, 500 g for CA-80		500 g for Sand	
Quality	30 lb. for Coarse Aggregate		20 lb. Fine Aggregate	

Concrete Pavement Repair – CPR for 3U18

Test Type	Spec.	Contractor/Producer QC Testing	Agency QA Testing For volumetric batching only.	Forms
Gradation, Quality, Coarse Agg -200	3126 3137	<p>Prior to production: The Contractor shall provide the Agency with: Aggregate pit numbers, 1 passing gradation result per fraction per source.</p> <p>No quality test results are required. Test companion samples at Contractor's discretion.</p>	<p>Gradation: Prior to concrete production and each time aggregate is delivered to the site. 1 per aggregate fraction prior to production and each time aggregate is delivered to the site.</p> <p>Quality Testing & Coarse Agg -200: 1 test per aggregate fraction per source. The Agency may use the gradation results for the Quality Samples as a substitute for 1 required field gradation. Identify quality samples with a "Q" on the Sample ID Card and the Quality companion sample.</p>	2410 Sample ID Card
Air Content - Type 3 Concrete (Verification)	Review Concrete Manual Website	None	1 per 15 yd ³ or 1 per 4 hours whichever results in the highest sampling rate. Test at beginning of pour each day.	21412 Weekly Report of Low Slump Concrete
Slump (Verification)		None	1 per 15 yd ³ , Test at beginning of pour each day. Allow mix to hydrate 5 minutes before slump test to assure all cement is saturated. Test slump if concrete is suspected to be outside of required slump range.	
Compressive Strength		None	1 set of 3 cylinders (28 day) per 30 yd ³ . The Agency will cast up to three (3) field control cylinders, standard cylinder mold size is 4 x 8 inch.	
Type 1 Cement	3101	None	For Volumetric batching only: Each time cement is delivered to site. Obtain a 5 lb. sample. Store sample in a sealed container and include the supplier's delivery invoice from which the sample is obtained.	2430 Sample ID Card
Admixtures	3113	None	Each time new lot/batch admixture is delivered to site: Obtain a ½ pint sample. Store the sample in a sealed plastic container.	2430 Sample ID Card
Test	Minimum Sample Size All gradation and aggregate quality tests require companion samples, double sample size. Samples taken at location identified on Contact Report located at plant.			
Gradation	6 lb. for # 7, 500 g for CA-80		500 g for Sand	
Quality	30 lb. for Coarse Aggregate		20 lb. Fine Aggregate	

Dowel Bar Retrofit – (DBR)

Test Type	Spec.	Contractor/Producer QC Testing	Agency QA Testing	Form
Gradation Testing (Verification), Quality Testing including, Coarse Agg -200	3137	<p>Prior to production: The Contractor shall provide the Agency with: Aggregate pit numbers, 1 passing gradation result per fraction per source.</p> <p>No quality test results are required. Test companion samples are Contractor's discretion.</p>	<p>Gradation: Prior to concrete production and each time aggregate is delivered to the site.</p> <p>1 per aggregate fraction prior to production and each time aggregate is delivered to the site.</p> <p>Quality Testing & Coarse Agg -200: 1 test per aggregate fraction per source. The Agency may use the gradation results for the Quality Samples as a substitute for 1 required field gradation. Identify quality samples with a "Q" on the Sample ID Card and the Quality companion sample.</p>	2410 Sample ID Card
Test Type	Spec.	Agency QA Testing		Form
DBR Material Compressive Strength	<u>Review Concrete Manual</u>	Contractor Testing: Any additional field control cylinders are the responsibility of the Contractor.		2409 Cylinder ID Card
		<p>Agency Testing: 1 set of 3 cylinders (28 day) The Agency will cast up to three (3) field control cylinders, standard cylinder mold size is 4 x 8 inch.</p>		
Test	Minimum Sample Size			
	All gradation and quality tests require companion samples, double sample size. Samples taken at location identified on Contact Report located at plant.			
Gradation	500 g for # 89 & Sand			
Quality	30 lb. Coarse Aggregate		20 lb. Fine Aggregate	

Landscaping and Erosion Control Items

Kind of Material	Spec. #	Minimum Required Agency QA Acceptance Testing (Field Testing Rate)
Manufactured Topsoil Borrow, Salvaged Topsoil (stockpiled)	3877.2	As directed by the Engineer
<u>Plant Stock & Landscape Materials</u>	3861 and 2571.2A1	Materials must be in accordance with the Inspection and Contract Administration Guidelines for MnDOT Landscape Projects of which determines the minimum and maximum criteria thresholds. Certificate of Compliance, Nursery stock certificate registered with MN Dept. of Agriculture. Out of state products subject to pest quarantines must accompanied by documentation certifying all products are free of regulated pests.
<u>Erosion Control Blanket</u>	3885	Visual Inspection and Check approved products or approved vendors list - As directed by the Engineer.
<u>Erosion Control Netting</u>	3885	
<u>Silt Fence</u>	3886	
<u>Erosion Stabilization Mat</u>	3885	
Flotation Silt Curtain	3887	Accepted, based on manufacturers certification of compliance. Check weight of fabric.
Filter Logs	3897	Visual Inspection
Flocculants	3898	Obtain copy of Certificate of Compliance and MSDS
Fertilizer	3881	Obtain copy of invoice of blended material stating analysis.
Agricultural Lime	3879	Contractor must supply amount of ENP (Equivalent Neutralizing Power) for each shipment.
<u>Mulch - Type 3</u>	3882	Certified Weed Free (Certified sources only) Check for Certified Vendor tag from Minnesota Crop Improvement Association (MCIA).
Mulch - Type 6 - Woodchips		All wood chips supplied by a supplier outside the Emerald Ash Borer quarantine area or have an Emerald Ash Borer Compliance Agreement with the MDA
Seeds	3876	(Certified Vendors Only) (Mixes 100-299) Check for Certified Vendor tag from Minnesota Crop Improvement Association (MCIA).
Native Seed		(Mixes 300-399) certified seed only. Check for Certified Vendor tag from Minnesota Crop Improvement Association (MCIA).
<u>Sod</u>	3878	Visual Inspection - Check approved products list - As directed by the Engineer. Check for Certified Vendor tag from Minnesota Crop Improvement Association (MCIA) for salt tolerant sod.
<u>Compost (from Certified Source)</u>	3890	
Compost (from Non- Certified Source)		Visual Inspection - As directed by the Engineer.
<u>Hydraulic Soil Stabilizer</u>	3884	Check Approved/Qualified Products List - As directed by the Engineer.

Chemical Items

Kind of Material	Spec. No.	Minimum Required Agency QA Acceptance Testing (Field Testing Rate)
Asphalt Plank	3204	Visual Inspection - As directed by the Engineer.
Calcium Chloride	3911	Review the percentage required as per specification. Check for listing on Qualified Products website.
Magnesium Chloride	3912	
Hot-Pour Crack Sealant (for Crack Sealing/Filling)	3719 3723 3725	Retain Certification of Compliance. Check for listing on Qualified Products website.
Pavement Joint Adhesive	Special Provisions	Retain Certification of Compliance
Waterproofing Materials		
<u>Membrane Waterproofing System</u>	3757	Visual Inspection - Check qualified products list.
Waterproofing Materials - Three Ply System		
Asphalt Primer	3165	Verify supplied material meets ASTM D 41
Waterproofing Asphalt	3166	Verify supplied material meets ASTM D 449
Fabric	3201	Verify supplied material meets ASTM D 41
Paints		
<u>Waterborne Latex - Traffic Paint</u>	3591	Visual Inspection - Check qualified products list - retain Certificate of Compliance.
<u>Epoxy Traffic Paint</u>	3590	
<u>Traffic Marking Paint</u>	Special Provisions	
<u>Non-Traffic Striping Paints</u>	3500 Series	Retain Certification of Compliance
<u>Bridge Structural Steel Paint</u>	3520	Visual Inspection - Check approved products list - retain Certificate of Compliance.
<u>Exterior Masonry Paint</u>	3584	
<u>Noise Wall Stain</u>	Special Provisions	
<u>Drop-on Glass Beads</u>	3592	Visual Inspection - Check qualified products list. Retain Certificate of Compliance.
<u>Pavement Marking Tape</u>	3354	Visual Inspection - Check qualified products list. Retain Certificate of Compliance.
	3355	
	Special Provisions	
<u>Signs and Markers</u>	3352	Visual Inspection - Check qualified products list.

Metals (1 of 2)

Kind of Material	Spec. No.	Minimum Required Agency QA Acceptance Testing (Field Testing Rate) *
Guard Rail		
Fittings - Splicers, Bolts, Posts etc.	3381	Visual Inspection - Materials shall be approved before use. Call MnDOT inspector at 218-846-3613 to see if material has been approved.
Structural Plate Beam	3382	
Non-High Tension Guard Rail Cable	3381	
High Tension Guard Rail Cable	Special Provisions	
Steel Posts		
Steel Signposts	3401	Visual Inspection - As directed by the Engineer. Retain Certificate of Compliance in Project file.
Fence Posts, Brace Bars, Rails and others	3403	Visual Inspection - As directed by the Engineer. Retain Certificate of Compliance and certified mill analysis in project file.
	3406	
	3379	
Fence		
Barbed Wire	3376	Visual Inspection Retain Certification of Compliance, As directed by the Engineer.
Woven Wire		
Chain Link Fabric		
Components: cup, cap, nut, bolt, end clamp, tension band, truss rod tightener, hog ring, tie wire, tension stretcher bar, truss rod, clamp & tension wire		
Gates	3379	
Pipe		
Water Pipe and other Piping Materials	3364, 3365, 3366 & Special Provisions	Visual Inspection - As directed by the Engineer.
Reinforcing Steel - Inspected by MnDOT & will be charged back to the Local Agency.		
Uncoated Bars	3301	Retain Certificate of Compliance & Certified Mill Analysis
Epoxy Coated Bars	3301	For Epoxy-Coated bars, steel will be tagged "Inspected" when it has been sampled and tested by Mn/DOT prior to shipment, & it will be tagged "Sampled" when testing has not been completed prior to shipment. If the Epoxy-Coated bars are not tagged "Sampled" or "Inspected", submit samples (1 bar 3ft long for each size for each day's coating production), Certificate of Compliance, & Certified Mill Analysis for testing. Maintain original Cert. of Compliance & Certified Mill Analysis in project file.
Spirals	3305	
Stainless Steel Bars	Special Provisions	Visual Inspection Testing as directed by the Engineer (2 bars 3 ft. long per heat per bar size). Certified Mill Test Reports to be filed.

Metals (2 of 2)

Kind of Material	Spec. No.	Minimum Required Agency QA Acceptance Testing (Field Testing Rate) *	
Reinforcing Steel - Inspected by MnDOT & will be charged back to the Local Agency.			
Steel Fabric	3303	2 sq. ft. if epoxy coated.	Visual Inspection - Retain Certificate of Compliance.
Dowel Bars	3302	One dowel bar and basket from each shipment.	
Prestress/Post Tension Strands	3348 Spec Prov	One sample of 2 strands by 6 ft. from each heat/production lot.	
Castings			
Drainage Castings	3321	Visual Inspection - Check approved / qualified list.	
	2471		
Electrical	2565		
Anchor Rods (Cast in Place) and Structural Fasteners	3385 3391	Visual Inspection - Check approved / qualified list. Testing as directed by the Engineer (see notes below)	
Notes: Manufacturer must have one yearly passing test from the Department for each anchor rod or bolt type. Prior to installation, obtain copy of MnDOT passing test report from supplier. Specs 3385.2 A, B, & C require anchor rod markings per ASTM F 1554 S3. The end of each anchor bolt intended to project from the concrete must be die stamped with the grade identification as follows: Grade 36 = AB36, Grade 55 = AB55, Grade 105 = AB105.			
Anchorage (Drilled In)	Special Provisions	Visual Inspection - Check qualified products list.	
Structural Steel	Inspected by MnDOT & will be charged back to the Local Agency.		
Steel Bridge - Beams, Girders, Diaphragms, etc.	2471	Structural Metals Inspection Tag and field inspection for damage/defects, check dimensions for contract compliance. Review approved products list as directed by the Engineer. Note: Structural metals products will be inspected at the plant and will be shipped with a Structural Metals Inspection Tag. An inspection confirmation report will be completed by Structural Metals Inspection staff and sent to the field personnel. Only approved suppliers are allowed to supply Structural Metals products. A list of approved suppliers can be found on the Bridge Office website .	
Concrete Girders- Diaphragms and sole plates			
Expansion Joints			
Steel Bearings			
Railing-Structural tube and ornamental			
Drainage Systems			
Protection Angles			
Overhead Sign structures	2564 2471		
High Mast Lighting Structures	2545 2471		
Monotube Signal Structures	2565 2471		

*Check domestic steel requirement under 1601 Special Provision.

Geosynthetics, Pipe, Tile, Precast/ Prestressed Concrete

Kind of Material	Spec. No.	Minimum Required Agency QA Acceptance Testing (Field Testing Rate)
Corrugated Metal Products		
Culvert Pipe Under Drains Erosion Control Structures	3225 thru 3229, 3351, 3399	Make certain pipe is Certified on Invoice, retain certificate of compliance and certified mill analysis in project file.
Structural Plate	3231	
Aluminum Structural Plate	3233	Retain the Certificate of Compliance and mill analysis in project file.
Pipe		
Clay Pipe	3251	Visual Inspection
Reinforced Concrete Pipe and Arches, Precast Cattle Pass Units, Sectional Manhole Units	3236	Field Inspection: Check for damage and defects. Check dimensions and class as required.
Non-Reinforced Concrete Pipe	3253	
Drain Tile (Clay or Concrete)	3276	Visual Inspection - Acceptance as directed by the Engineer.
Thermoplastic (TP) Pipe ABS and PVC	3245	Obtain Certificate of compliance. Check for approved marking printed on pipe. Field Inspect for damage or defects.
Corrugated Polyethylene Pipe	3278	Check for markings (AASHTO M 252) Certificate of Compliance. Field Inspect for damage or defects.
<u>Corrugated Polyethylene Pipe - Dual Wall 12"-48"</u>	3247	Visual Inspection - Check approved products list. Obtain Certificate of Compliance.
Precast/Prestressed Concrete Structures - Inspected by MnDOT & will be charged back to the Local Agency.		
Reinforced Precast Box Culvert	3238	Field Inspection: Check for damage and defects. Check dimensions as required. Check for the "MnDOT" stamp and signature on the certification document.
Precast/Prestressed Concrete Structure (beams, posts, etc.)	2405	
Manholes and Catch Basins	2506 3622	
Sewer Joint Sealing Compound	3724	Visual Inspection - Acceptance as directed by the Engineer.
Preformed Plastic Sealer for Pipe	3726 Type b	Visual Inspection - Acceptance as directed by the Engineer.
Bituminous Mastic Joint Sealer for Pipe	3728	
EPS Geofoam	Special Provisions	Visual Inspection - Acceptance as directed by the Engineer. Check for yellow aged material, uniformity and dimensions.
Geotextile Fabric and Geogrid Reinforcement	3733 and Special Provisions	Obtain Certificate of Compliance stating minimum average roll values (MARV). MARV must meet Project requirements. Fabric must be listed on <u>Geotextile Small Quantity Acceptance List</u> .
<u>Geotextile Small Quantity Acceptance List</u>		
<u>Silt Fence</u>	3886	Visual Inspection - Check approved products list.

Electrical and Signal Equipment Items (1 of 2)

Kind of Material	Spec. No.	Minimum Required Agency QA Acceptance Testing (Field Testing Rate)
Lighting Standards (Aluminum or Steel)	3811	Visual Inspection - Obtain Certificate of Compliance. The Fabricator will submit "Certificate of Compliance," on a per project basis, to the Project Engineer.
<u>Hand Holes (Precast, PVC, and LLDPE)</u>	2545	Visual Inspection - Check approved/qualified products list. Traffic signal and street lighting projects require hand holes to be listed on the MnDOT Signals Approved Products List (APL). For cast iron frame and cover: see Metals - Drainage and Electrical Castings
	2550	
	2565	
Foundation	2545	Slump as needed, 1 cylinder per 25 cu. yds. Rebar is required in concrete foundations as specified in the Contract documents for all traffic control signals and roadway lighting projects.
Steel Screw In Foundations	2545	See Approved/Qualified Products List for Roadway Lighting and Signals.
	2565	
Conduit and Fittings		
Metallic	3801	Visual Inspection - Conduit shall be labeled as being listed by a National Recognized Testing Laboratory (NRTL). For traffic signal and street lighting projects, specific requirements are contained in the Special Provisions for each project.
	3802	
Non-Metallic (Rigid and HDPE)	3803	
	Special Provisions	
Anchor Rods and Bolts (Cast in Place)	3385	Visual Inspection - Manufacturer must have one yearly passing test from the Department for each anchor rod or bolt type. Prior to installation, obtain copy of Mn/DOT passing test report from supplier. Specs 3385.2 A, B, & C require anchor rod markings per ASTM F 1554 S3. The end of each anchor bolt intended to project from the concrete must be die stamped with the grade identification as follows: Grade 36 = AB36, Grade 55 = AB55, Grade 105 = AB105.
<u>Anchorage (Drilled In)</u>	Special Provision	Visual Inspection - Check qualified products list.
<u>Miscellaneous Hardware</u>	2545 2565	Visual Inspection - Check approved products list. Will carry "Inspected" tag if sampled and tested prior to shipment. No sample necessary if "Inspected". Do not use if not tested. Field sample at sampling rate for laboratory testing. For traffic signal and street light lighting projects, various miscellaneous hardware is required to be listed on the MnDOT Signals and Lighting Approved Products Lists (APL). The Contract documents indicate, which items must be on the Signals and/or Lighting APL.

Electrical and Signal Equipment Items (2 of 2)

Kind of Material	Spec. No.	Minimum Required Agency QA Acceptance Testing (Field Testing Rate)
Cable and Conductors		
Power Conductors	3815.2B1	Visual Inspection - Make certain the conductors are the type specified. Submit Field Inspection report showing type and quantities used. Shall be labeled as being listed by a National Recognized Testing Laboratory (NRTL) and type where applicable.
Loop Detector Conductors (No Tubing)	3815.2B2 (a)	
Electrical Cables and Single Conductors with Jacket	3815.2B2(b)	Visual Inspection - Usually inspected at the distributor. Documentation showing project number, reel number(s), & MnDOT test number(s) will be included with each project shipment. If such documentation is not received from Contractor, submit sample for testing along with material certification from manufacturer. Do not use if not tested. Pre-inspected materials will not be tagged; an inspection report will be sent by the MnDOT inspector for each shipment. Project inspectors should verify that the shipping documents agree with this inspection report. Call Steve Grover at 651-366-5540 or Cindy Schellack at 651-366-5543 with questions. For traffic signal and street lighting projects, the Special Provisions for each project contain electrical cable and conductor specifications.
	3815.2B3	
	3815.2B5	
	3815.2C1 thru .2C8	
	3815.2C14	
	Special Provisions	
Fiber Optic Cables	3815.2C13	Visual Inspection - Check approved products list for Traffic Management Systems.
Ground Rods	2545	Visual Inspection - Check approved products list. Shall be labeled as being listed by a National Recognized Testing Laboratory (NRTL). Detail materials on Materials Acceptance Summary.
	2565	
Luminaires and Lamps	3810	Visual Inspection - Check approved products list. Traffic signal and street lighting projects require luminaires and lamps to be listed on the MnDOT Lighting Approved/Qualified Products List (APL). The conductors shall be labeled as being listed by a National Recognized Testing Laboratory (NRTL) and type, where applicable.
Electrical Systems	2565	Electrical Systems are to be reported as a "System" using the LIGHTING, SIGNAL AND TRAFFIC RECORDER INSPECTION REPORT. To be certified by the Project Engineer.
Traffic Signal Systems	2565	Traffic Signal Systems are to be reported as a "System" using the LIGHTING, SIGNAL AND TRAFFIC RECORDER INSPECTION REPORT. To be certified by the Project Engineer.

Brick, Stone, and Masonry Units

Kind of Material	Spec. No.	Minimum Required Agency QA Acceptance Testing (Field Testing Rate)
Brick		
Sewer (clay) and Building	3612 to 3615	Visual Inspection - Acceptance as directed by the Engineer.
Sewer (Concrete)	3616	Visual Inspection - Acceptance as directed by the Engineer. Air entrainment required. Obtain air content statement from supplier.
Concrete Masonry Units		
Sewer Construction	3621	Visual Inspection - Acceptance as directed by the Engineer. Air entrainment required. Obtain air content statement from supplier.
<u>Modular Block Retaining Walls</u>	Review Current Special Provisions	Visual Inspection - Note: All lots of blocks upon delivery shall have Manufacturer or Independent laboratory test results to verify passing both compression and freeze-thaw requirements. * Wall units and cap units are considered separate block types.
Reinforced Concrete Cribbing	3661	Visual Inspection - Acceptance as directed by the Engineer. Will be stamped when inspected prior to shipment.
Stone for Masonry or Rip-Rap	2511, 3601 and Special Provisions	Visual Inspection - Acceptance as directed by the Engineer.

Remarks: each source shall be approved by Project Engineer or supervisor for quality, prior to use. For questions on quality, contact District Materials or Geology Unit.

Miscellaneous Materials

Kind of Material	Spec. No.	Minimum Required Agency QA Acceptance Testing (Field Testing Rate)
Timber, Lumber Piling & Posts	3412 to 3471 & 3491	Visual Inspection - Acceptance as directed by the Engineer. Untreated materials shall be inspected in the field. Treated materials shall be Certified on the Invoice or Shipping Ticket. Material is inspected and stamped by an Independent Agency as per Specification 3491. Contact Laboratory for additional information.
Miscellaneous pieces and Hardware (Galvanized)	3392 3394	Visual Inspection - Acceptance as directed by the Engineer.
Insulation Board	3760	
Elastomeric Bearing Pads - Plain or Laminated	3741 and Special Provisions	Check dimensions. Check repair of tested pad. Obtain copy of Certificate of Compliance. DO NOT USE ANY PADS THAT ARE NOT CERTIFIED.
Cotton Duck Bearing Pads		

Approved/Qualified Products & Resources

Approved/Qualified Products

- [Asphalt Products](#)
- [Bridge Products](#)
- [Concrete Products](#)
- [Crack and Joint Material Products](#)
- [Drainage](#)
- [Erosion Control and Landscaping Products](#)
- [Geosynthetic](#)
- [Maintenance Shop Supplies](#)
- [Paint/Stain/Coating Systems \(Non-Pavement\)](#)
- [Pavement Markings](#)
- [Precast Concrete](#)
- [Roadside Barriers](#)
- [Roadway Lighting Products](#)
- [Signals Products](#)
- [Signing Products](#)
- [Snow and Ice Chemical Products](#)
- [Temporary Traffic Control Devices](#)
- [Traffic Management Systems/ITS](#)
- [Truncated Domes](#)
- [Vehicle Safety Lighting](#)
- [Walls \(Retaining/Noise\)](#)

Additional Resources

- [SALT Construction webpage](#)
- [Bituminous Engineering](#)
 - [Asphalt Binder Certified Supplier](#)
 - [Asphalt Emulsion Certified Supplier](#)
- [Concrete Engineering](#)
 - [MnDOT Concrete Manual](#)
 - [QC & QA RM Plant Workbooks](#)
 - [MnDOT Certified Ready-Mix Program](#)
- [Grading & Base Engineering](#)
 - Testing procedures in the [Grading & Base Manual](#)
 - Forms and worksheets at the [Grading & Base website](#)
 - Gradation worksheets on the [SALT Construction website](#)

Contacts

MnDOT Construction and Materials State Aid Contacts

Districts 1, 2, 3, 4

Ross Hendrickson, State Aid Construction Specialist

ross.hendrickson@state.mn.us

218-766-3745

Districts 6, 7, 8

Rollin Larson, State Aid Construction Specialist

rollin.larson@state.mn.us

507-205-6403

Metro

Michael Pretel, State Aid Construction Engineer

michael.pretel@state.mn.us

651-755-3346

MnDOT Specialty Offices Contacts

Grading & Base

Terry Beaudry terry.beaudry@state.mn.us	Grading & Base Engineer	651-366-5456
John Bormann john.bormann@state.mn.us	Grading & Base Specialist	651-366-5596

Bituminous*

John Garrity john.garrity@state.mn.us	Bituminous Engineer	651-366-5577
Greg Johnson Greg.johnson@state.mn.us	Asst. Bituminous Engineer	651-366-5464
Chelsea Bennett chelsea.bennett@state.mn.us	Asst. Bituminous Engineer	651-366-5482
Joel Ullring joel.ullring@state.mn.us	Pavement Preservation	651-366-5432
Mike Skurdalsvold	Bituminous Mix Design Specialist	612-499-2998
Ray Betts ray.betts@state.mn.us	Bituminous Trial Mix Lab Tech	651-366-5469
Rich Kane richard.kane@state.mn.us	Bituminous Plant & Lab Testing	612-437-3005

*See website for the contact list by topic

Concrete*

Maria Masten maria.masten@state.mn.us	Concrete Engineer	651-334-4015
Jacob Gave jacob.gave@state.mn.us	Asst. Concrete Engineer	612-554-9289
Rob Golish robert.golish@sate.mn.us	Asst. Concrete Engineer	651-216-0516
Matt Herbst	Concrete Engineering Specialist	651-283-7127

2024 SALT Schedule of Materials Control – Local Government Agency

Matt.herbst@state.mn.us		
Brad Swenson brad.swenson@state.mn.us	Concrete Engineering Specialist	218-232-1012
Gordy Bruhn gordon.bruhn@state.mn.us	Concrete Field Engineering Specialist	651-398-9597
Mike Daniels michael.daniels@state.mn.us	Concrete Engineering Specialist	320-293-9421

*See website for the contact list by topic

Contacts for other materials can be found on the [Materials and Road Research Contacts webpage](#).

Contacts for Approved Products can be found at the [Approved/Qualified Products Contact webpage](#).

Materials Lab. Contacts	Independent Assurance
District 1, Duluth Leila DeLuca Phone: 218-725-2738 D1.duluth.lab.dot@state.mn.us	Nadine Miller Phone: 218-725-2737 Cell: 218-348-6297 nadine.miller@state.mn.us
District 2, Bemidji Jason Kissel Phone: 218-755-6542 jason.kissel@state.mn.us Mike Murphy (Concrete & Aggregates) Phone: 218-755-6593 mike.murphy@state.mn.us Dustin Reese (Bituminous) Phone: 218-755-6593 dustin.reese@state.mn.us	Ray Wesley Cell: 218-766-6949 raymond.wesley@state.mn.us
District 3A, Baxter Tom Boser Phone: 218-828-5755 tom.boser@state.mn.us	Matt Miles Cell: 218-232-6748 matt.miles@state.mn.us
District 3B, Saint Cloud Nick Fisher Phone: 320-2236500 nicholas.fisher@state.mn.us Andy Kostreba Phone: 320-223-6554 andy.kostreba@state.mn.us	Travis Erickson Cell: 320-291-3582 travis.erickson@state.mn.us
District 4, Detroit Lakes Bruce Bryngelson Phone: 218-846-3614 bruce.bryngelson@state.mn.us Wayne Koons	Casey Clarke Cell: 218-849-7393

2024 SALT Schedule of Materials Control – Local Government Agency

Phone: 218-846-3617 wayne.koons@state.mn.us	casey.clarke@state.mn.us
Metro District, Maplewood Lab Brent Sculley Phone 651-366-5409 brent.scolley@state.mn.us	Waters Edge Phone: 651-234-7356 Zachary Lyrek-Hanks Phone: 651-775-1018 zachary.Lyrek-Hanks@state.mn.us West Karl Sinclair Phone: 651-775-0998 karl.sinclair@state.mn.us East Kris Westerbur Phone: 651-755-1151 kristopher.westerbur@state.mn.us Kaleb Kollmann Phone: 651-478-0339 kaleb.kollmann@state.mn.us
District 6, Rochester Scott Swanson Phone: 507-286-7580 scott.a.swanson@state.mn.us Jeff Bale (Aggregates) Phone: 507-286-7586 jeff.bale@state.mn.us Joe Drees (Bituminous) Phone: 507-286-7582 joe.drees@state.mn.us Gary Vinge Phone: 507-286-7585 gary.vinge@sate.mn.us	Dennis Hayes Cell: 507-251-0138 dennis.hayes@state.mn.us
District 7, Mankato Lee McLaughlin Phone: 507-304-6189 lee.mclaughlin@state.mn.us	Mitch Jordahl Cell: 507-380-9619 mitch.iordahl@state.mn.us
District 8, Willmar and Marshall Jon Vlaininck Phone: 320-214-6348 Cell: 320-894-7409 jon.vlaininck@state.mn.us District 8B, Marshall Matt Steinbronn Phone: 507-537-2068 matthew.steinbronn@state.mn.us	Paul Janke Cell: 320-212-5739 paul.janke@state.mn.us

Sample Sizes

Lbs.

Bituminous	35	Aggregate for Gradation QC/QA
	80	for each plus #4 Aggregate Type for Quality Testing
	35	for each minus #4 Aggregate Type for Quality Testing
	80	for each RAP material for Quality Testing
	10	RAS (shingles) for Processed Gradation and Quality Testing
	65	for Mix Properties (QC/QA) 3 full 6" by 12"-cylinder molds for QA
	90	for TSR (QC/QA) 4 full 6" by 12"-cylinder molds for QA
	90	for Aggregate Specific Gravity QC/QA
	-	1 quart of Asphalt Binder QA
	-	1/2 gallon for Asphalt Emulsion QA
Grading & Base	30	Aggregate for Gradation (Companion sample from 60 lb. split).
	25	Moisture Density Test – Proctor (Companion from 50 lb. split).
	30	Aggregate Quality/Percent Crushing Test - 1 per source
Ready-Mix Concrete	25	Gradation 3/4" plus
	10	Gradation 3/4" minus
	6	Gradation CA 70 & #7
	1	Gradation - Sand (500 g), CA 80, #89.
	4.4	Moisture Test Coarse Aggregate (2000 g)
	1.1	Moisture Test Fine Aggregate (500 g)
	50	Quality 3/4" plus - lab sample
	30	Quality 3/4" minus - lab sample
	30	Fine Aggregate - lab sample
	10	3/4" Plus for the -200 Coarse Aggregate Test (5000 grams)
	6	3/4" Minus for the -200 Coarse Aggregate Test (2500 grams)
	5	Cement, Blended Cement, Fly Ash
	-	1/2-pint plastic container for admixtures.

NON-COLLUSION AFFIDAVIT

The following Non-Collusion Affidavit shall be executed by the bidder:

State Project No. _____

Federal Project No. _____

State of Minnesota _____

) ss

County of _____

I, _____, do state under penalty of
(name of person signing this affidavit)

perjury under 28 U.S.C. 1746 of the laws of the United States:

(1) that I am the authorized representative of _____

(name of person, partnership or corporation submitting this proposal)

and that I have the authority to make this affidavit for and on behalf of said bidder;

(2) that, in connection with this proposal, the said bidder has not either directly or indirectly entered into any agreement, participated in any collusion or otherwise taken any action in restraint of free competitive bidding;

(3) that, to the best of my knowledge and belief, the contents of this proposal have not been communicated by the bidder or by any of his/her employees or agents to any person who is not an employee or agent of the bidder or of the surety on any bond furnished with the proposal and will not be communicated to any person who is not an employee or agent of the bidder or of said surety prior to the official opening of the proposal, and

(4) that I have fully informed myself regarding the accuracy of the statements made in this affidavit.

Signed: _____
(bidder or his authorized representative)

This page was intentionally left blank.

STATE OF MINNESOTA – AFFIRMATIVE ACTION CERTIFICATION

If your response to this solicitation is or could be in excess of \$100,000.00, complete the information requested below to determine whether you are subject to the Minnesota Human Rights Act (Minnesota Statutes 363A.36) certification requirement, and to provide documentation of compliance if necessary. It is your sole responsibility to provide this information and—if required—to apply for Human Rights certification prior to the due date and time of the bid or proposal and to obtain Human Rights certification prior to the execution of the contract. The State of Minnesota is under no obligation to delay proceeding with a contract until a company receives Human Rights certification.

BOX A – For companies which have employed more than 40 full-time employees within Minnesota on any single working day during the previous 12 months. All other companies proceed to BOX B.

Your response will be rejected unless your business:

Has a current Certification of Compliance issued by the Minnesota Department of Human Rights (MDHR)

-or-

Has submitted an affirmative action plan to the MDHR, which the Department received prior to the date and time the responses are due.

Check one of the following statements if you have employed more than 40 full-time employees in Minnesota on any single working day during the previous 12 months:

We have a current Certificate of Compliance issued by the MDHR. **Proceed to Box C. Include a copy of your Certification with your response**

We do not have a current Certificate of Compliance; However, we submitted an Affirmative Action Plan to the MDHR for approval, which the Department received on _____ (date). If the date is the same as the response due date, indicate the time your plan was received: _____ (time). **Proceed to Box C.**

We do not have a Certification of Compliance, nor has the MDHR received an Affirmative Action Plan from our company. We acknowledge that our response will be rejected. Proceed to Box C. Contact the MDHR for assistance. (See below for contact information)

Please note: Certificates of Compliance must be issued by the MDHR. Affirmative Action Plans must be approved by the Federal government, a county or a municipality must still be received, reviewed and approved by the MDHR before a Certification can be issued.

BOX B – For those companies not described in BOX A

Check below

☐ We have not employed more than 40 full-time employees on any single working day in Minnesota within the previous 12 months. **Proceed to BOX C.**

BOX C – For all companies

By signing this statement, you certify that the information provided is accurate and that you are authorized to sign on behalf of the responder. You also certify that you are in compliance with federal affirmative action requirements that may apply to your company. (These requirements are generally triggered only by participating as a prime or subcontractor on federal projects or contracts. Contractors are alerted to these requirements by the federal government.)

Name of Company: _____ Date: _____

Authorized Signature: _____ Telephone number: _____

Printed Name: _____ Title: _____

For assistance with this form, contact:

Minnesota Department of Human Rights, Compliance Services Section

Mail: 190 East 5th St., Suite 700 St. Paul, MN 55101

TC Metro: (651) 296-5663

Toll Free: 800-657-3704

Web: www.humanrights.state.mn.us

Fax: (651) 296-9042

TTY: (651) 296-1283

Email: employerinfo@therightsplace.net

This page was intentionally left blank.

**ATTACHMENT A
PRIME CONTRACTOR RESPONSE**

RESPONSIBLE CONTRACTOR VERIFICATION AND CERTIFICATION OF COMPLIANCE

STATE PROJECT NUMBER: _____

This form includes changes by statutory references from the Laws of Minnesota 2015, chapter 64, sections 1-9. This form must be submitted with the response to this solicitation. A response received without this form, will be rejected.

Minn. Stat. § 16C.285, Subd. 7. **IMPLEMENTATION.** ... any prime contractor or subcontractor or motor carrier that does not meet the minimum criteria in subdivision 3 or fails to verify that it meets those criteria is not a responsible contractor and is not eligible to be awarded a construction contract for the project or to perform work on the project...

Minn. Stat. § 16C.285, Subd. 3. **RESPONSIBLE CONTRACTOR, MINIMUM CRITERIA.** "Responsible contractor" means a contractor that conforms to the responsibility requirements in the solicitation document for its portion of the work on the project and verifies that it meets the following minimum criteria:

- | | |
|-----|---|
| (1) | <p>The Contractor:</p> <ul style="list-style-type: none">(i) is in compliance with workers' compensation and unemployment insurance requirements;(ii) is in compliance with Department of Revenue and Department of Employment and Economic Development registration requirements if it has employees;(iii) has a valid federal tax identification number or a valid Social Security number if an individual; and(iv) has filed a certificate of authority to transact business in Minnesota with the Secretary of State if a foreign corporation or cooperative. |
| (2) | <p>The contractor or related entity is in compliance with and, during the three-year period before submitting the verification, has not violated section 177.24, 177.25, 177.41 to 177.44, 181.03, 181.101, 181.13, 181.14, or 181.722, and has not violated United States Code, title 29, sections 201 to 219, or United States Code, title 40, sections 3141 to 3148. For purposes of this clause, a violation occurs when a contractor or related entity:</p> <ul style="list-style-type: none">(i) repeatedly fails to pay statutorily required wages or penalties on one or more separate projects for a total underpayment of \$25,000 or more within the three-year period, provided that a failure to pay is "repeated" only if it involves two or more separate and distinct occurrences of underpayment during the three-year period;(ii) has been issued an order to comply by the commissioner of Labor and Industry that has become final;(iii) has been issued at least two determination letters within the three-year period by the Department of Transportation finding an underpayment by the contractor or related entity to its own employees;(iv) has been found by the commissioner of Labor and Industry to have repeatedly or willfully violated any of the sections referenced in this clause pursuant to section 177.27;(v) has been issued a ruling or findings of underpayment by the administrator of the Wage and Hour Division of the United States Department of Labor that have become final or have been upheld by an administrative law judge or the Administrative Review Board; or(vi) has been found liable for underpayment of wages or penalties or misrepresenting a construction worker as an independent contractor in an action brought in a court having jurisdiction. Provided that, if the contractor or related entity contests a determination of underpayment by the Department of Transportation in a contested case proceeding, a violation does not occur until the contested case proceeding has concluded with a determination that the contractor or related entity underpaid wages or penalties;* |

(3)	The contractor or related entity is in compliance with and, during the three-year period before submitting the verification, has not violated section 181.723 or chapter 326B. For purposes of this clause, a violation occurs when a contractor or related entity has been issued a final administrative or licensing order;*
(4)	The contractor or related entity has not, more than twice during the three-year period before submitting the verification, had a certificate of compliance under section 363A.36 revoked or suspended based on the provisions of section 363A.36, with the revocation or suspension becoming final because it was upheld by the Office of Administrative Hearings or was not appealed to the office;*
(5)	The contractor or related entity has not received a final determination assessing a monetary sanction from the Department of Administration or Transportation for failure to meet targeted group business, disadvantaged business enterprise, or veteran-owned business goals, due to a lack of good faith effort, more than once during the three-year period before submitting the verification;*
	* Any violations, suspensions, revocations, or sanctions, as defined in clauses (2) to (5), occurring prior to July 1, 2014, shall not be considered in determining whether a contractor or related entity meets the minimum criteria.
(6)	The contractor or related entity is not currently suspended or debarred by the federal government or the state of Minnesota or any of its departments, commissions, agencies, or political subdivisions that have authority to debar a contractor; and
(7)	All subcontractors and motor carriers that the contractor intends to use to perform project work have verified to the contractor through a signed statement under oath by an owner or officer that they meet the minimum criteria listed in clauses (1) to (6).

Minn. Stat. § 16C.285, Subd. 5. SUBCONTRACTOR VERIFICATION.

A prime contractor or subcontractor shall include in its verification of compliance under subdivision 4 a list of all of its first-tier subcontractors that it intends to retain for work on the project. Prior to execution of a construction contract, and as a condition precedent to the execution of a construction contract, the apparent successful prime contractor shall submit to the contracting authority a supplemental verification under oath confirming compliance with subdivision 3, clause (7). Each contractor or subcontractor shall obtain from all subcontractors with which it will have a direct contractual relationship a signed statement under oath by an owner or officer verifying that they meet all of the minimum criteria in subdivision 3 prior to execution of a construction contract with each subcontractor.

If a prime contractor or any subcontractor retains additional subcontractors on the project after submitting its verification of compliance, the prime contractor or subcontractor shall obtain verifications of compliance from each additional subcontractor with which it has a direct contractual relationship and shall submit a supplemental verification confirming compliance with subdivision 3, clause (7), within 14 days of retaining the additional subcontractors.

A prime contractor shall submit to the contracting authority upon request copies of the signed verifications of compliance from all subcontractors of any tier pursuant to subdivision 3, clause (7). A prime contractor and subcontractors shall not be responsible for the false statements of any subcontractor with which they do not have a direct contractual relationship. A prime contractor and subcontractors shall be responsible for false statements by their first-tier subcontractors with which they have a direct contractual relationship only if they accept the verification of compliance with actual knowledge that it contains a false statement.

Subd. 5a. Motor carrier verification. A prime contractor or subcontractor shall obtain annually from all motor carriers with which it will have a direct contractual relationship a signed statement under oath by an owner or officer verifying that they meet all of the minimum criteria in subdivision 3 prior to execution of a construction contract with each motor carrier. A prime contractor or subcontractor shall require each such motor carrier to provide it with immediate written notification in the event that the motor carrier no longer meets one or more of the minimum criteria in subdivision 3 after submitting its annual verification. A motor carrier shall be ineligible to perform work on a project covered by this section if it does not meet all the minimum criteria in subdivision 3. Upon request, a prime contractor or subcontractor shall submit to the contracting authority the signed verifications of compliance from all motor carriers providing for-hire transportation of materials, equipment, or supplies for a project.

Minn. Stat. § 16C.285, Subd. 4. VERIFICATION OF COMPLIANCE.

A contractor responding to a solicitation document of a contracting authority shall submit to the contracting authority a signed statement under oath by an owner or officer verifying compliance with each of the minimum criteria in subdivision 3, with the exception of clause (7), at the time that it responds to the solicitation document.

A contracting authority may accept a signed statement under oath as sufficient to demonstrate that a contractor is a responsible contractor and shall not be held liable for awarding a contract in reasonable reliance on that statement. A prime contractor, subcontractor, or motor carrier that fails to verify compliance with any one of the required minimum criteria or makes a false statement under oath in a verification of compliance shall be ineligible to be awarded a construction contract on the project for which the verification was submitted.

A false statement under oath verifying compliance with any of the minimum criteria may result in termination of a construction contract that has already been awarded to a prime contractor or subcontractor or motor carrier that submits a false statement. A contracting authority shall not be liable for declining to award a contract or terminating a contract based on a reasonable determination that the contractor failed to verify compliance with the minimum criteria or falsely stated that it meets the minimum criteria. A verification of compliance need not be notarized. An electronic verification of compliance made and submitted as part of an electronic bid shall be an acceptable verification of compliance under this section provided that it contains an electronic signature as defined in section 325L.02, paragraph (h).

CERTIFICATION

By signing this document I certify that I am an owner or officer of the company, and I certify under oath that:

- 1) My company meets each of the Minimum Criteria to be a responsible contractor as defined herein and is in compliance with Minn. Stat. § 16C.285, and**
- 2) if my company is awarded a contract, I will submit Attachment A-1 prior to contract execution, and**
- 3) if my company is awarded a contract, I will also submit Attachment A-2 as required.**

Authorized Signature of Owner or Officer:	Printed Name:
Title:	Date:
Company Name:	

NOTE: Minn. Stat. § 16C.285, Subd. 2, (c) If only one prime contractor responds to a solicitation document, a contracting authority may award a construction contract to the responding prime contractor even if the minimum criteria in subdivision 3 are not met.

ATTACHMENT A-1

FIRST-TIER SUBCONTRACTORS LIST

SUBMIT PRIOR TO EXECUTION OF A CONSTRUCTION CONTRACT

STATE PROJECT NUMBER: _____

Minn. Stat. § 16C.285, Subd. 5. A prime contractor or subcontractor shall include in its verification of compliance under subdivision 4 a list of all of its first-tier subcontractors that it intends to retain for work on the project. Prior to execution of a construction contract, and as a condition precedent to the execution of a construction contract, the apparent successful prime contractor shall submit to the contracting authority a supplemental verification under oath confirming compliance with subdivision 3, clause (7). Each contractor or subcontractor shall obtain from all subcontractors with which it will have a direct contractual relationship a signed statement under oath by an owner or officer verifying that they meet all of the minimum criteria in subdivision 3 prior to execution of a construction contract with each subcontractor.

FIRST TIER SUBCONTRACTOR NAMES* (Legal name of company as registered with the Secretary of State)	Name of city where company home office is located

*Attach additional sheets as needed for submission of all first-tier subcontractors.

SUPPLEMENTAL CERTIFICATION FOR ATTACHMENT A-1	
By signing this document I certify that I am an owner or officer of the company, and I certify under oath that: All first-tier subcontractors listed on attachment A-1 have verified through a signed statement under oath by an owner or officer that they meet the minimum criteria to be a responsible contractor as defined in Minn. Stat. § 16C.285.	
Authorized Signature of Owner or Officer:	Printed Name:
Title:	Date:
Company Name:	

ATTACHMENT A-2

ADDITIONAL SUBCONTRACTORS LIST

PRIME CONTRACTOR TO SUBMIT AS SUBCONTRACTORS ARE ADDED TO THE PROJECT

STATE PROJECT NUMBER: _____

This form must be submitted to the Project Manager or individual as identified in the solicitation document.

Minn. Stat. § 16C.285, Subd. 5. ... If a prime contractor or any subcontractor retains additional subcontractors on the project after submitting its verification of compliance, the prime contractor or subcontractor shall obtain verifications of compliance from each additional subcontractor with which it has a direct contractual relationship and shall submit a supplemental verification confirming compliance with subdivision 3, clause (7), within 14 days of retaining the additional subcontractors. ...

ADDITIONAL SUBCONTRACTOR NAMES* (Legal name of company as registered with the Secretary of State)	Name of city where company home office is located

*Attach additional sheets as needed for submission of all additional subcontractors.

SUPPLEMENTAL CERTIFICATION FOR ATTACHMENT A-2

By signing this document I certify that I am an owner or officer of the company, and I certify under oath that:

All additional subcontractors listed on Attachment A-2 have verified through a signed statement under oath by an owner or officer that they meet the minimum criteria to be a responsible contractor as defined in Minn. Stat. § 16C.285.

Authorized Signature of Owner or Officer:

Printed Name:

Title:

Date:

Company Name:

This page was intentionally left blank.

Todd County Public Works
Schedule of Prices

Contract No.: 202502

Project Number: CP 25:71

Project Title or Road Number: CR 71

Work Type: GRAVEL SURFACING

BIDDER MUST FILL IN UNIT PRICES IN NUMERALS; MAKE EXTENSION FOR EACH ITEM AND TOTAL. FOR COMPLETE INFORMATION CONCERNING THESE ITEMS, SEE PLANS AND SPECIFICATIONS, INCLUDING SPECIAL PROVISIONS.

Line Number	Item No.	Description	Units	Quantity	Unit Price	Total Price
1	2118.509	AGGREGATE SURFACING CLASS 1 MOD.	TON	4,900		
TOTAL:						

Bidder Name: _____

Bidder Address: _____

Bidder Phone: _____

Bidder Signature: _____

Date: _____

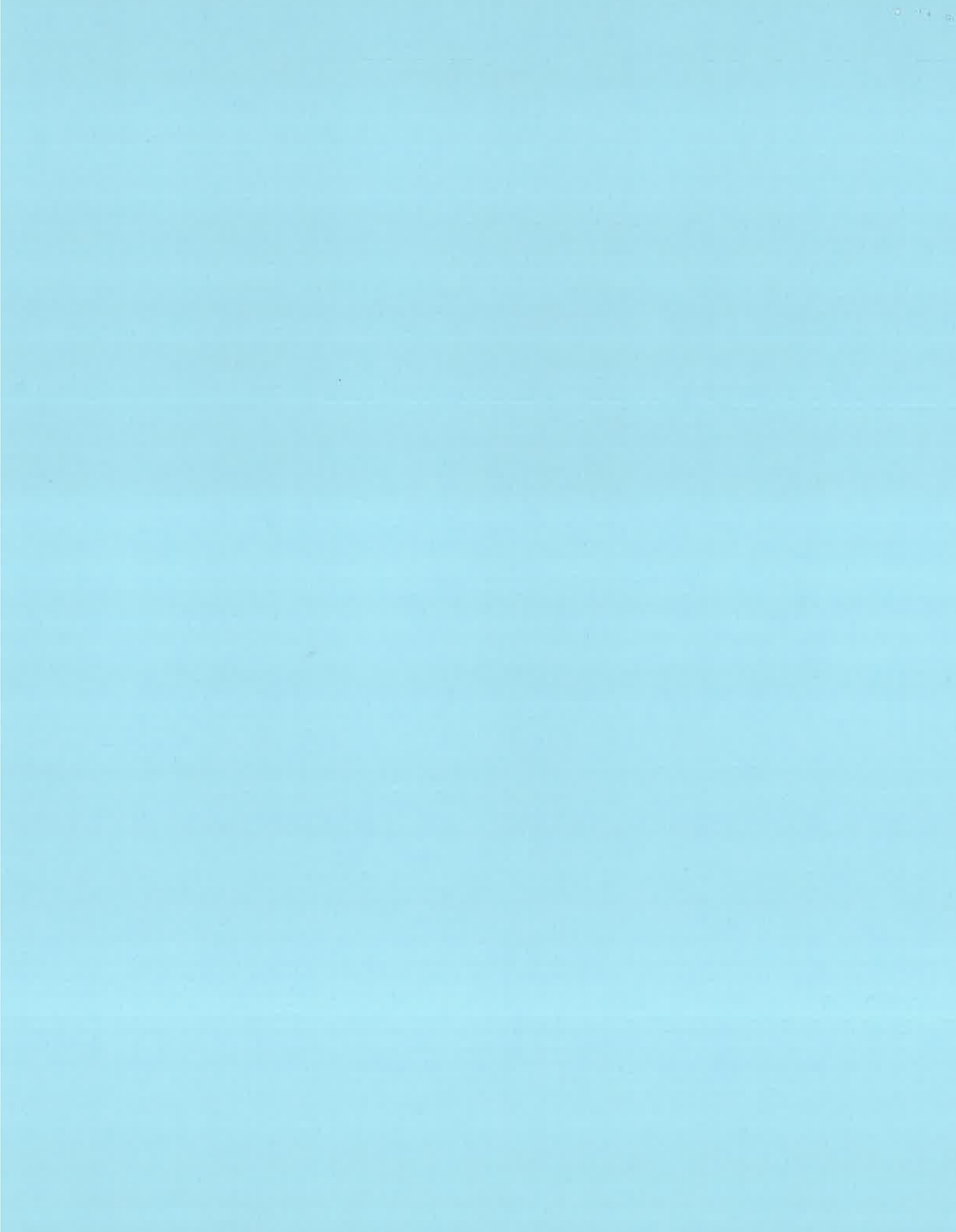

Todd County Public Works
Schedule of Prices

Contract No.: 202502

Project Number: CP 25:85

Project Title or Road Number: CR 85

Work Type: GRAVEL SURFACING

BIDDER MUST FILL IN UNIT PRICES IN NUMERALS; MAKE EXTENSION FOR EACH ITEM AND TOTAL. FOR COMPLETE INFORMATION CONCERNING THESE ITEMS, SEE PLANS AND SPECIFICATIONS, INCLUDING SPECIAL PROVISIONS.

Line Number	Item No.	Description	Units	Quantity	Unit Price	Total Price
1	2118.509	AGGREGATE SURFACING CLASS 1 MOD.	TON	7,800		
TOTAL:						

Bidder Name: _____

Bidder Address: _____

Bidder Phone: _____

Bidder Signature: _____

Date: _____

the 1990s, the number of people in the world who are under 15 years of age is expected to increase from 1.1 billion to 1.5 billion.

As the population of the world grows, the demand for food and other resources will increase. This will put pressure on the environment and on the world's resources.

One of the ways to deal with this problem is to increase the efficiency of food production. This can be done by using better farming techniques and by using more resources.

Another way to deal with this problem is to reduce the demand for food. This can be done by eating less meat and by eating less food that is wasted.

There are many other ways to deal with this problem. The important thing is to find a way to deal with it that will not harm the environment or the world's resources.

One of the most important things we can do is to educate people about the problem. If people know more about the problem, they will be more likely to take action to solve it.

Another important thing we can do is to support the people who are working to solve the problem. This can be done by donating money or by volunteering our time.

There are many other things we can do to help solve the problem. The important thing is to get started now.

One of the most important things we can do is to eat less meat. Meat production is one of the most resource-intensive ways to produce food.

Another important thing we can do is to eat less food that is wasted. Food waste is a major problem in many countries.

There are many other things we can do to help solve the problem. The important thing is to get started now.

One of the most important things we can do is to support the people who are working to solve the problem. This can be done by donating money or by volunteering our time.

Another important thing we can do is to educate people about the problem. If people know more about the problem, they will be more likely to take action to solve it.

There are many other things we can do to help solve the problem. The important thing is to get started now.

One of the most important things we can do is to eat less meat. Meat production is one of the most resource-intensive ways to produce food.

Another important thing we can do is to eat less food that is wasted. Food waste is a major problem in many countries.

There are many other things we can do to help solve the problem. The important thing is to get started now.

One of the most important things we can do is to support the people who are working to solve the problem. This can be done by donating money or by volunteering our time.

Another important thing we can do is to educate people about the problem. If people know more about the problem, they will be more likely to take action to solve it.

There are many other things we can do to help solve the problem. The important thing is to get started now.

One of the most important things we can do is to eat less meat. Meat production is one of the most resource-intensive ways to produce food.

Another important thing we can do is to eat less food that is wasted. Food waste is a major problem in many countries.

There are many other things we can do to help solve the problem. The important thing is to get started now.

One of the most important things we can do is to support the people who are working to solve the problem. This can be done by donating money or by volunteering our time.

Another important thing we can do is to educate people about the problem. If people know more about the problem, they will be more likely to take action to solve it.

There are many other things we can do to help solve the problem. The important thing is to get started now.

Todd County Public Works
Schedule of Prices

Contract No.: 202502

Project Number: CP 25:86

Project Title or Road Number: CR 86

Work Type: GRAVEL SURFACING

BIDDER MUST FILL IN UNIT PRICES IN NUMERALS; MAKE EXTENSION FOR EACH ITEM AND TOTAL. FOR COMPLETE INFORMATION CONCERNING THESE ITEMS, SEE PLANS AND SPECIFICATIONS, INCLUDING SPECIAL PROVISIONS.

Line Number	Item No.	Description	Units	Quantity	Unit Price	Total Price
1	2118.509	AGGREGATE SURFACING CLASS 1 MOD.	TON	11,100		
TOTAL:						

Bidder Name: _____

Bidder Address: _____

Bidder Phone: _____

Bidder Signature: _____

Date: _____

the 1990s, the number of people in the world who are under 15 years of age is expected to increase from 1.1 billion to 1.5 billion.

As the world's population grows, the demand for food and other resources will increase. This will put pressure on the environment and on the world's food supply.

One way to meet this demand is to increase the amount of land that is used for agriculture. This can be done by clearing more land for farming or by increasing the productivity of existing farmland.

Another way to meet this demand is to increase the amount of food that is produced on the same amount of land. This can be done by using more fertilizers and pesticides or by using more advanced farming techniques.

However, increasing the amount of land used for agriculture or increasing the productivity of existing farmland can have negative effects on the environment. For example, clearing more land for farming can lead to deforestation and the loss of biodiversity.

Increasing the productivity of existing farmland can lead to the use of more fertilizers and pesticides, which can pollute the environment. It can also lead to the depletion of soil nutrients.

Therefore, it is important to find ways to increase the world's food supply without harming the environment. One way to do this is to use more sustainable farming practices.

Sustainable farming practices are those that are designed to meet the needs of the present without compromising the ability of future generations to meet their own needs. This can be done by using less fertilizers and pesticides, by conserving water, and by using more sustainable farming techniques.

Another way to increase the world's food supply is to reduce the amount of food that is wasted. This can be done by encouraging people to eat less meat, by reducing food waste at home, and by donating excess food to food banks.

By using more sustainable farming practices and by reducing food waste, we can increase the world's food supply without harming the environment. This will help to ensure that everyone has access to enough food to live a healthy and productive life.

There are many other ways to increase the world's food supply, but these are some of the most important. By working together, we can ensure that everyone has access to enough food to live a healthy and productive life.

The world's population is growing, and the demand for food is increasing. This is a challenge that we must all face. By using more sustainable farming practices and by reducing food waste, we can meet this challenge and ensure that everyone has access to enough food to live a healthy and productive life.

It is our responsibility to ensure that everyone has access to enough food to live a healthy and productive life. By working together, we can meet this responsibility and ensure a better future for all.

The world's population is growing, and the demand for food is increasing. This is a challenge that we must all face. By using more sustainable farming practices and by reducing food waste, we can meet this challenge and ensure that everyone has access to enough food to live a healthy and productive life.

It is our responsibility to ensure that everyone has access to enough food to live a healthy and productive life. By working together, we can meet this responsibility and ensure a better future for all.

The world's population is growing, and the demand for food is increasing. This is a challenge that we must all face. By using more sustainable farming practices and by reducing food waste, we can meet this challenge and ensure that everyone has access to enough food to live a healthy and productive life.

It is our responsibility to ensure that everyone has access to enough food to live a healthy and productive life. By working together, we can meet this responsibility and ensure a better future for all.

The world's population is growing, and the demand for food is increasing. This is a challenge that we must all face. By using more sustainable farming practices and by reducing food waste, we can meet this challenge and ensure that everyone has access to enough food to live a healthy and productive life.

It is our responsibility to ensure that everyone has access to enough food to live a healthy and productive life. By working together, we can meet this responsibility and ensure a better future for all.

The world's population is growing, and the demand for food is increasing. This is a challenge that we must all face. By using more sustainable farming practices and by reducing food waste, we can meet this challenge and ensure that everyone has access to enough food to live a healthy and productive life.

It is our responsibility to ensure that everyone has access to enough food to live a healthy and productive life. By working together, we can meet this responsibility and ensure a better future for all.

County Project No. 25:71 \$ _____County Project No. 25:85 \$ _____County Project No. 25:86 \$ _____

TOTAL BID AMOUNT \$ _____

PROPOSAL GUARANTY required by 1208 of the Specifications: "A (certified check) (bond), prepared as required by 1208 of the Specifications and payable to the Todd County Treasurer, in an amount equal to at least 5% of the total amount of the bid is submitted herewith as a proposal guaranty.

NON-COLLUSION AFFIDAVIT: A Non-Collusion Affidavit is found in this proposal which must be signed by each bidder.

RECEIPT OF ADDENDA as required by 1210 of the Specifications:

The undersigned hereby acknowledges receipt of and has considered:

Addendum No. ____ Dated _____ Addendum No. ____ Dated _____

Addendum No. ____ Dated _____ Addendum No. ____ Dated _____

Signed

EXECUTION OF PROPOSAL as required by 1206 of the Specifications:

This proposal dated the ____ day of _____, 20

Signed: _____, P.O. Address _____ as an individual.

Signed: _____, P.O. Address _____ as an individual.

doing business under the name and style of

Signed: _____, for _____ a partnership.

NAME

BUSINESS ADDRESS

Signed: _____, for _____ a corporation,

incorporated under the laws of the State of Minnesota

Name of President _____ Business Address _____

Name of Vice-President _____ Business Address _____

Name of Secretary _____ Business Address _____

Name of Treasurer _____ Business Address _____

(NOTE: Signatures shall comply with 1206 of the Specifications.)

